

BusConnects
Infrastructure Dublin

Core Bus Corridors Preferred Route Options

Kimmage to City Centre

Third Public Consultation – Community Forum

Tuesday 10th November 2020



Community Forum Panel

Independent Chair: Simon Nugent

- Hugh Creegan – Deputy CEO (NTA)
- John Fleming – Project Director (NTA)
- Aidan Gallagher – Senior Project Manager (NTA)
- Seamus Mac Gearailt – Design Coordinator

BusConnects Dublin is a programme of 9 elements

■ **BUS** ➡ **230km** of bus priority making journeys faster and more reliable

■ **CYCLE** ➡ **200km** of cycle routes



Transitioning to a new
low emissions bus fleet



State of the art
ticketing system

Cashless payment system



Simpler fare structure



New Park & Ride
sites in key locations



New bus livery

providing a common style across all operators



New bus stops and shelters
with better signage and information



Dublin area bus network redesign

creating a more efficient network with high frequency
spines, new orbital routes and increased bus services

Timeline for the Core Bus Corridor Process

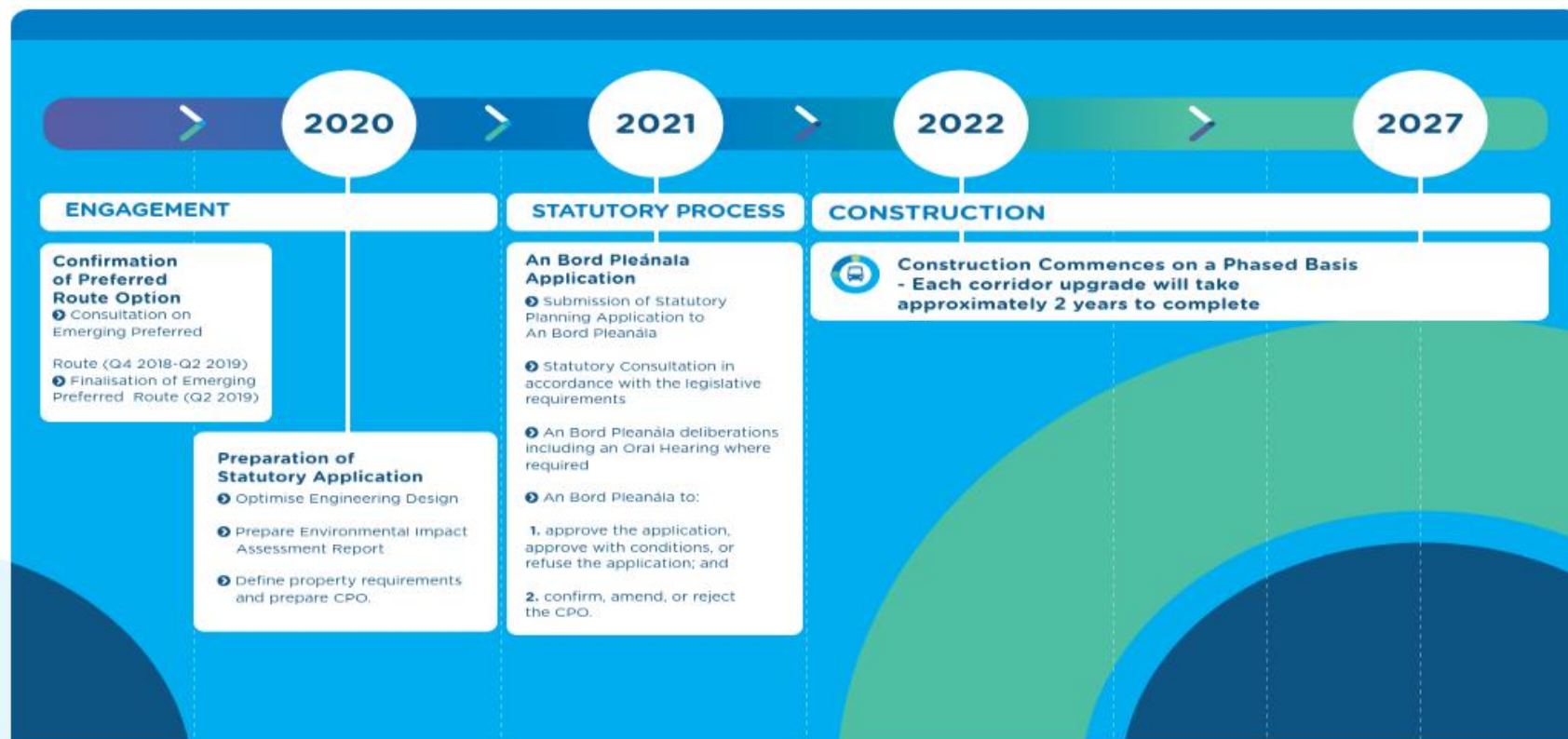

Kimimage to City Centre Corridor Changes for Public Consultation No.3

Kimimage > City Centre Index Map

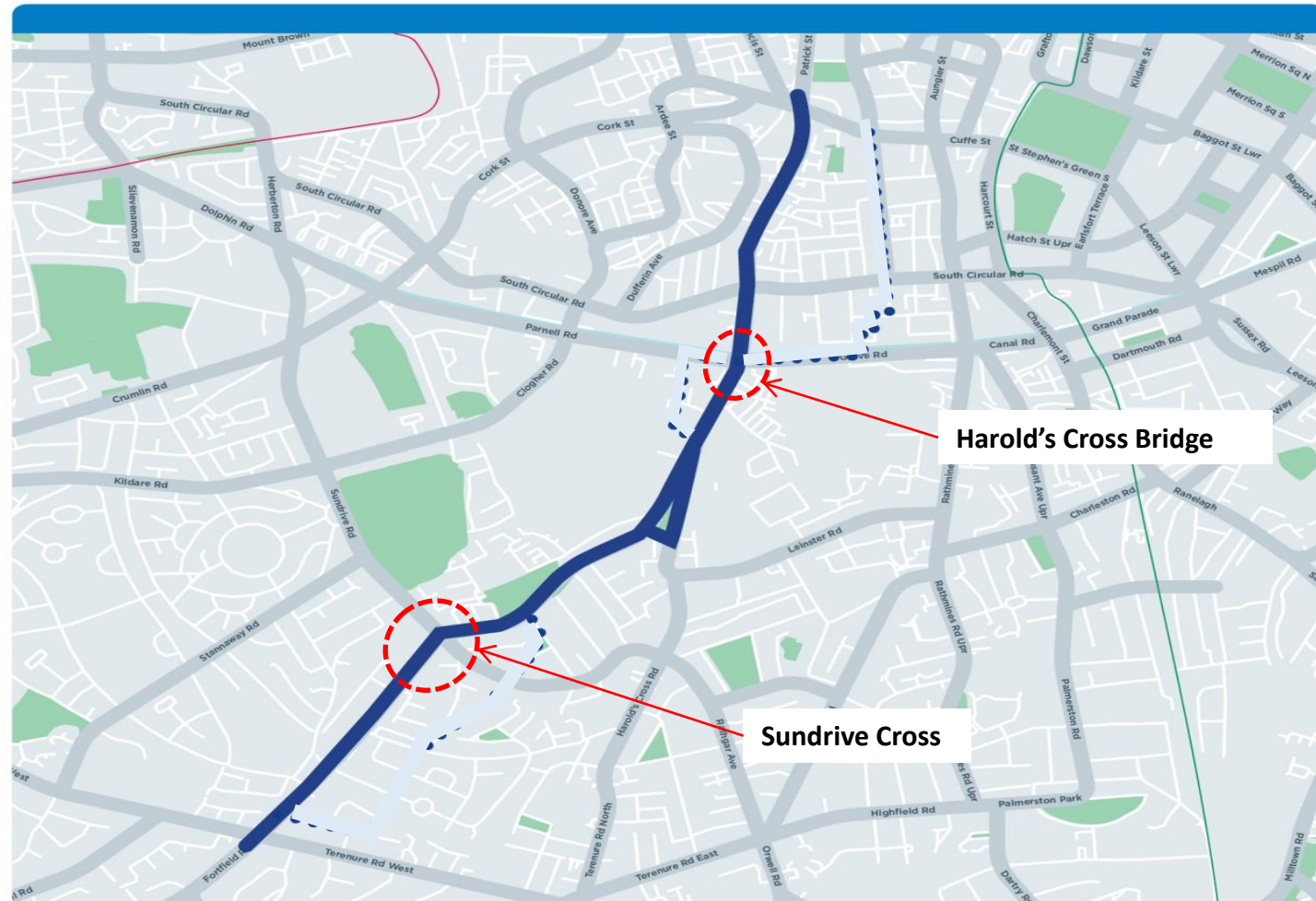

BusConnects Core Bus Corridors / 11: Kimmage > City Centre

MAP 1: Preferred Route

© Ordnance Survey Ireland Government of Ireland. All rights reserved.
Licence Number 2020/OSI_NMA_180 National Transport Authority.

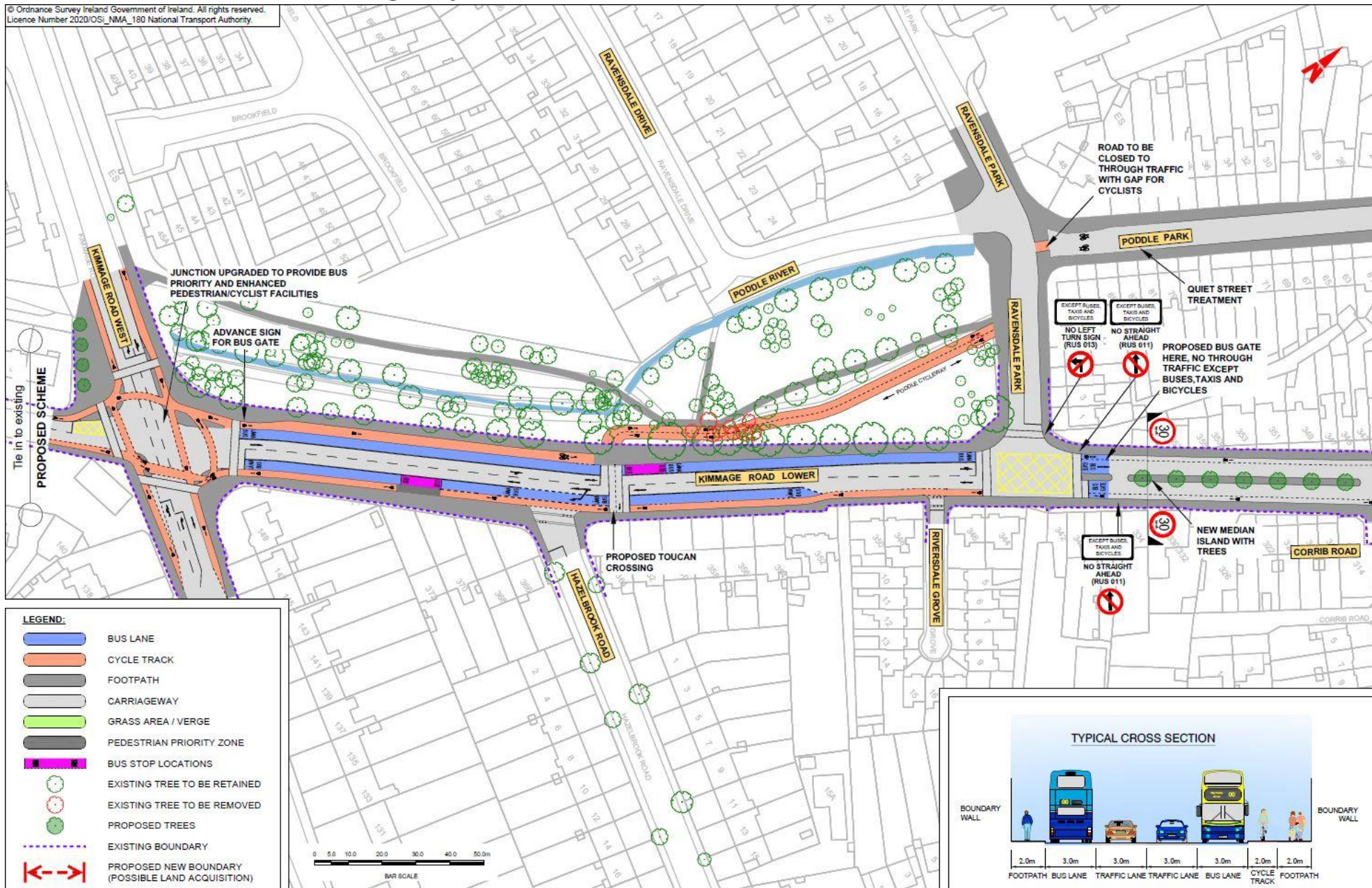

MAP 2: Preferred Route

BusConnects Core Bus Corridors / 11: Kimmage > City Centre

© Ordnance Survey Ireland Government of Ireland. All rights reserved.
Licence Number 2020/OSI_NMA_180 National Transport Authority.



© Ordnance Survey Ireland Government of Ireland. All rights reserved.
Licence Number 2020/OSI_NMA_180 National Transport Authority.

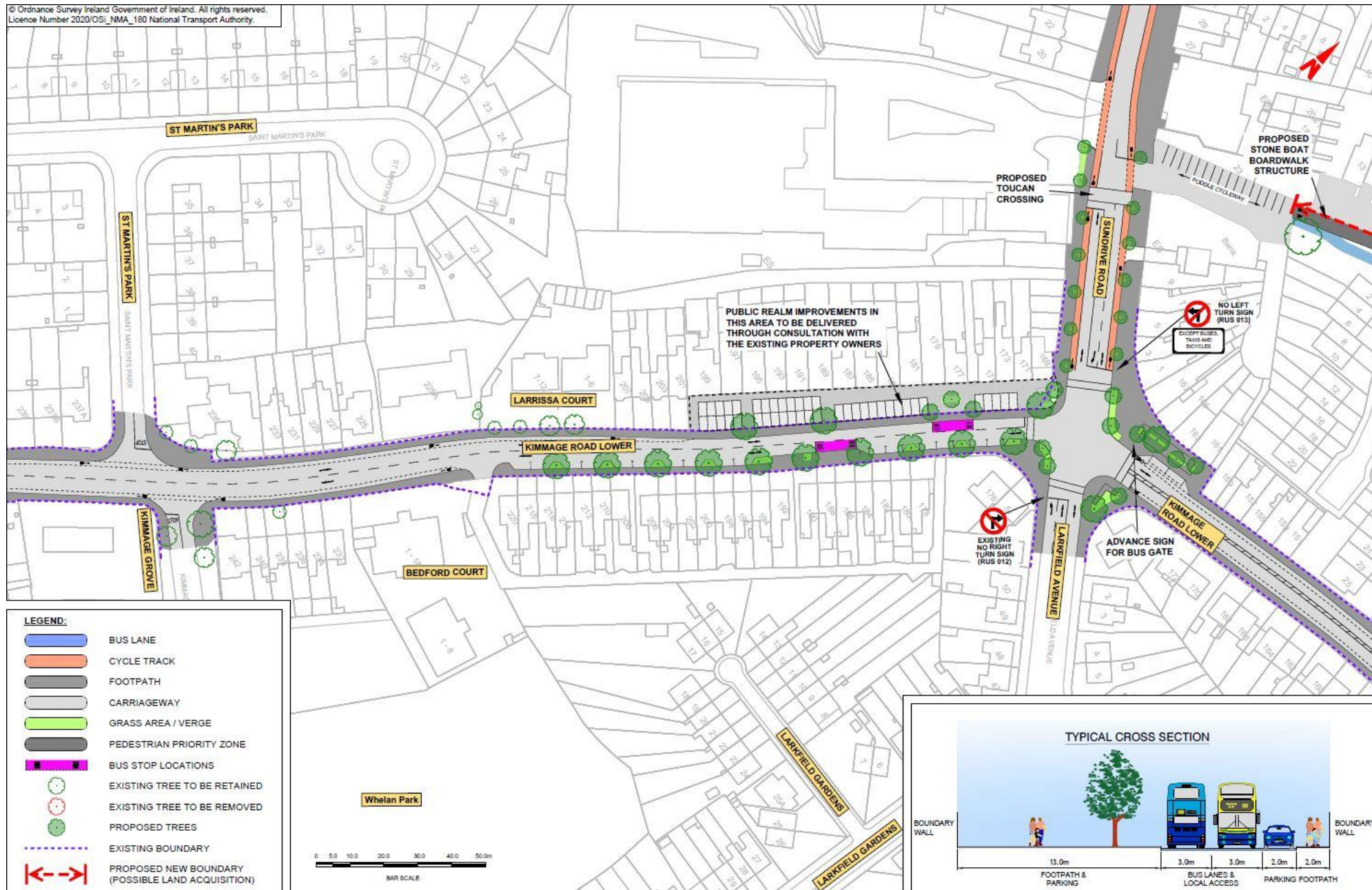

Sundrive Cross Public Realm Modified Proposals

Parking: Net increase of 6 spaces

East: +16 new permanent spaces

West: 42 of 52 private spaces retained

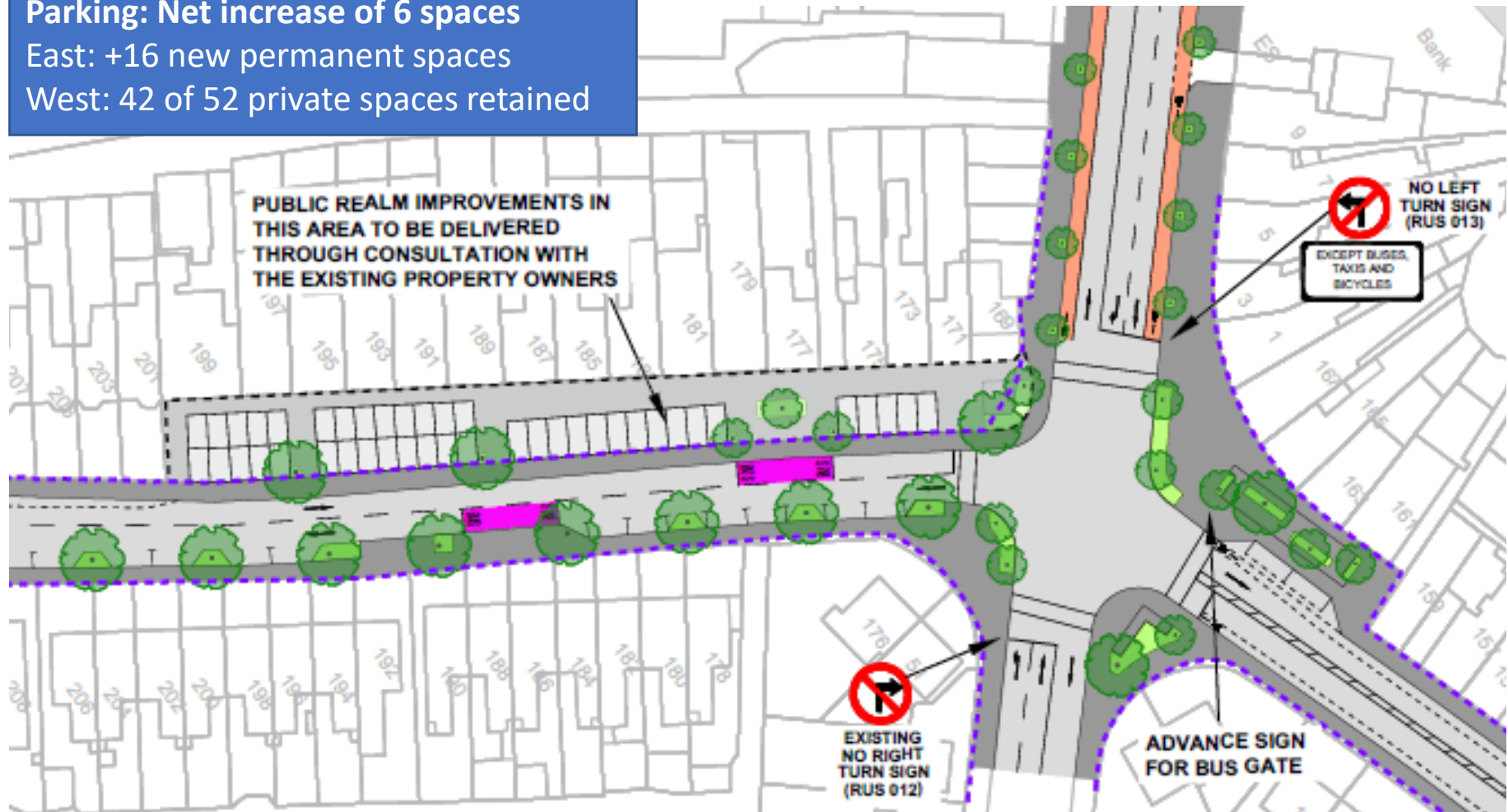

Public Realm at Sundrive Cross



© Ordnance Survey Ireland Government of Ireland. All rights reserved.
Licence Number 2020/OSI_NMA_180 National Transport Authority.



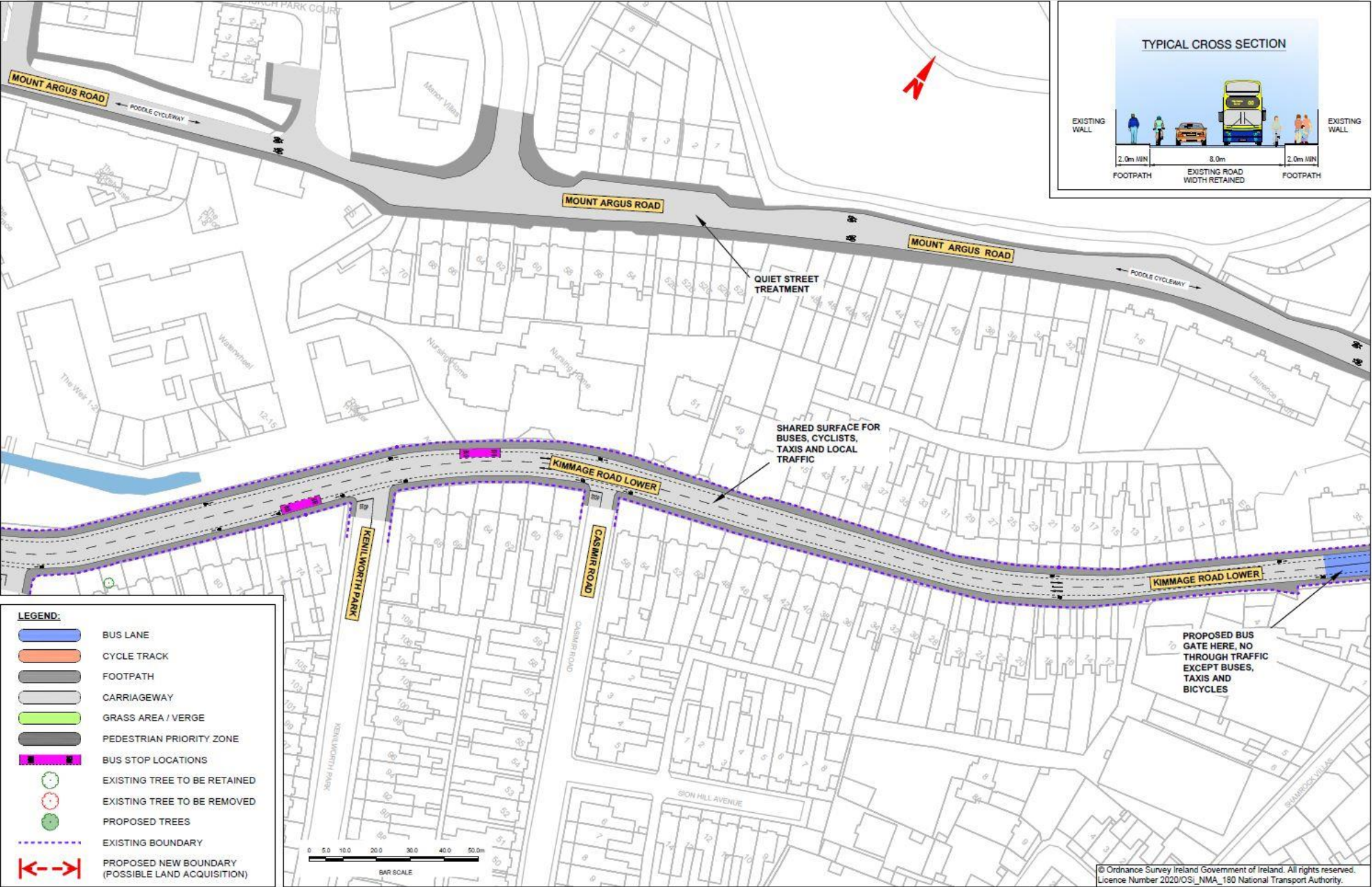

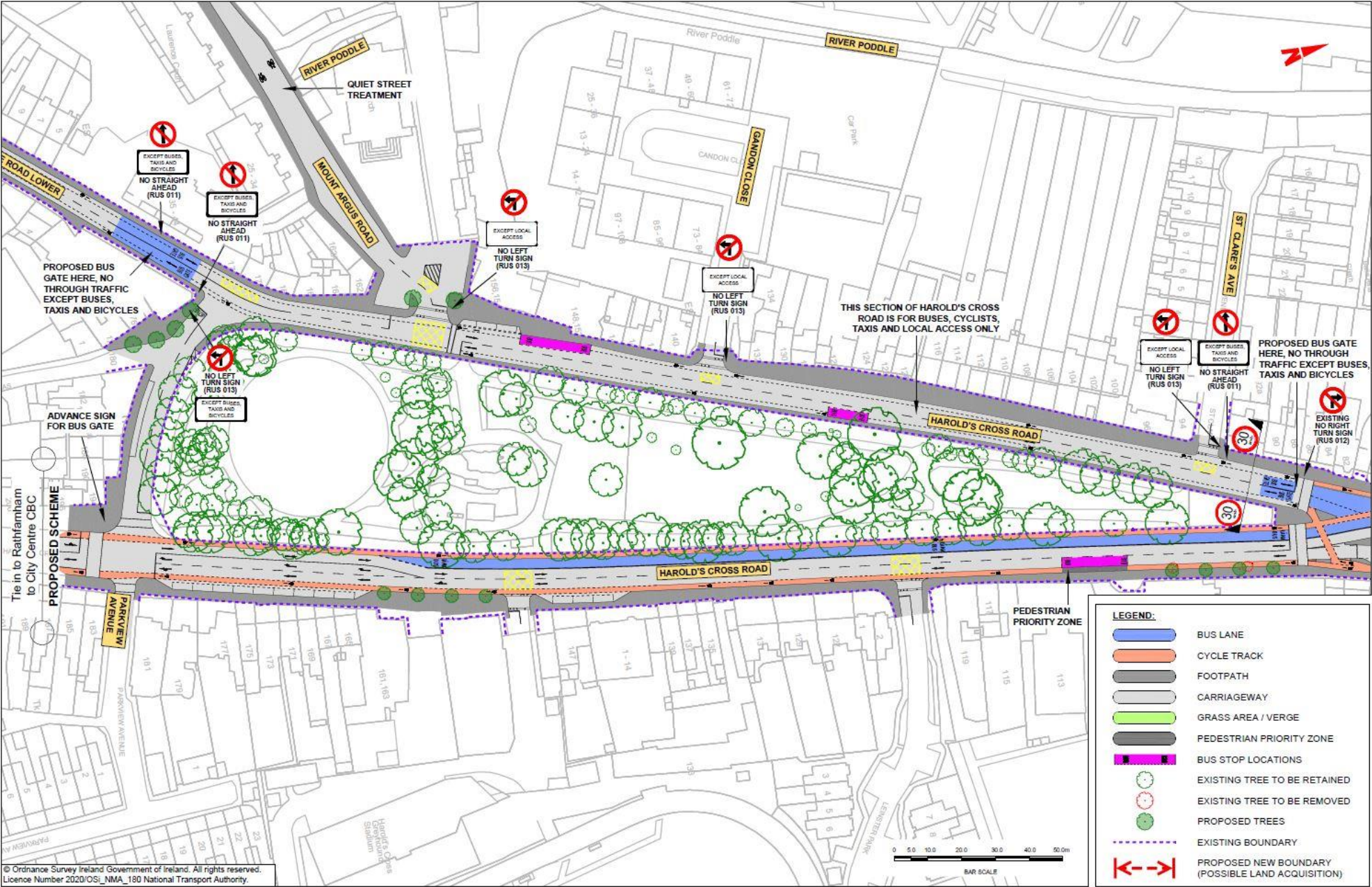

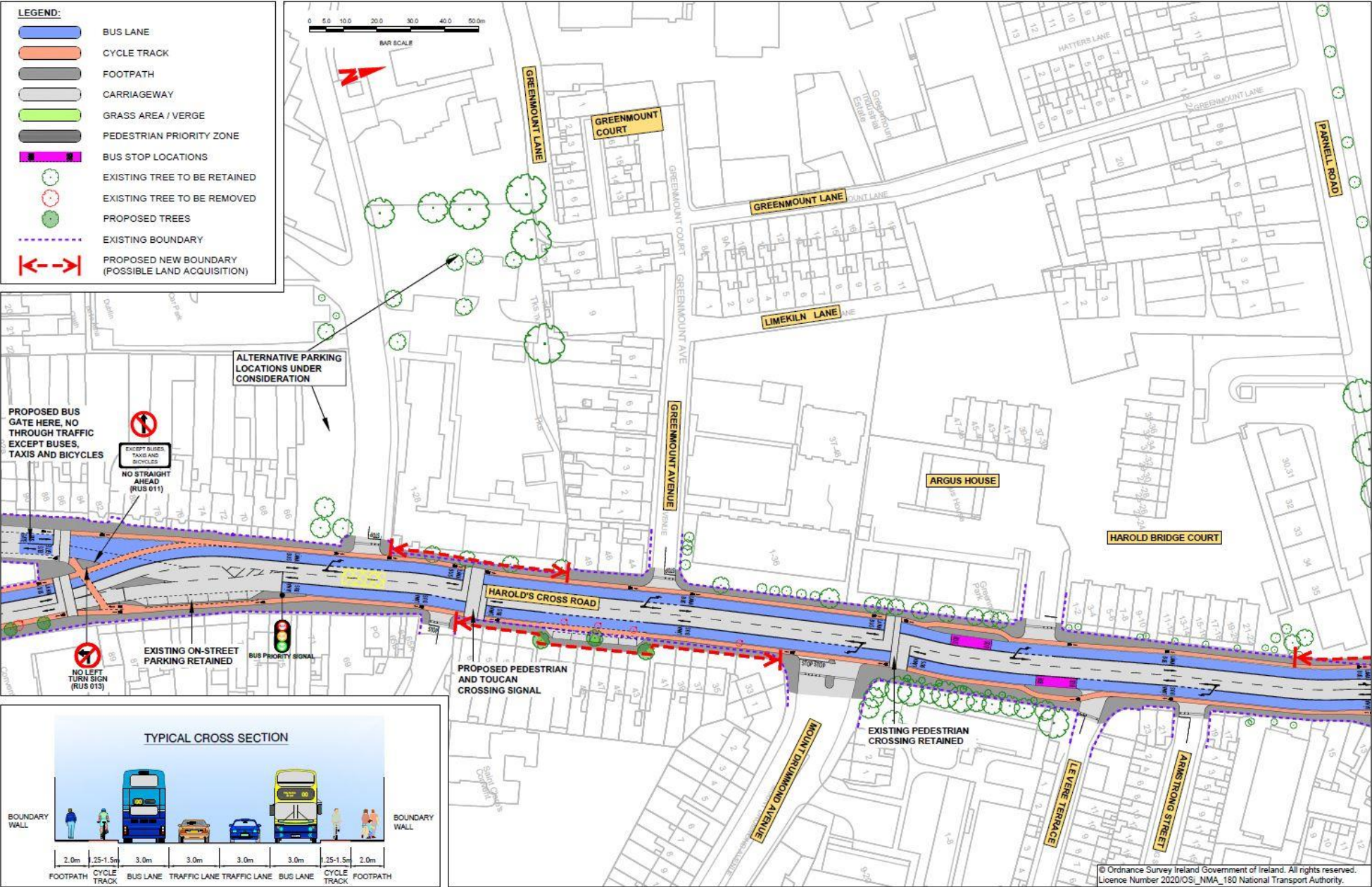



© Ordnance Survey Ireland Government of Ireland. All rights reserved.
Licence Number 2020/OSI_NMA_180 National Transport Authority.

TYPICAL CROSS SECTION

BOUNDARY WALL

2.0m 1.5-2.0m 3.0m 3.0m 3.0m 1.5-2.0m 2.0m

FOOTPATH CYCLE TRACK BUS LANE TRAFFIC LANE TRAFFIC LANE BUS LANE CYCLE TRACK FOOTPATH

LEGEND:

- BUS LANE
- CYCLE TRACK
- FOOTPATH
- CARRIAGEWAY
- GRASS AREA / VERGE
- PEDESTRIAN PRIORITY ZONE
- BUS STOP LOCATIONS
- EXISTING TREE TO BE RETAINED
- EXISTING TREE TO BE REMOVED
- PROPOSED TREES
- EXISTING BOUNDARY
- PROPOSED NEW BOUNDARY (POSSIBLE LAND ACQUISITION)

Harold's Cross Bridge Footbridges on both sides

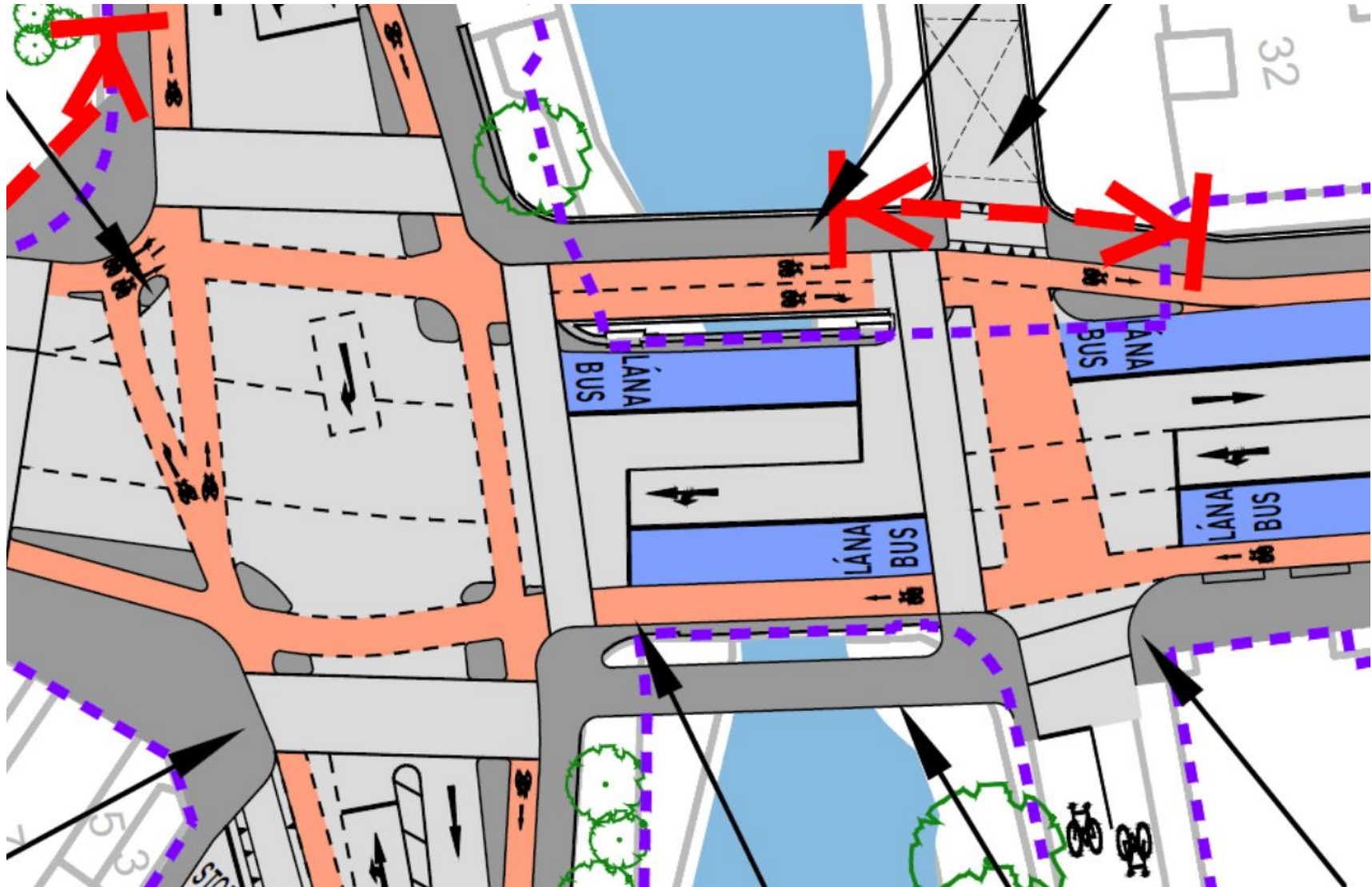

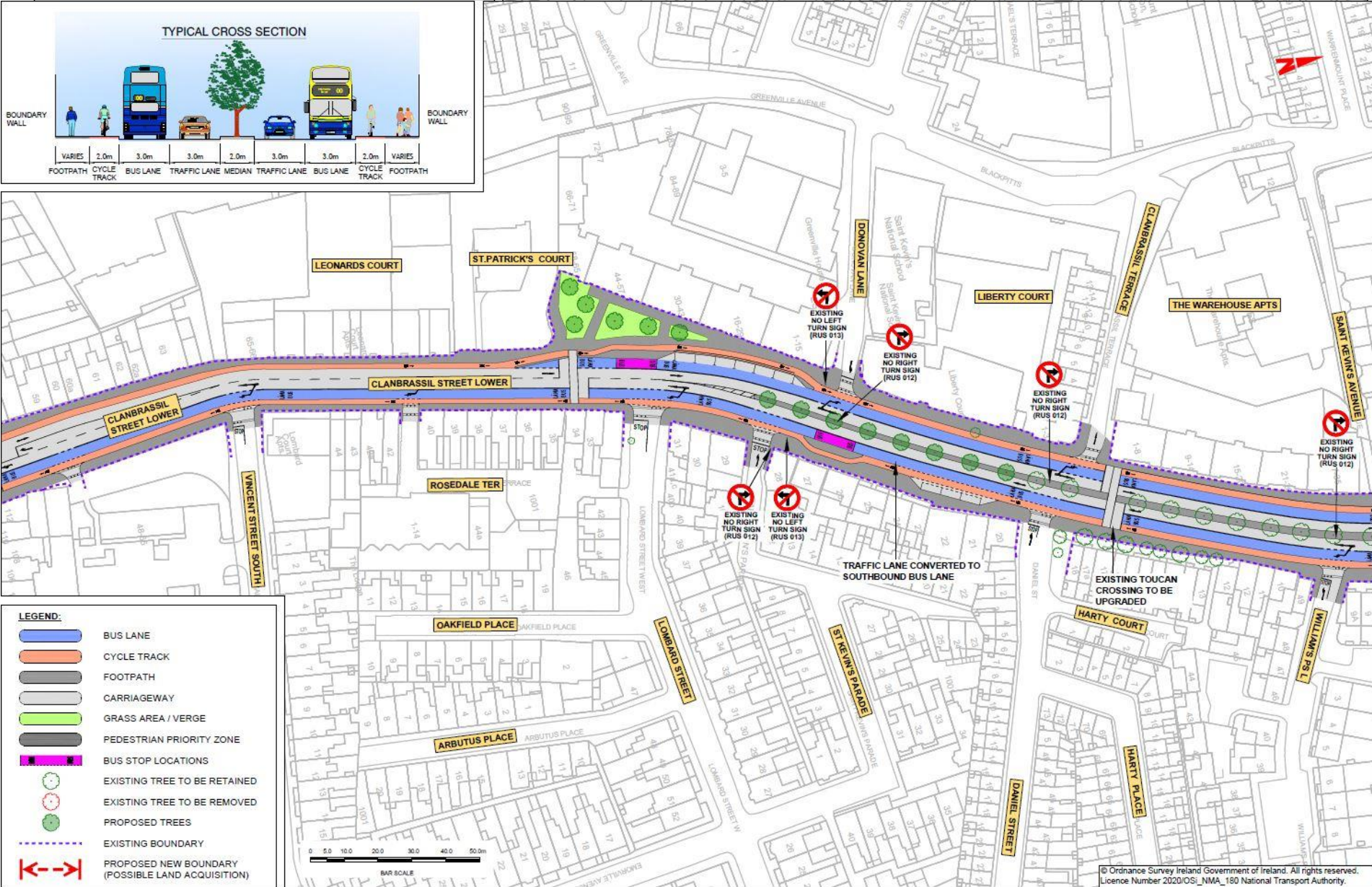



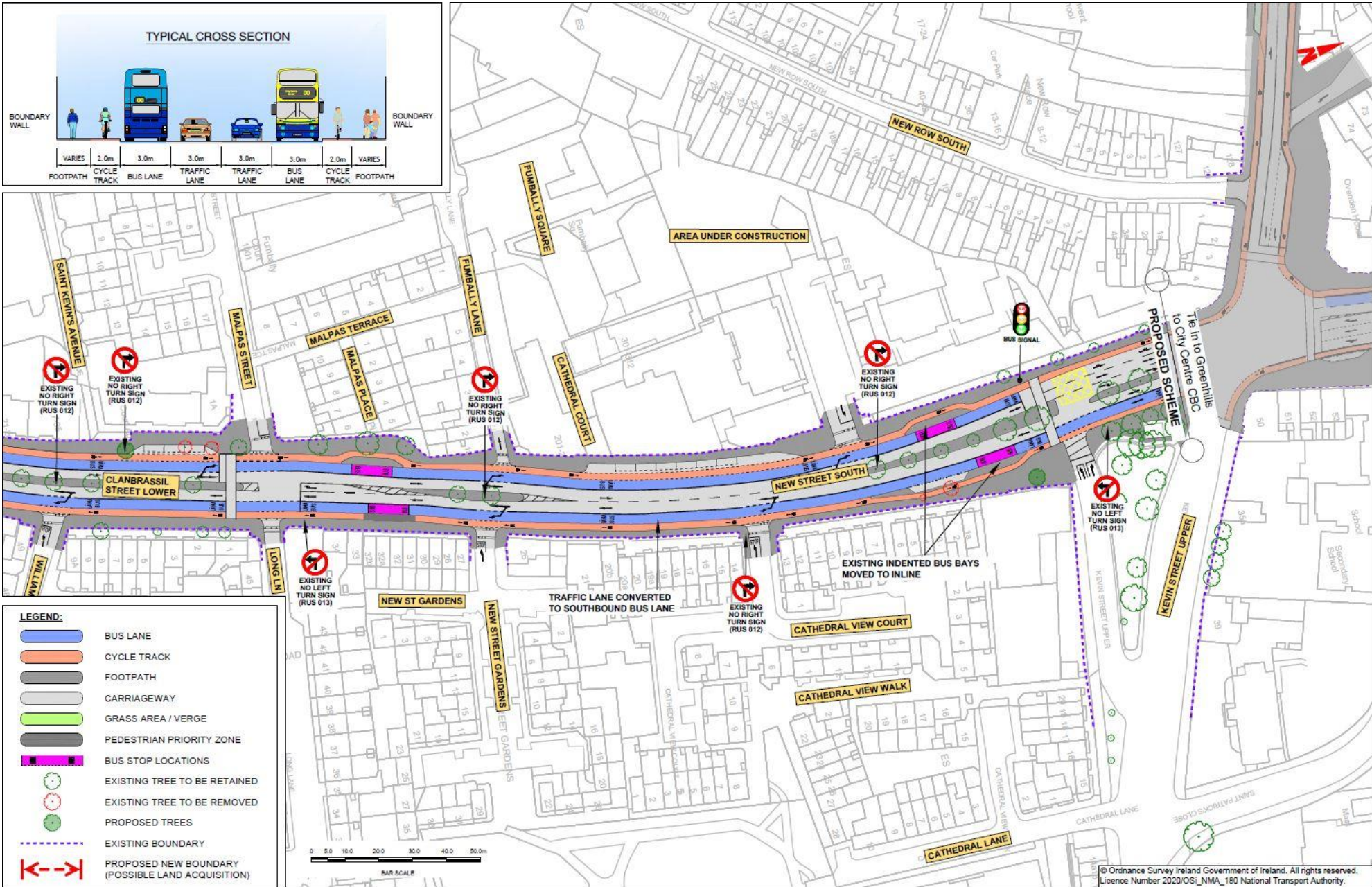

© Ordnance Survey Ireland Government of Ireland. All rights reserved.
Licence Number 2020/OSI_NMA_180 National Transport Authority.

Derravaragh Road / Corrib Road Area







© Ordnance Survey Ireland Government of Ireland. All rights reserved.
Licence Number 2020/OSI_NMA_180 National Transport Authority.

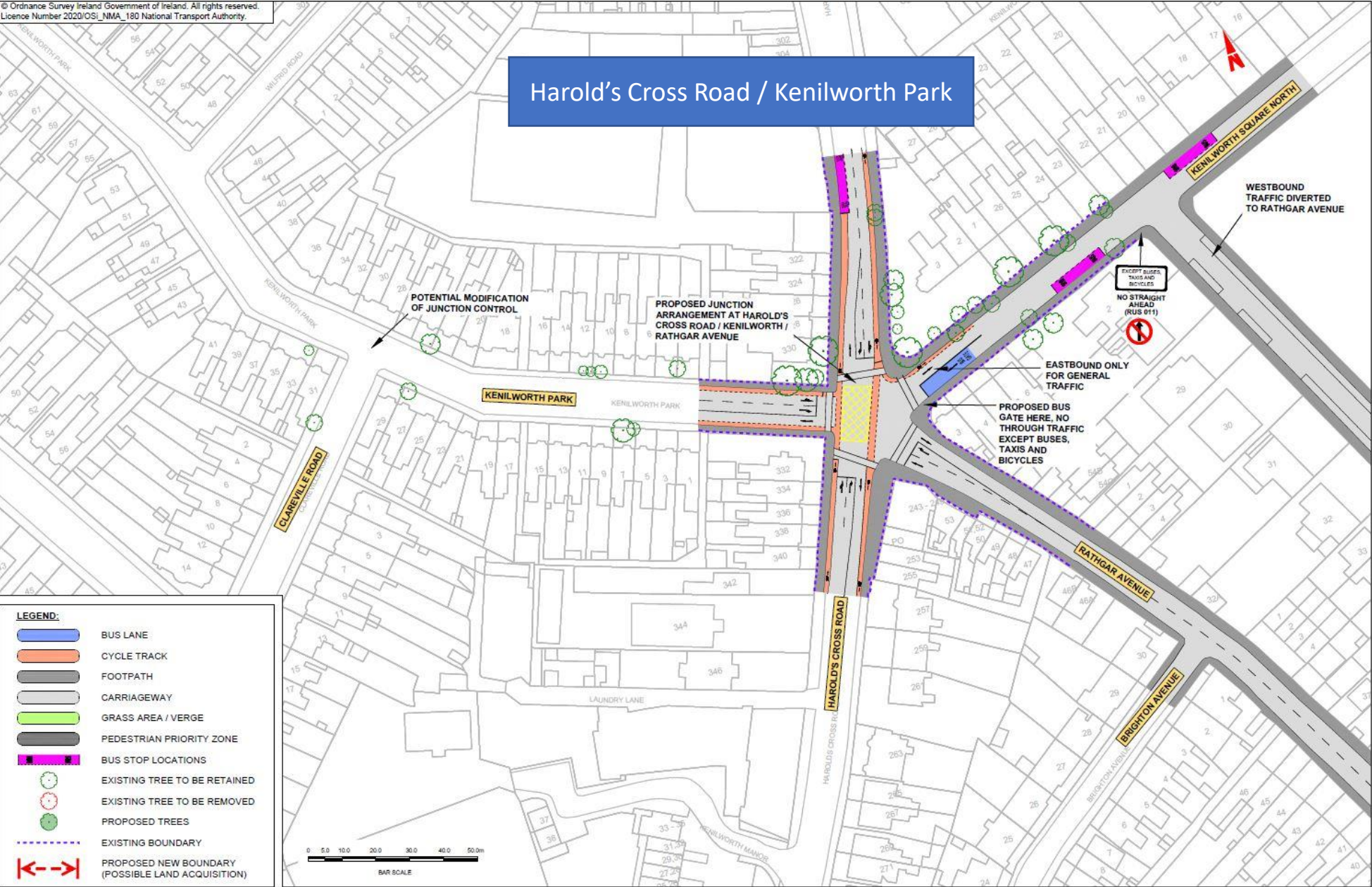

© Ordnance Survey Ireland Government of Ireland. All rights reserved.
Licence Number 2020/OSI_NMA_180 National Transport Authority.

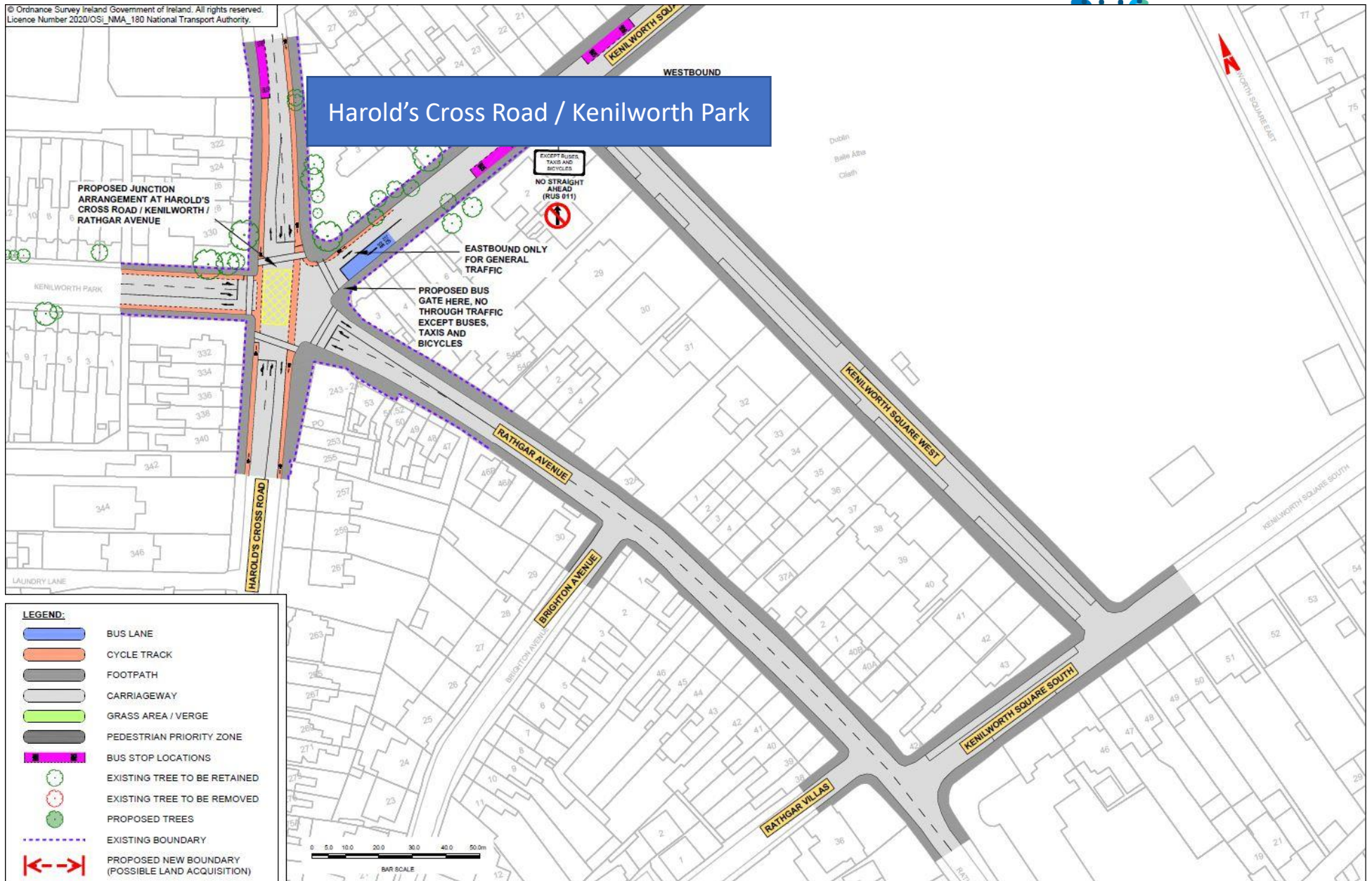

How to Engage?

How to Engage?

- Consultation on the proposals runs until **16 December**.
- Virtual consultation rooms for each Core Bus Corridor can be found on www.busconnects.ie.
- Submissions and observations may be made by:
 - **Email** - cbc@busconnects.ie
 - **Post** - Core Bus Corridor Project, National Transport Authority, Dún Scéine, Harcourt Lane, Dublin 2, D02 WT20.

Kimmage to City Centre Core Bus Corridor

QUESTIONS & ANSWERS

How to Engage?

- Consultation on the proposals runs until **16 December**.
- Virtual consultation rooms for each Core Bus Corridor can be found on www.busconnects.ie.
- Call back facility available from **16 to 27 November**.
- Submissions and observations may be made by:
 - **Email** - cbc@busconnects.ie
 - **Post** - Core Bus Corridor Project, National Transport Authority, Dún Scéine, Harcourt Lane, Dublin 2, D02 WT20.