

BusConnects Infrastructure Dublin

UCD Ballsbridge to City Centre Core Bus Corridor,
and
Blackrock to Merrion Core Bus Corridor

Community Forum Meeting
Third Public Consultation Overview
Monday 30 November 2020



Project Ireland 2040
Building Ireland's Future



Agenda

- Introduction to Community Forum Panel
- Presentation on the UCD Ballsbridge to City Centre Core Bus Corridor and the Blackrock to Merrion Core Bus Corridor
- Q & A

If you wish to ask a question to the NTA panel, please type your **Name** and your **Organisation** into the 'Chat' box.

When you are called upon sequentially by the Independent Chairperson to ask your question, the Webinar host will UNMUTE your microphone and you will receive a 'prompt' or 'notification' to your screen to unmute. You can then proceed to ask your question.

Please keep your question concise so that we can take questions from all the community groups/organisations on the webinar.

Community Forum Panel

Independent Chair: MARIE MCLAUGHLIN

- Hugh Creegan – Deputy CEO (NTA)
- John Fleming – Project Director (NTA)
- Aidan Gallagher – Senior Project Manager (NTA)
- Denis Crowley – Project Coordinator (Arup)
- Niall Harte – Route Project Manager (Arup)
- Brian Burke – Route Alignment Lead (Arup)
- Declan Haugh – Deputy Alignment Lead (Arup)

UCD Ballsbridge to City Centre Public Consultation 3 Changes

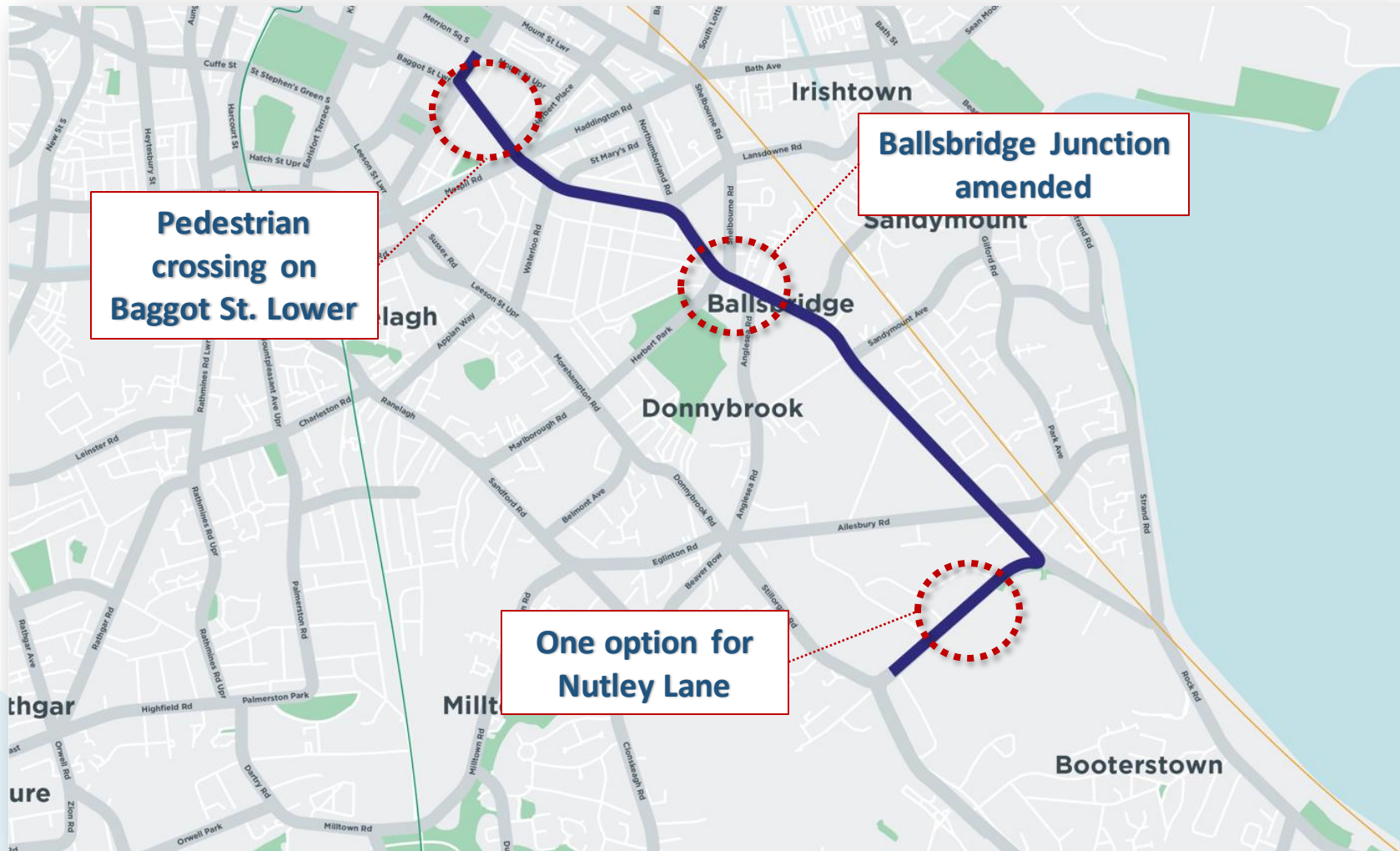

UCD Ballsbridge to City Centre



UCD Ballsbridge to City Centre



UCD Ballsbridge to City Centre

TYPICAL CROSS SECTION

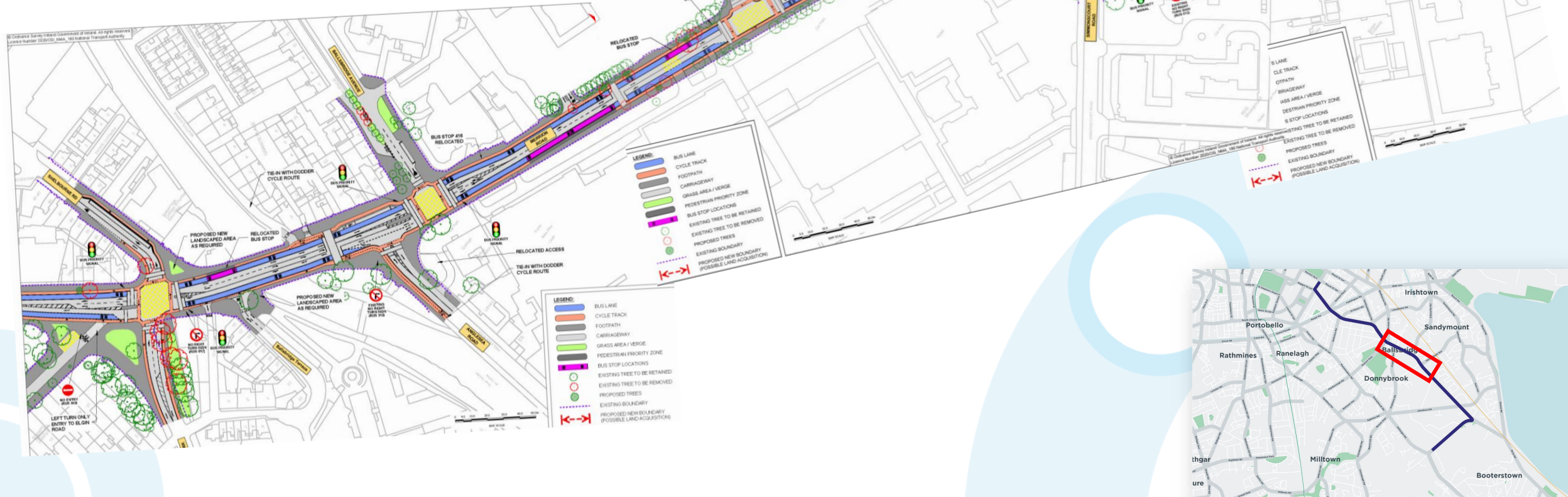
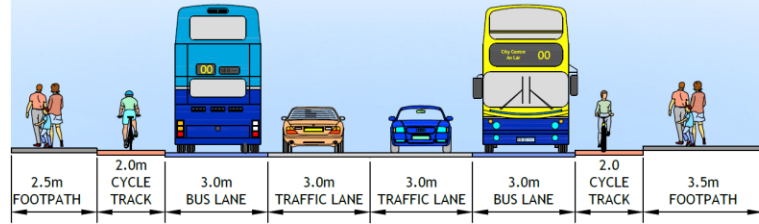

UCD Ballsbridge to City Centre

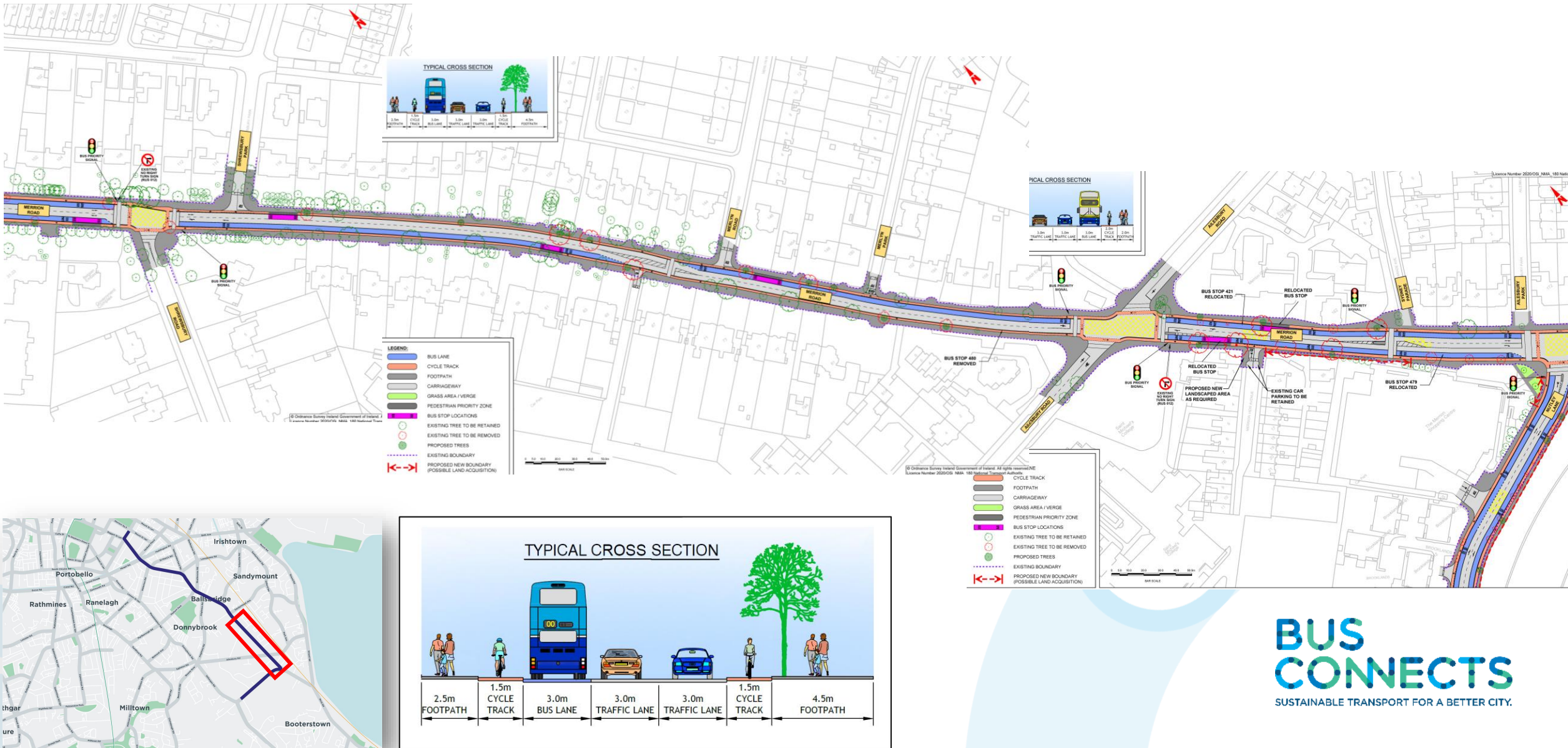

UCD Ballsbridge to City Centre

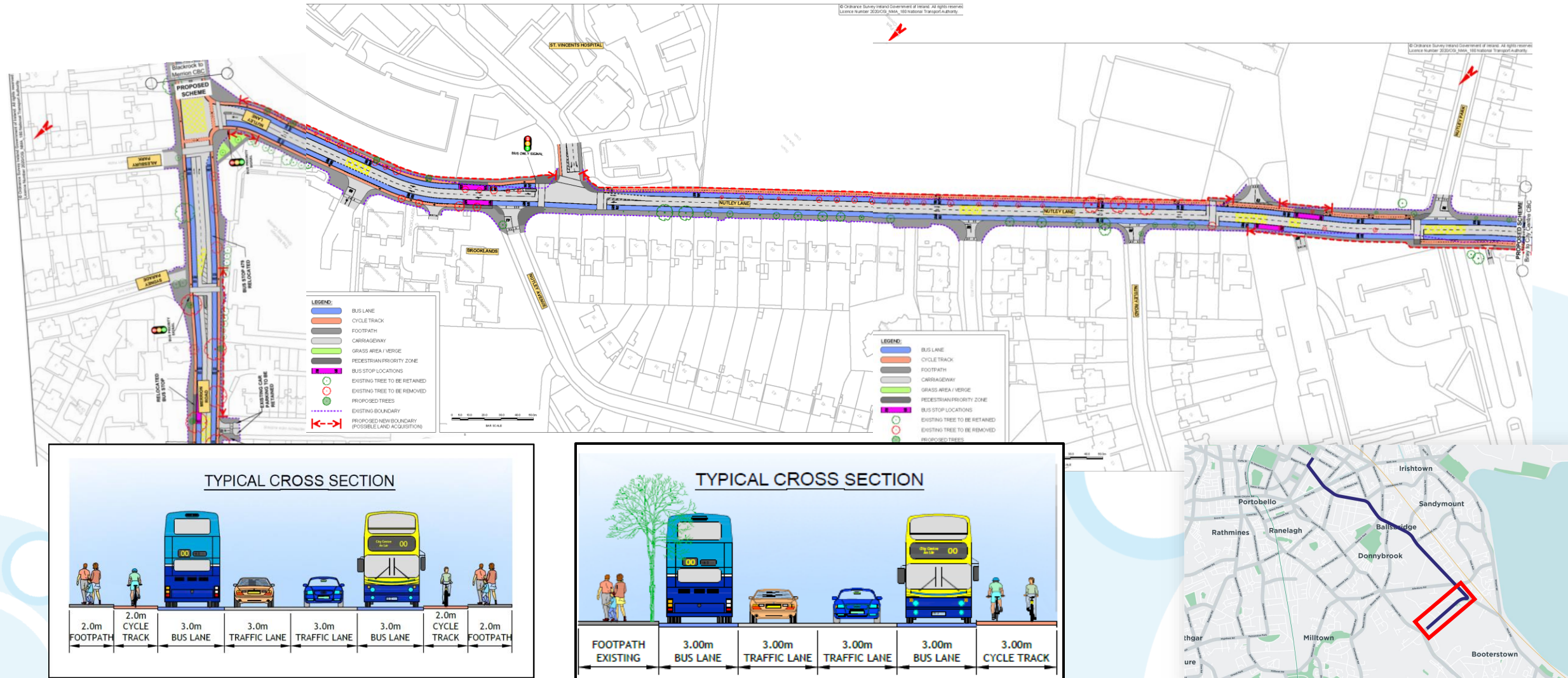

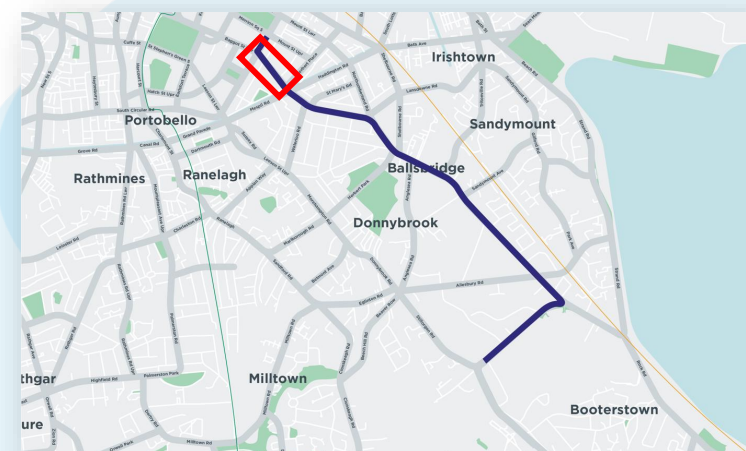
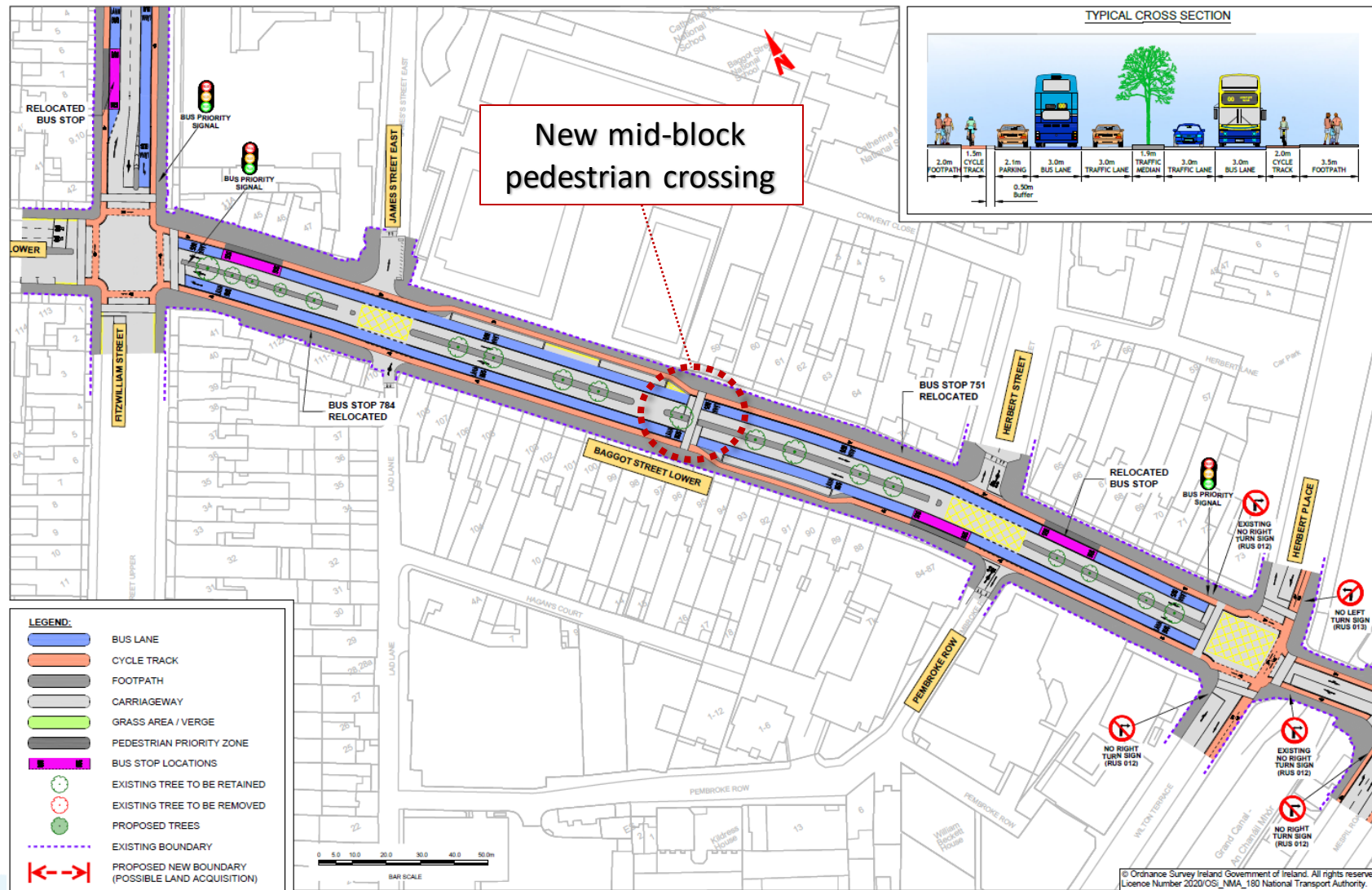

Baggot Street Lower



Ballsbridge Junction

2nd Non-Statutory Public Consultation – Draft PRO

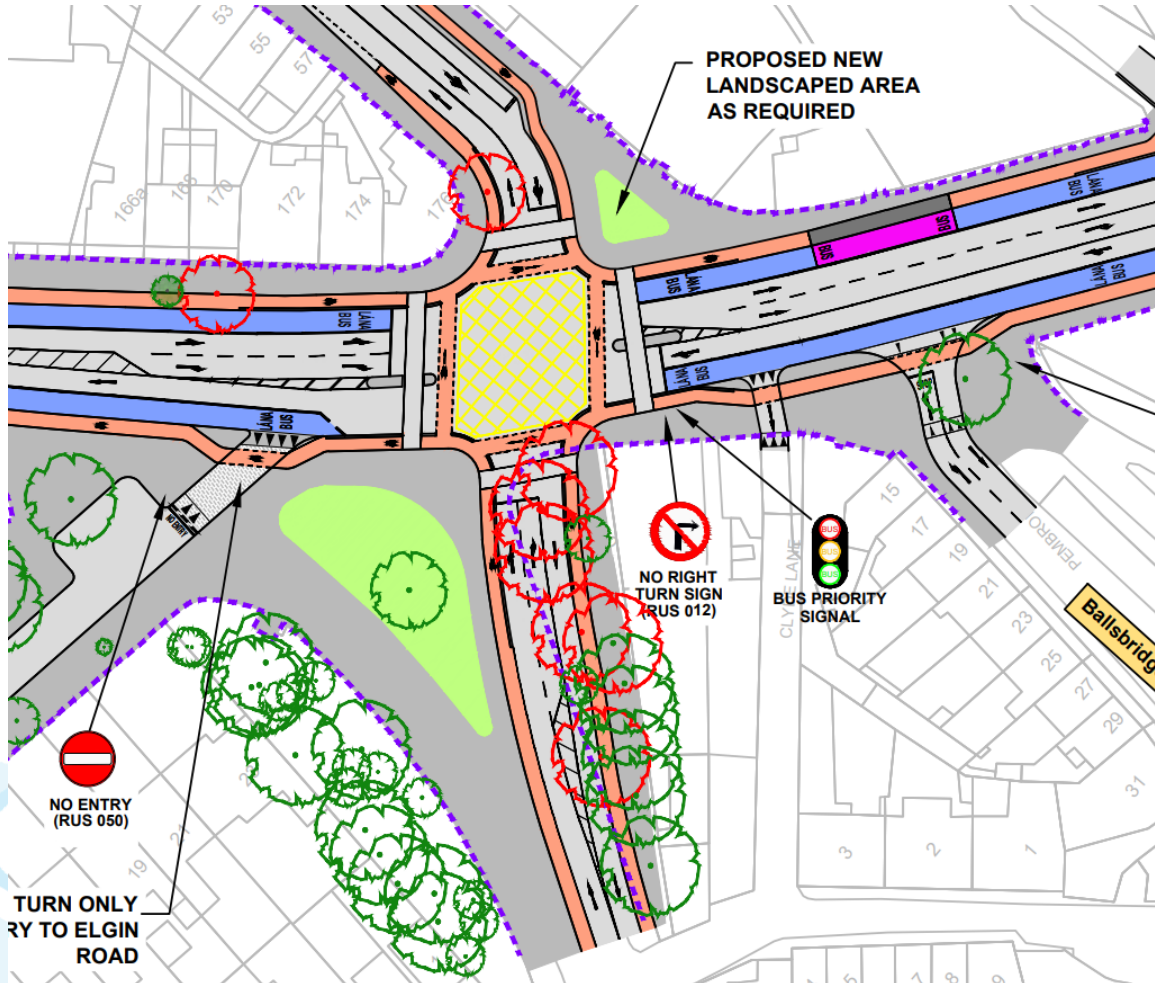

3rd Non-Statutory Public Consultation – Draft PRO

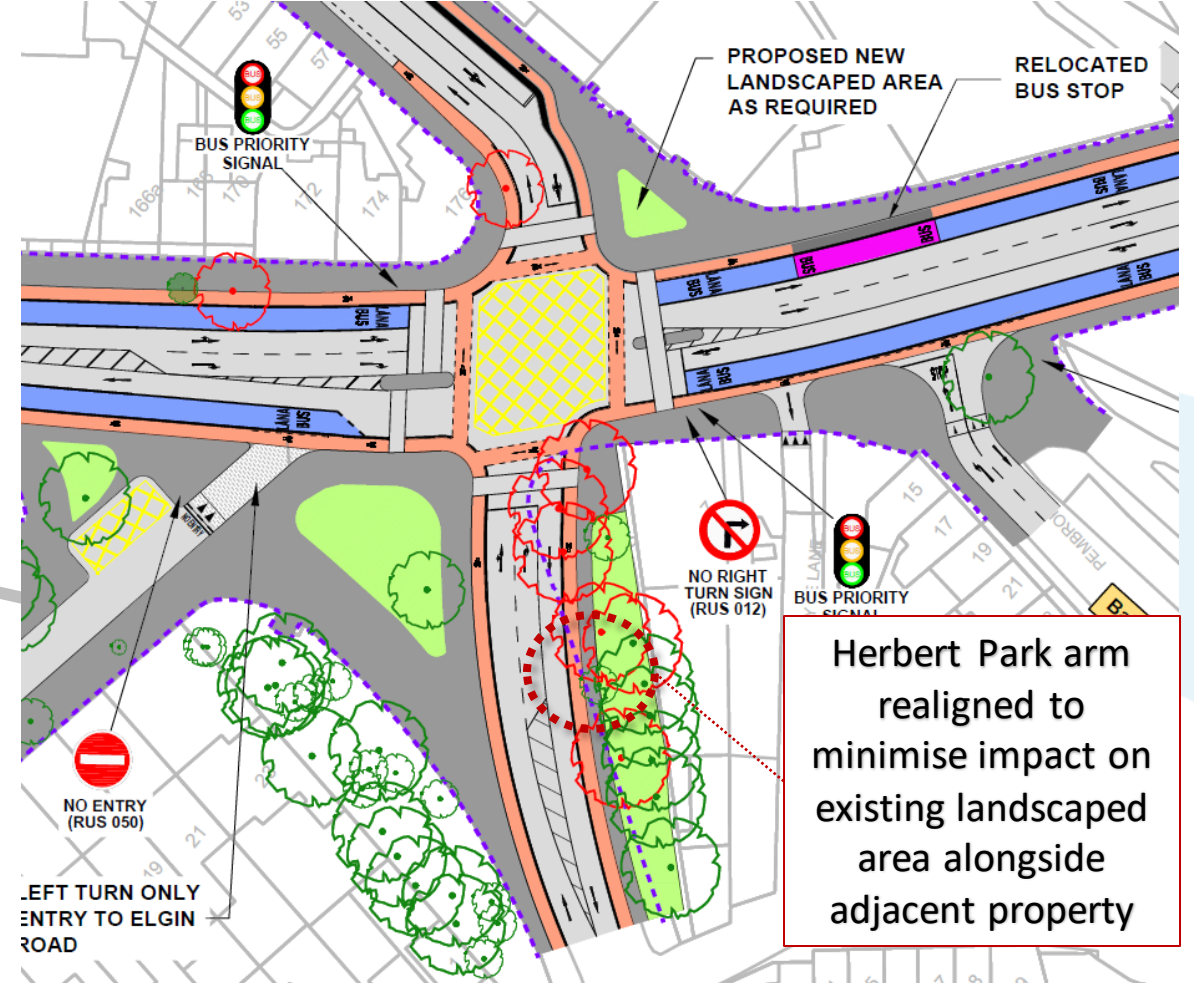

Ballsbridge Junction

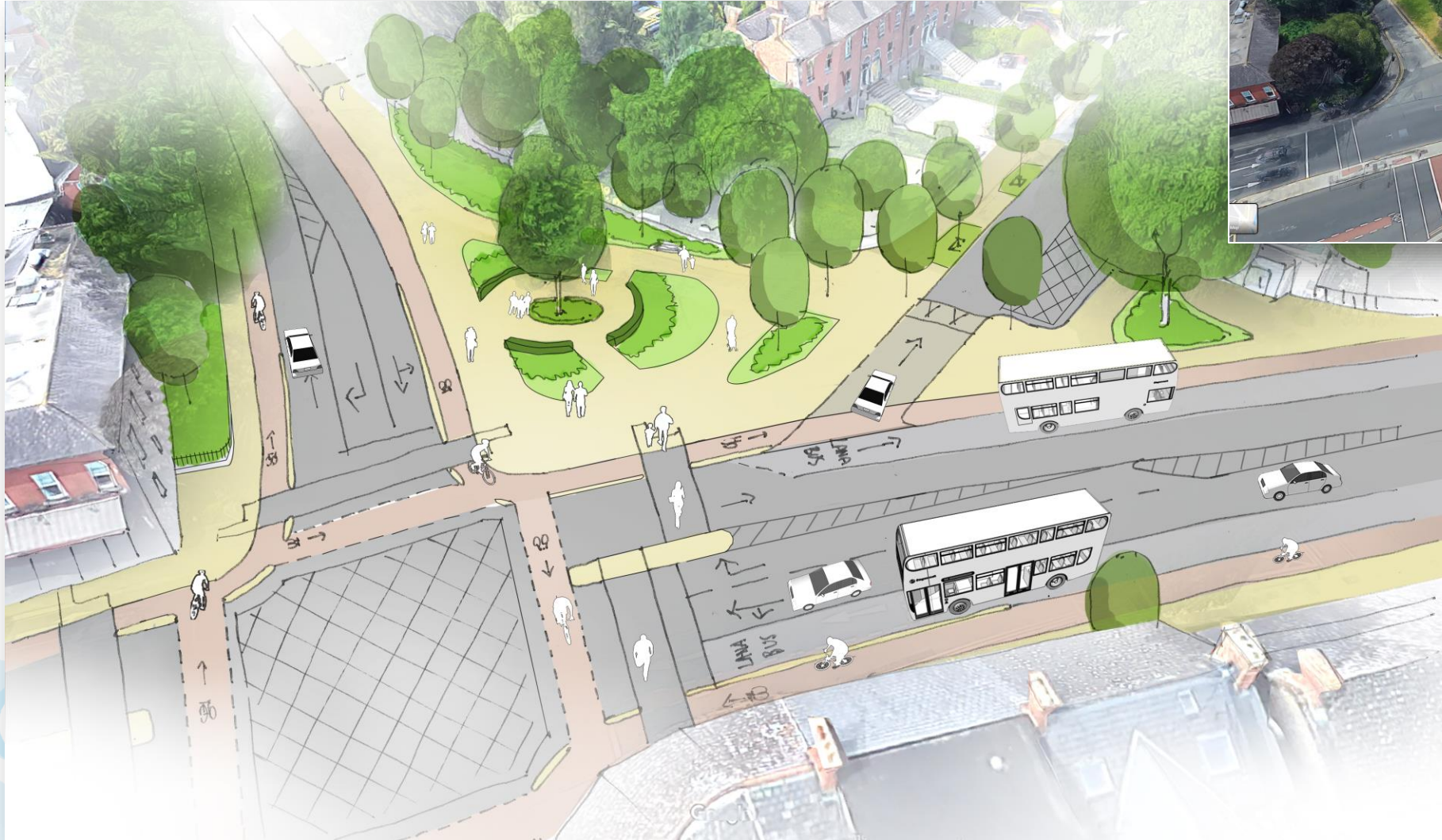

Nutley Lane – Two-way Option

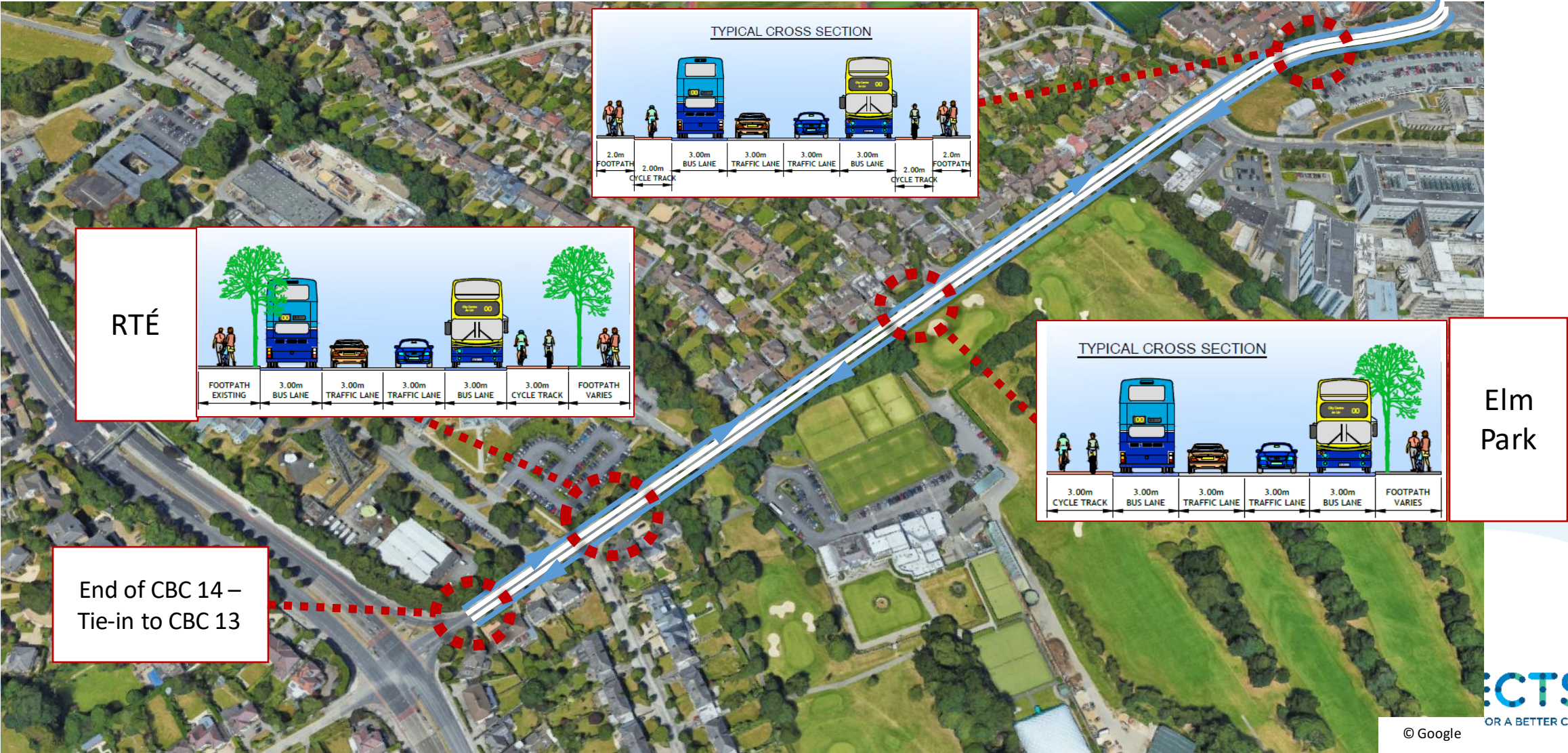



TYPICAL CROSS SECTION

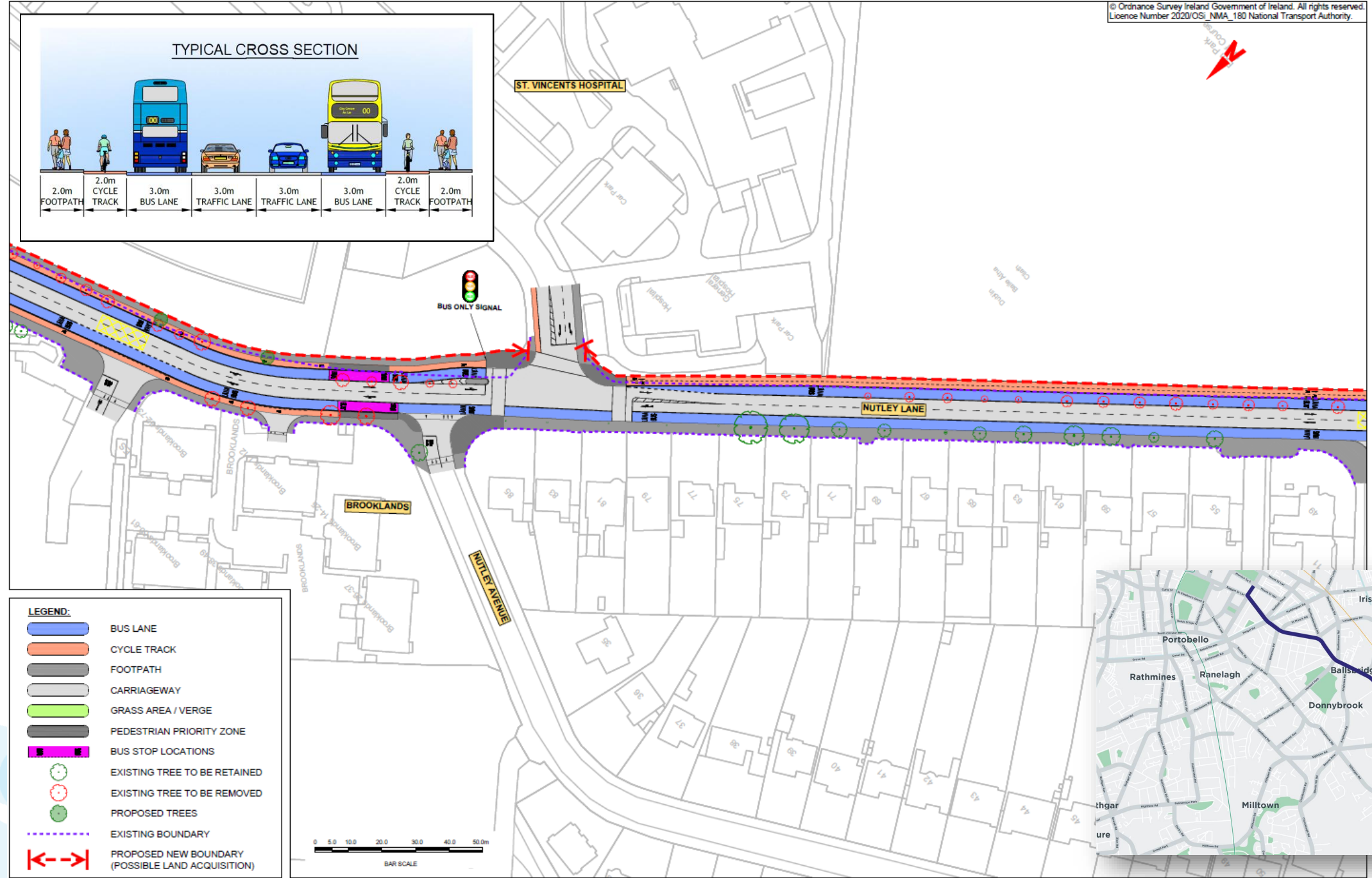
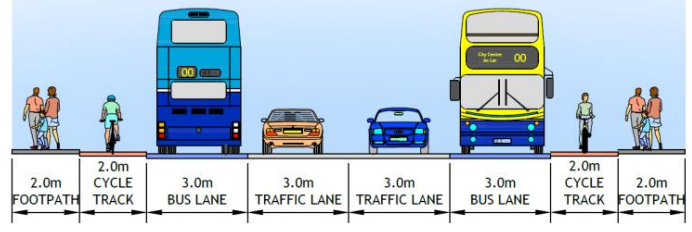

LEGEND:

- BUS LANE
- CYCLE TRACK
- FOOTPATH
- CARRIAGEWAY
- GRASS AREA / VERGE
- PEDESTRIAN PRIORITY ZONE
- BUS STOP LOCATIONS
- EXISTING TREE TO BE RETAINED
- EXISTING TREE TO BE REMOVED
- PROPOSED TREES
- EXISTING BOUNDARY
- PROPOSED NEW BOUNDARY (POSSIBLE LAND ACQUISITION)

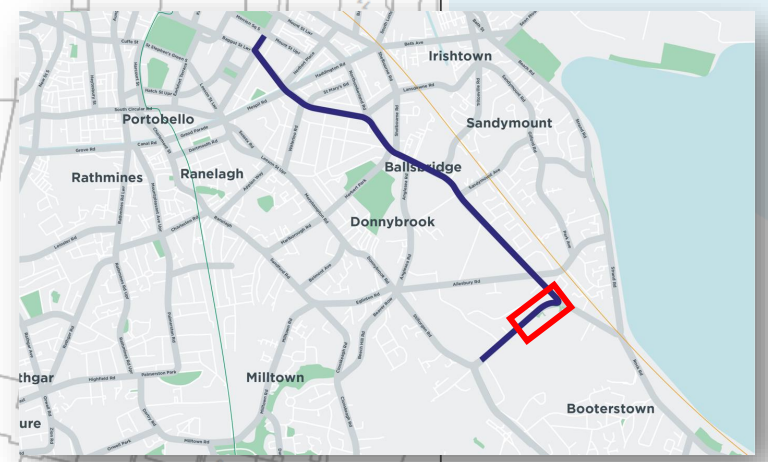

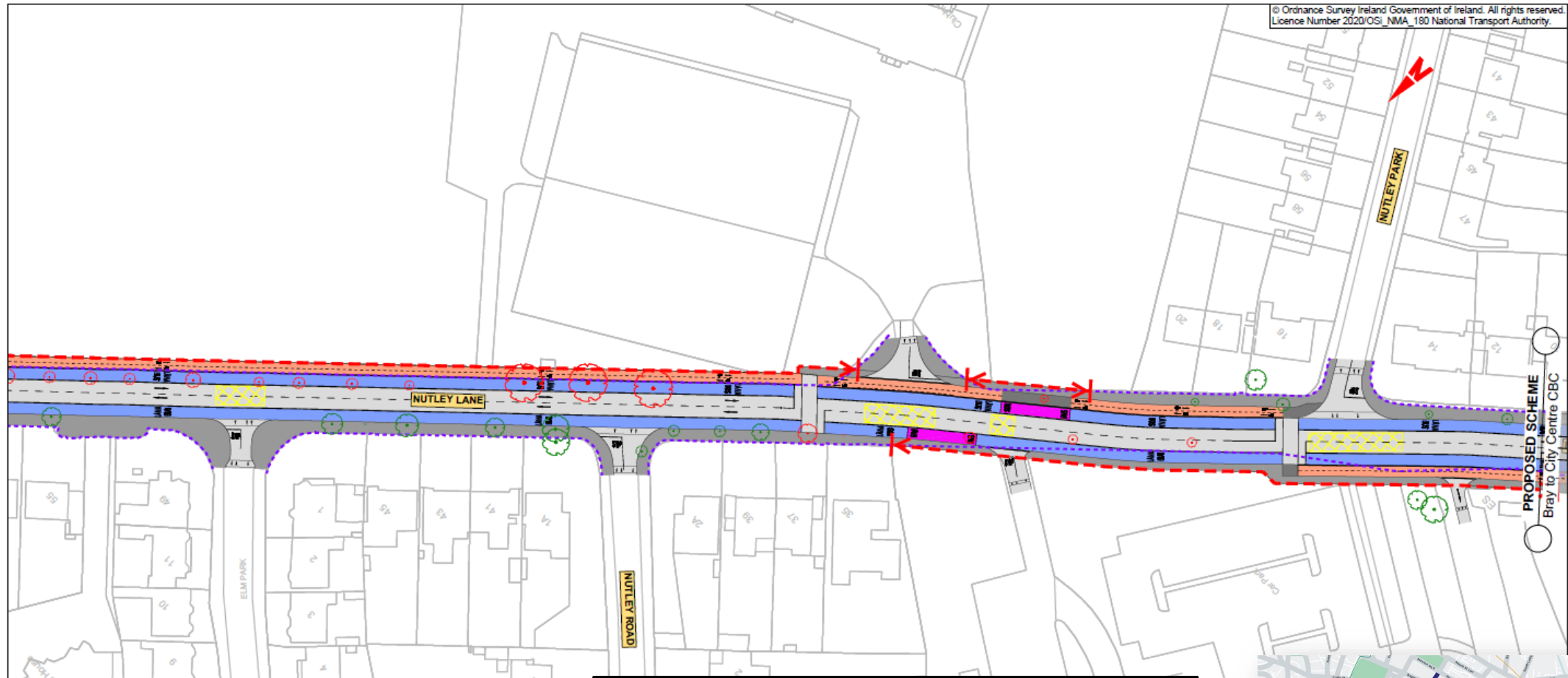

- LEGEND:**
- BUS LANE
 - CYCLE TRACK
 - FOOTPATH
 - CARRIAGEWAY
 - GRASS AREA / VERGE
 - PEDESTRIAN PRIORITY ZONE
 - BUS STOP LOCATIONS
 - EXISTING TREE TO BE RETAINED
 - EXISTING TREE TO BE REMOVED
 - PROPOSED TREES
 - EXISTING BOUNDARY
 - PROPOSED NEW BOUNDARY (POSSIBLE LAND ACQUISITION)

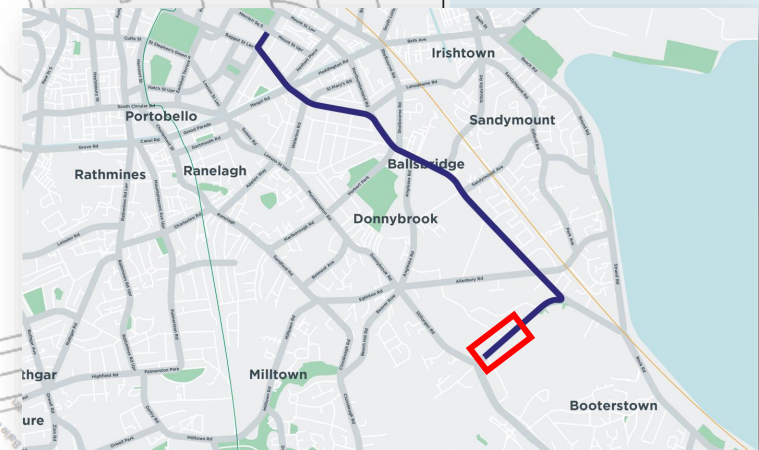
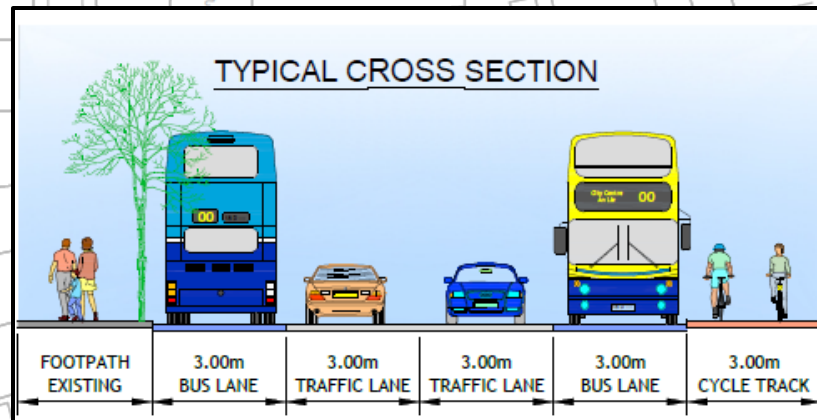

Nutley Lane – Draft Preferred Route Option



Blackrock to Merrion

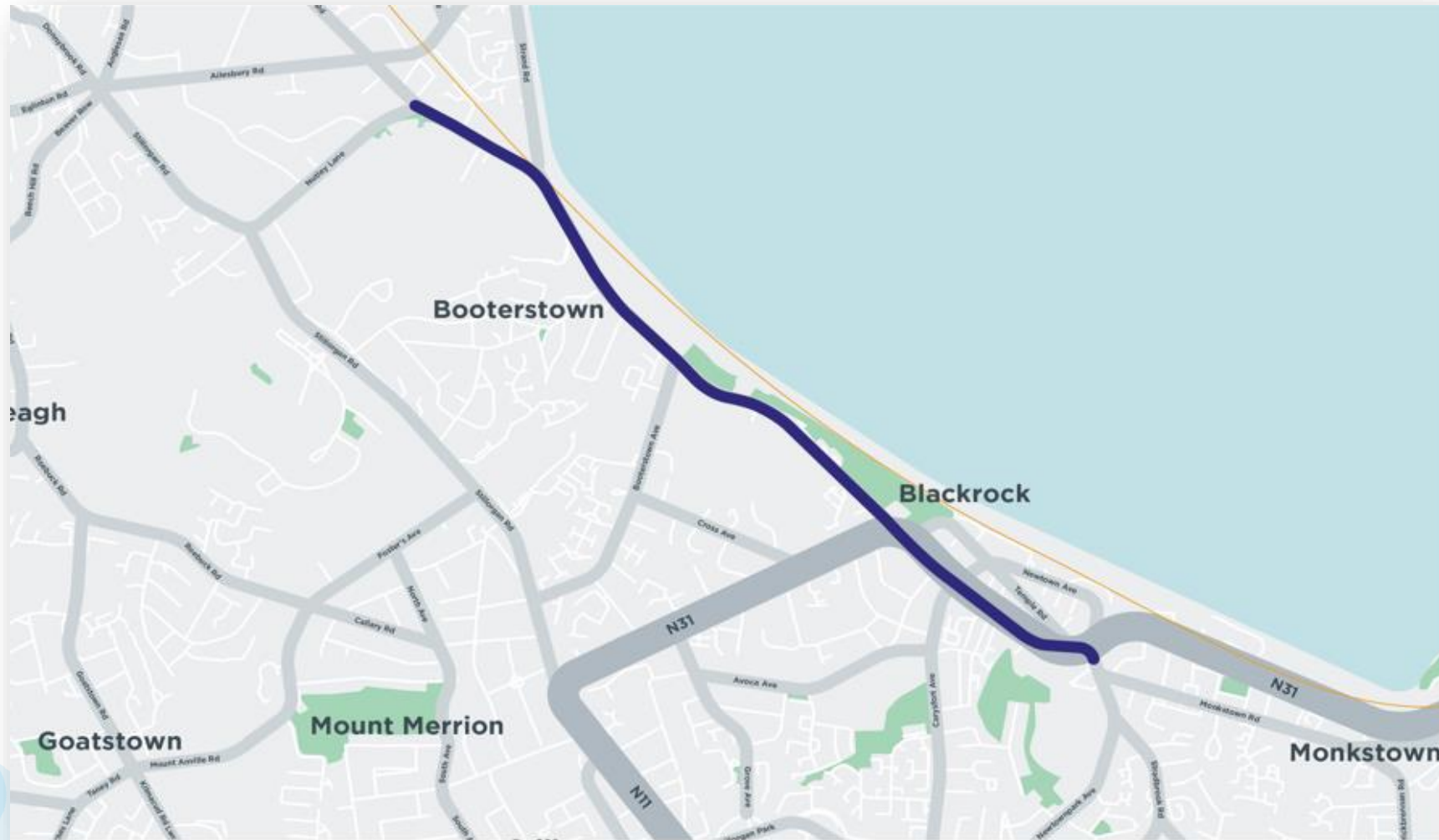

Blackrock to Merrion

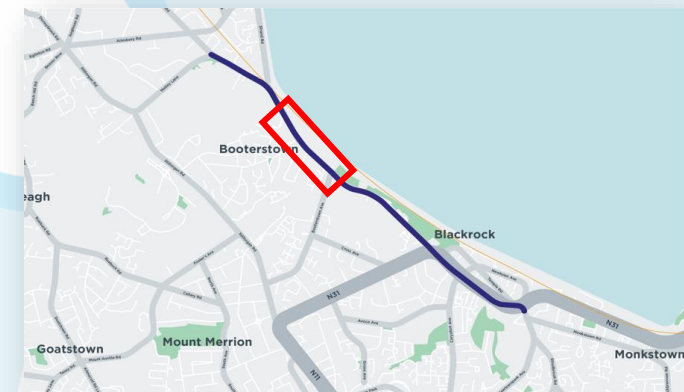
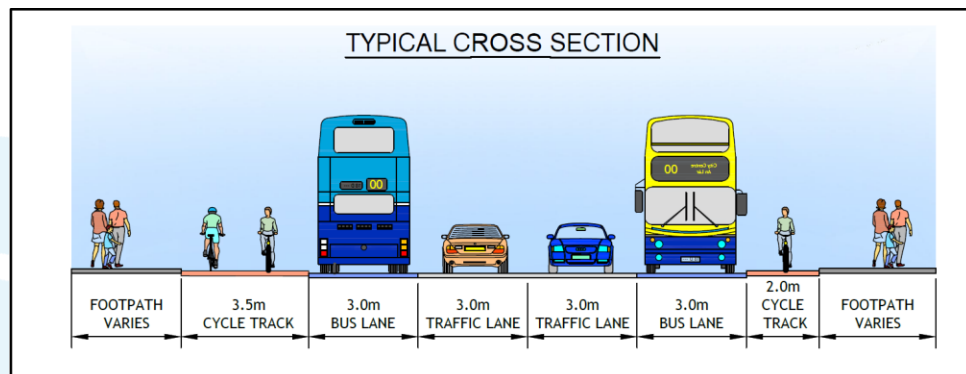
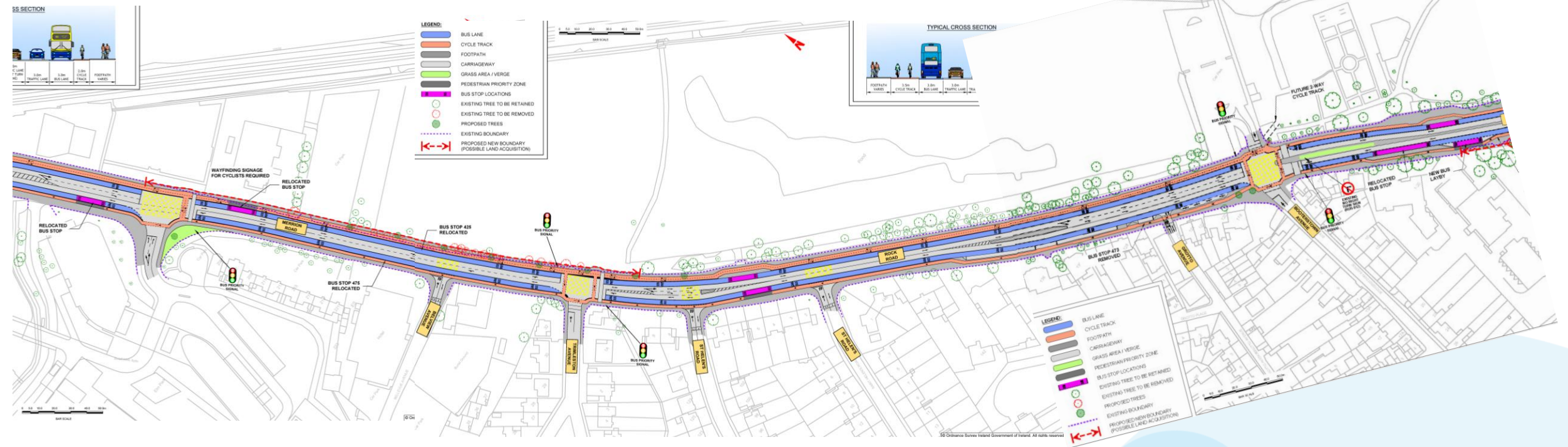

Blackrock to Merrion

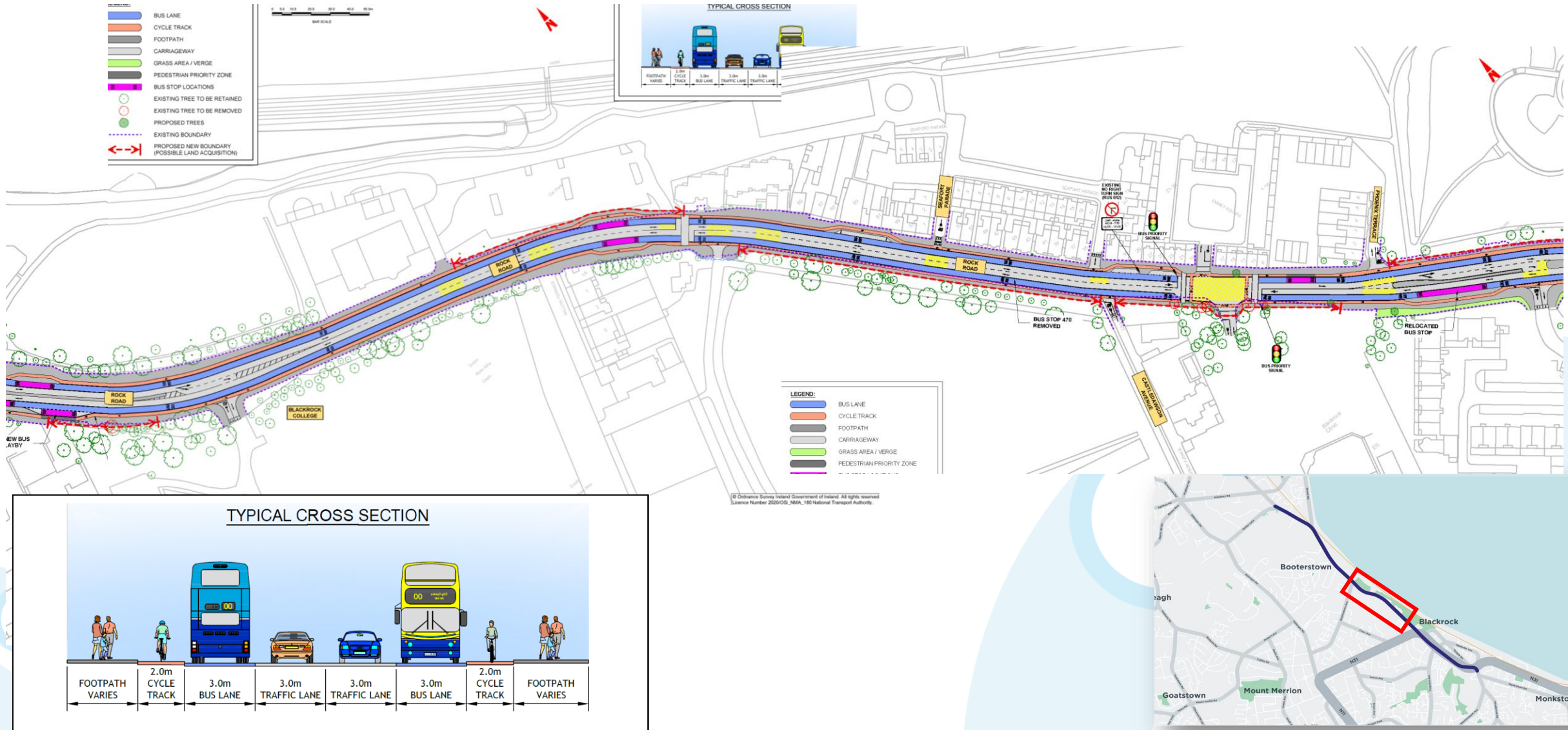

Blackrock to Merrion

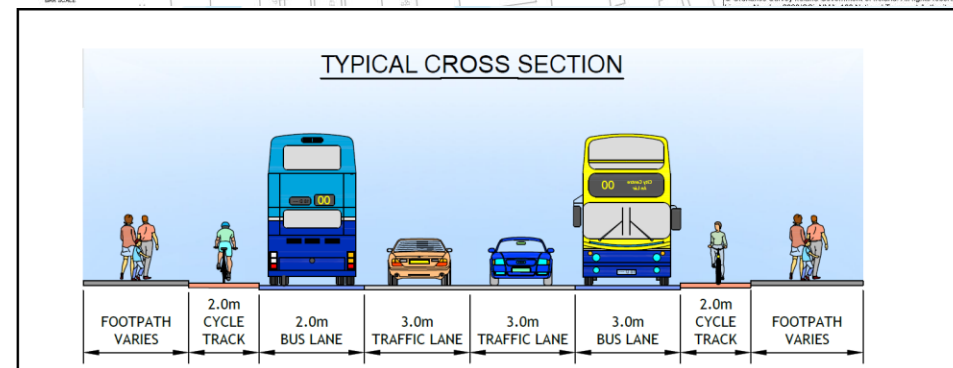
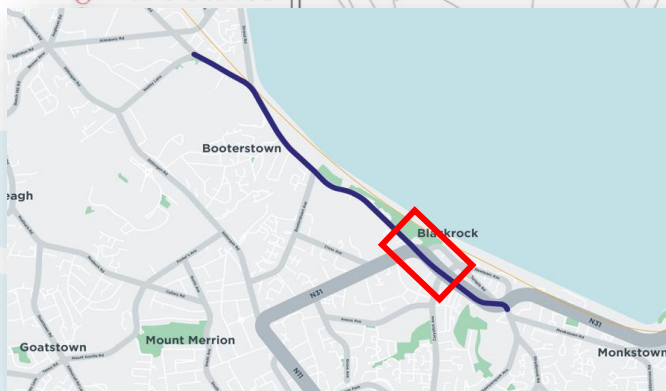
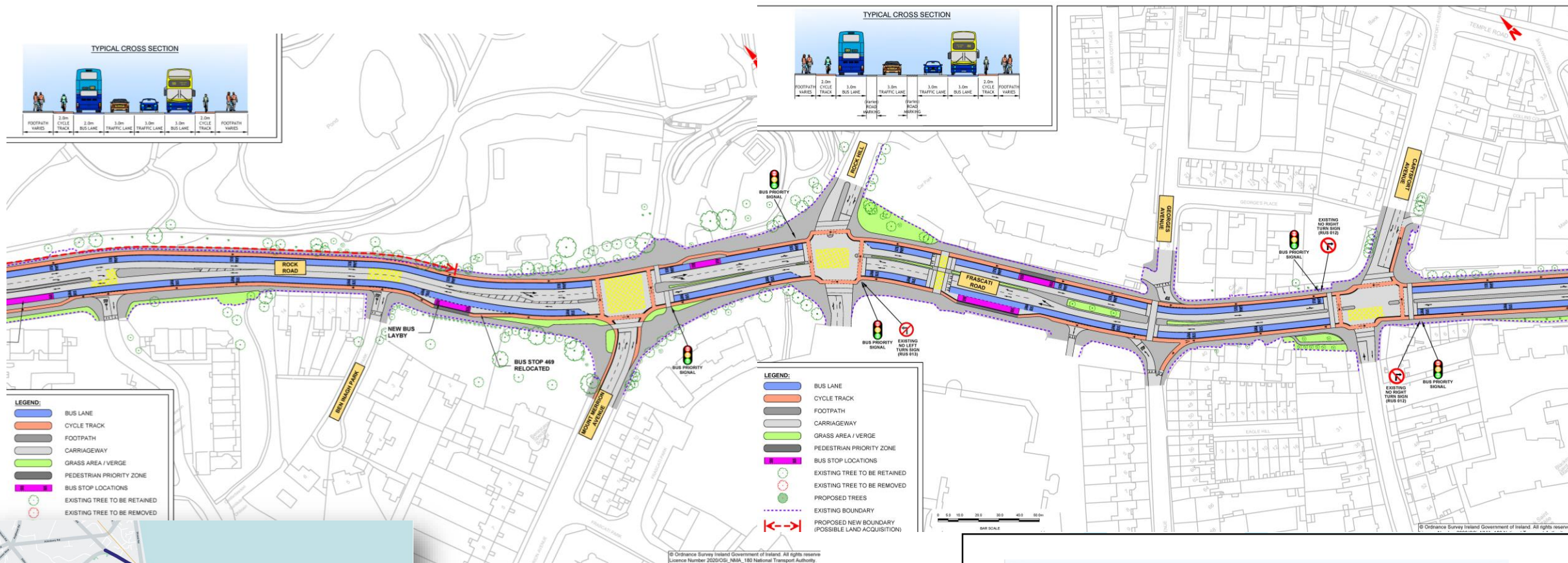

Blackrock to Merrion

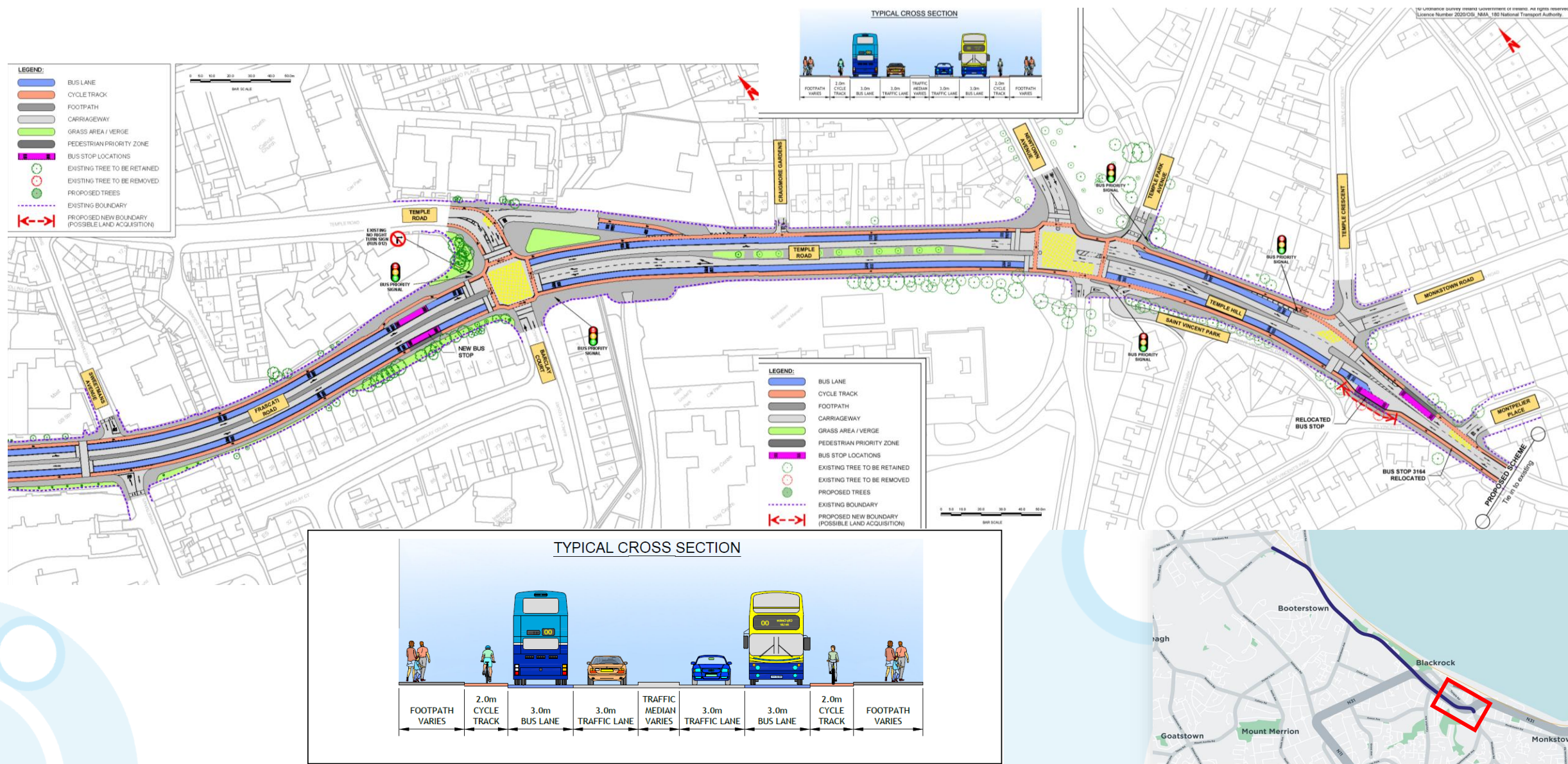

How to Engage?

How to Engage?

- Consultation on the proposals runs until **16 December**.
- Virtual consultation rooms for each Core Bus Corridor can be found on www.busconnects.ie.
- Submissions and observations may be made by:
 - **Email** - cbc@busconnects.ie
 - **Post** - Core Bus Corridor Project, National Transport Authority, Dún Scéine, Harcourt Lane, Dublin 2, D02 WT20.

Questions and Answers

If you wish to ask a question to the NTA panel, please type your Name and your Organisation into the 'Chat' box.

When you are called upon sequentially by the Independent Chairperson to ask your question, the Webinar host will UNMUTE your microphone and you will receive a 'prompt' or 'notification' to your screen to unmute. You can then proceed to ask your question.

Please keep your question concise so that we can take questions from all the community groups/organisations on the webinar.

How to Engage?

- Consultation on the proposals runs until **16 December**.
- Virtual consultation rooms for each Core Bus Corridor can be found on www.busconnects.ie.
- Submissions and observations may be made by:
 - **Email** - cbc@busconnects.ie
 - **Post** - Core Bus Corridor Project, National Transport Authority, Dún Scéine, Harcourt Lane, Dublin 2, D02 WT20.