

PLEASE REFER TO SHEET 2

EXISTING BOUNDARY -		PROPOSED CARRIAGEWAY -	
EXISTING KERB -		PROPOSED ROAD RAMP -	
POSSIBLE LAND ACQUISITION -		PROPOSED CYCLETRACK -	
PROPOSED ROAD KERBS -		PROPOSED FOOTPATH -	
PROPOSED BUS LANE / SHARED BUS AND CYCLETRACK -		GRASS VERGE -	
PROPOSED BUS STOP -		PARKING AREA -	
PROPOSED SHARED SURFACE -		LUAS BUS LANE -	
		CONCRETE ISLAND -	

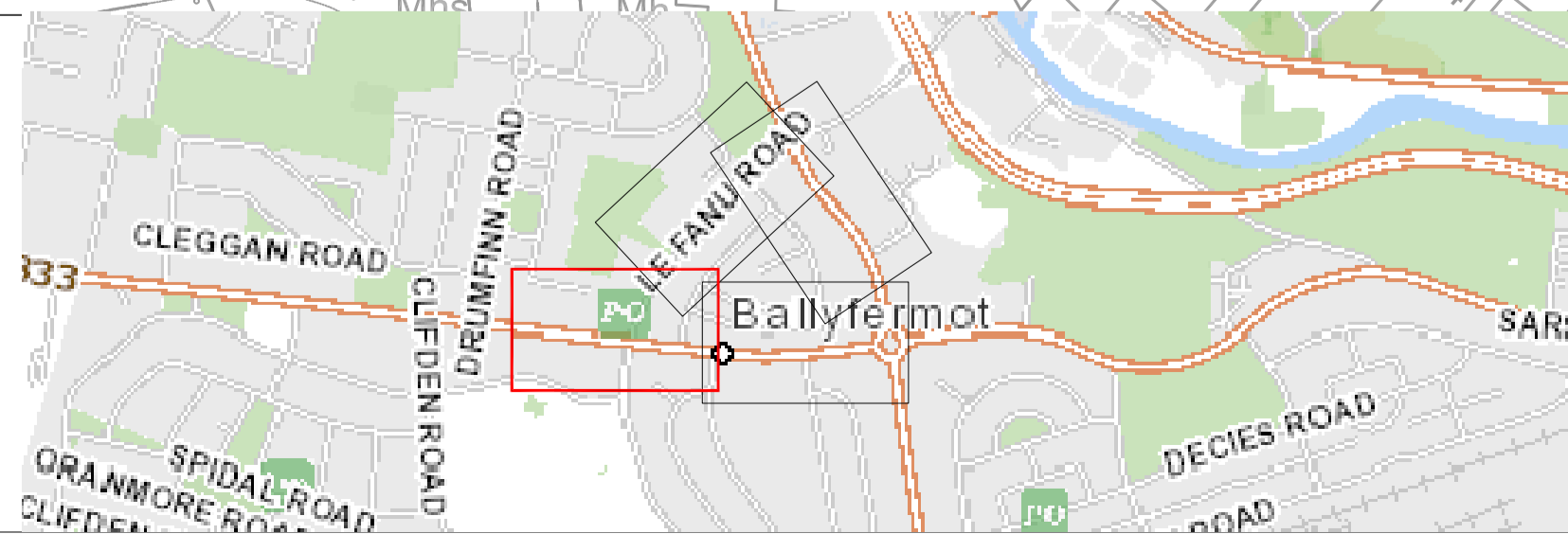

Liffey Valley To City Centre Sheet 1 of 4

NOTE
● REMOVING INBOUND PUBLIC TRAFFIC ON BALLYFERMOT ROAD BETWEEN LE FANU ROAD & KYLEMORE ROAD

REDISTRIBUTE EXISTING ROAD SPACE ON THE R883 TO PROVIDE BUS LANES AND CYCLE FACILITIES IN BOTH DIRECTIONS

ROAD WIDENING AND LAND TAKE REQUIRED

UPGRADE EXISTING ROUNDABOUT TO SIGNALISED JUNCTION

INBOUND PUBLIC TRAFFIC PROHIBITED ON BALLYFERMOT ROAD BETWEEN LA FANU ROAD AND KYLEMORE ROAD

PLEASE REFER TO SHEET 1

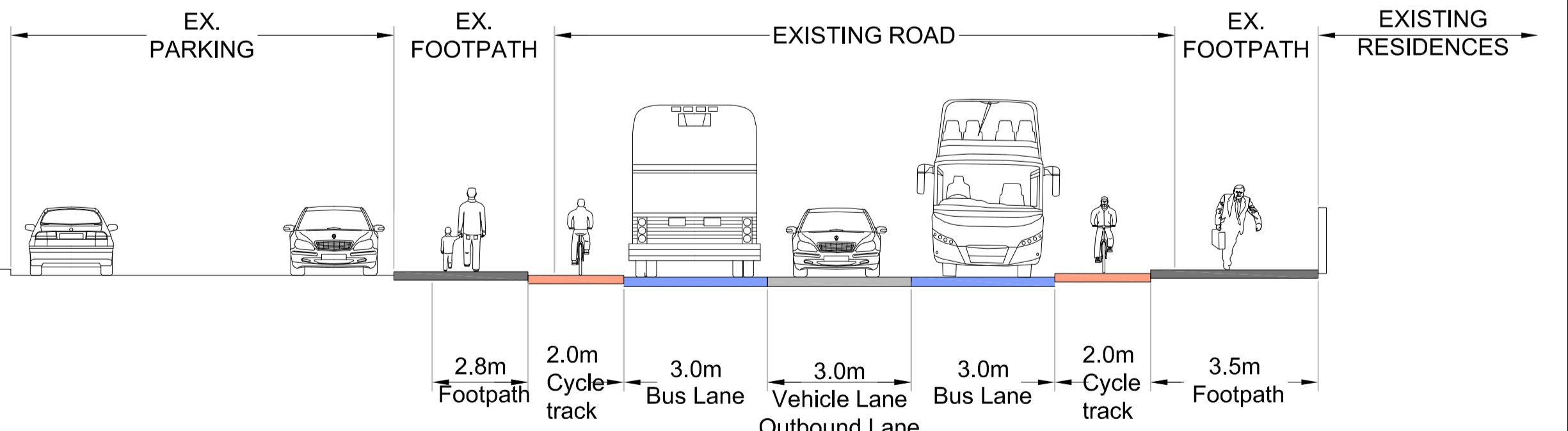
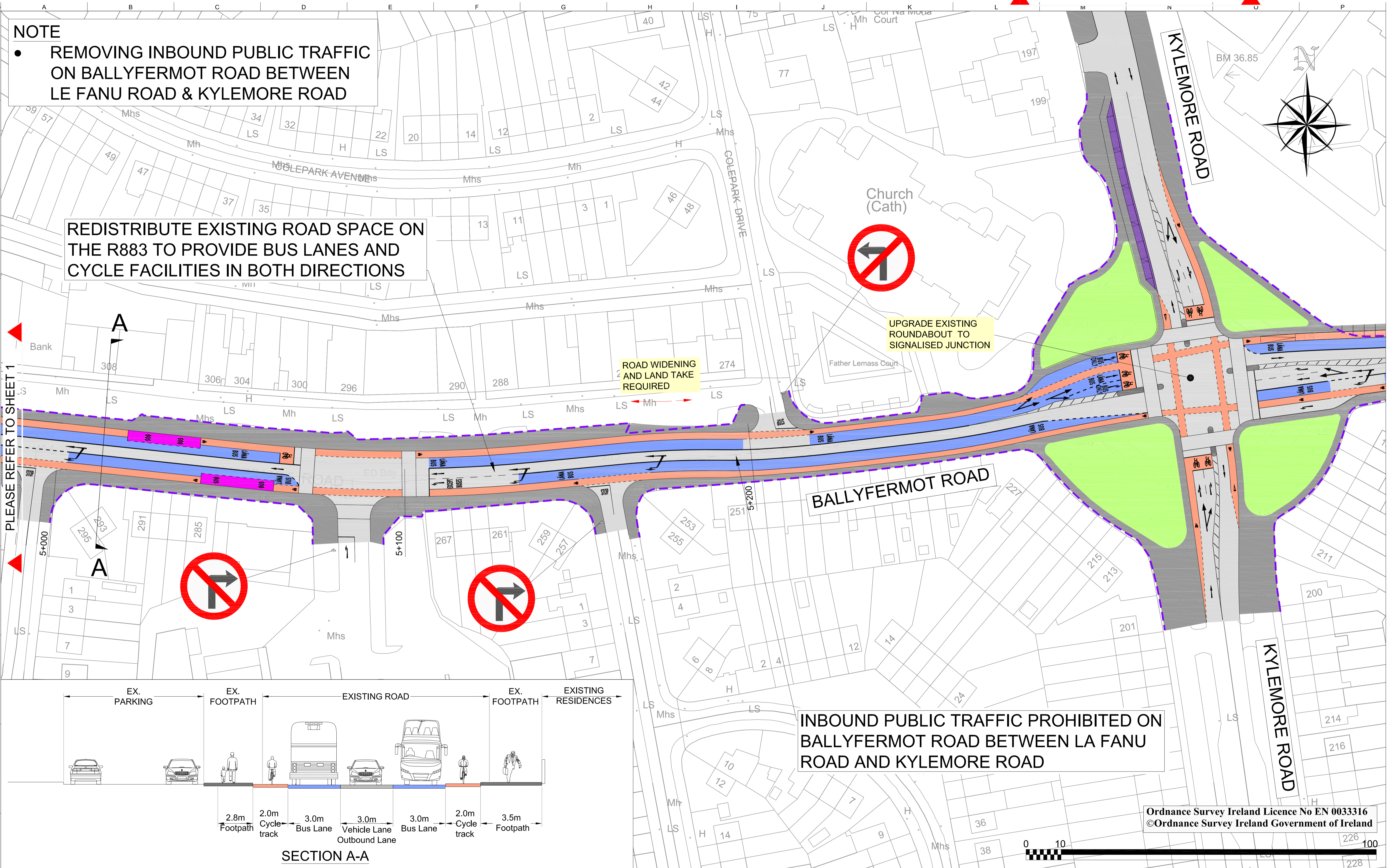
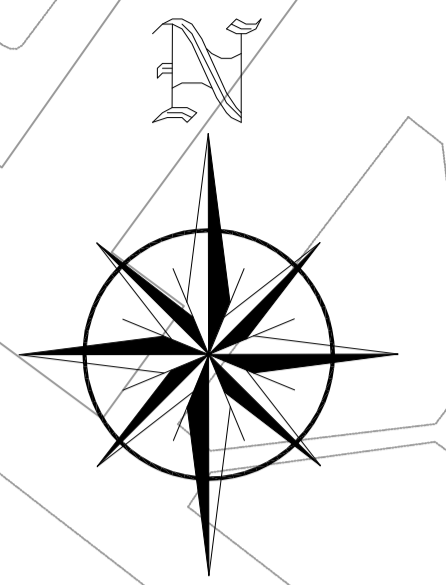

Ordnance Survey Ireland Licence No EN 0033316
© Ordnance Survey Ireland Government of Ireland

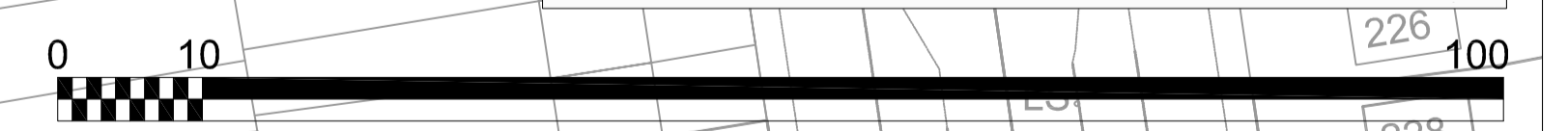

EXISTING BOUNDARY -	--- (dashed purple)	PROPOSED CARRIAGEWAY -	█ (grey)
EXISTING KERB -	--- (dashed blue)	PROPOSED ROAD RAMP -	█ (brown)
POSSIBLE LAND ACQUISITION -	--- (dashed red)	PROPOSED CYCLETRACK -	█ (orange)
PROPOSED ROAD KERBS -	--- (dashed black)	PROPOSED FOOTPATH -	█ (light grey)
PROPOSED BUS LANE / SHARED BUS AND CYCLETRACK -	█ (blue)	GRASS VERGE -	█ (light green)
PROPOSED BUS STOP -	█ (magenta)	PARKING AREA -	█ (purple)
PROPOSED SHARED SURFACE -	█ (dark grey)	LUAS LANE -	█ (red)
		CONCRETE ISLAND -	█ (black)

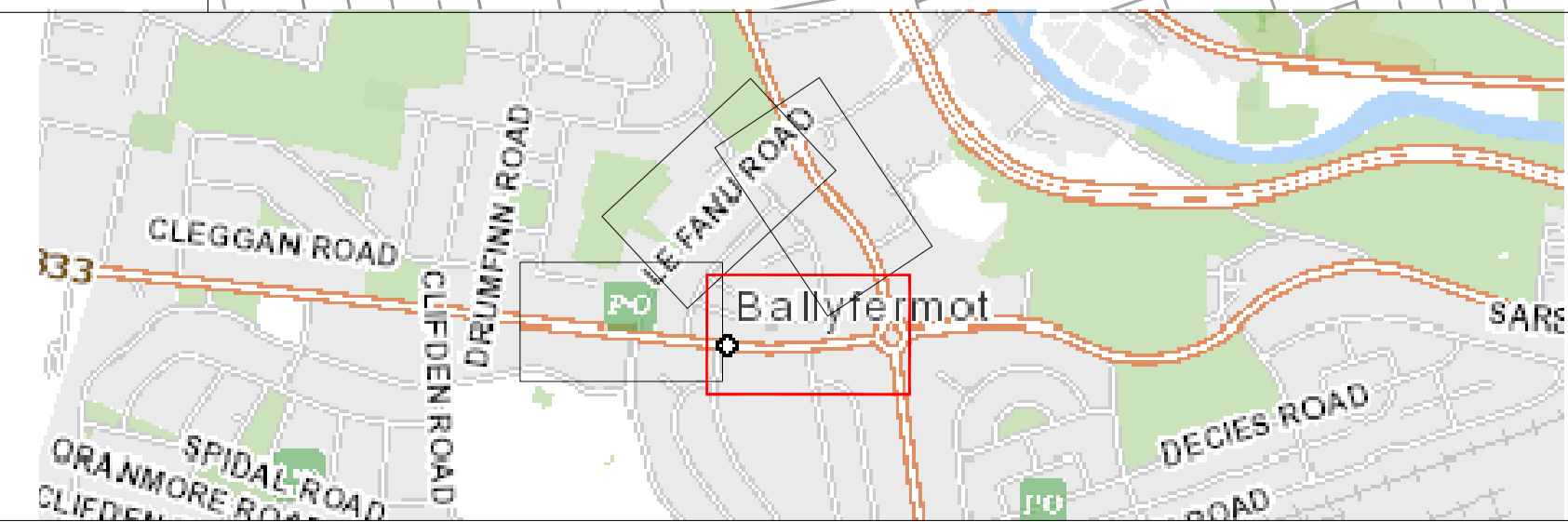

Liffey Valley To City Centre Sheet 2 of 4

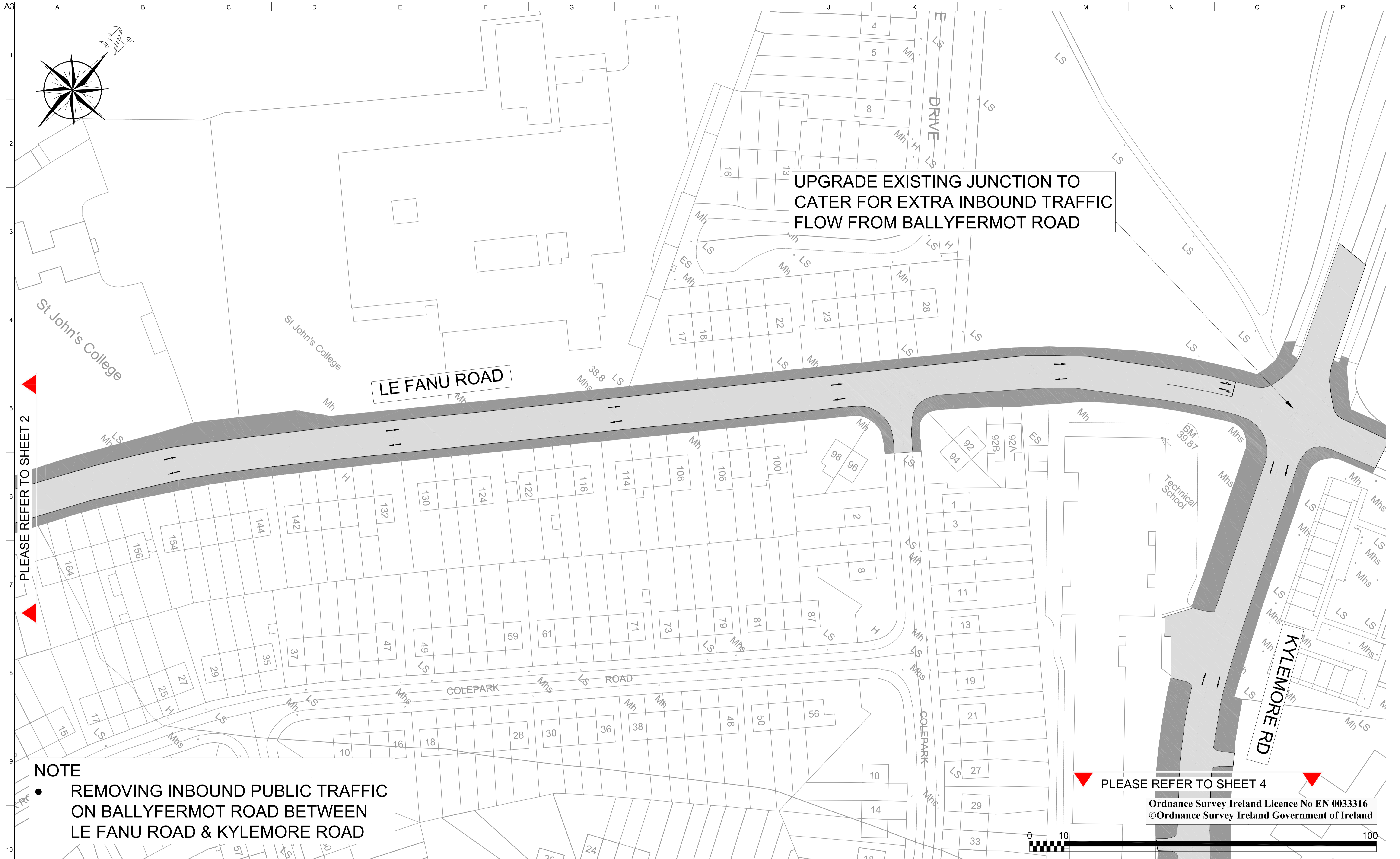

UPGRADE EXISTING JUNCTION TO CATER FOR EXTRA INBOUND TRAFFIC FLOW FROM BALLYFERMOT ROAD

PLEASE REFER TO SHEET 2

PLEASE REFER TO SHEET 4

NOTE

- REMOVING INBOUND PUBLIC TRAFFIC ON BALLYFERMOT ROAD BETWEEN LE FANU ROAD & KYLEMORE ROAD

Ordnance Survey Ireland Licence No EN 0033316
© Ordnance Survey Ireland Government of Ireland



EXISTING BOUNDARY -		PROPOSED CARRIAGEWAY -	
EXISTING KERB -		PROPOSED ROAD RAMP -	
POSSIBLE LAND ACQUISITION -		PROPOSED CYCLETRACK -	
PROPOSED ROAD KERBS -		PROPOSED FOOTPATH -	
PROPOSED BUS LANE /		GRASS VERGE -	
SHARED BUS AND CYCLETRACK -		PARKING AREA -	
PROPOSED BUS STOP -		LUAS LANE -	
PROPOSED SHARED SURFACE -		CONCRETE ISLAND -	

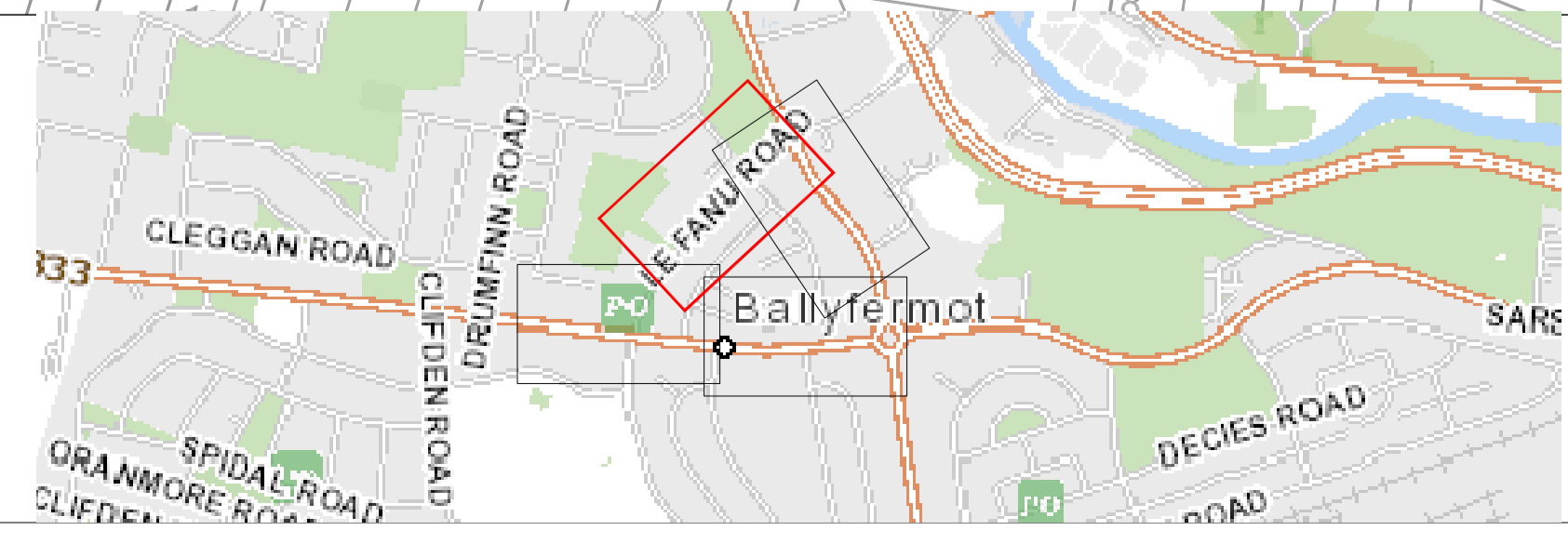

Liffey Valley To City Centre Sheet 3 of 4

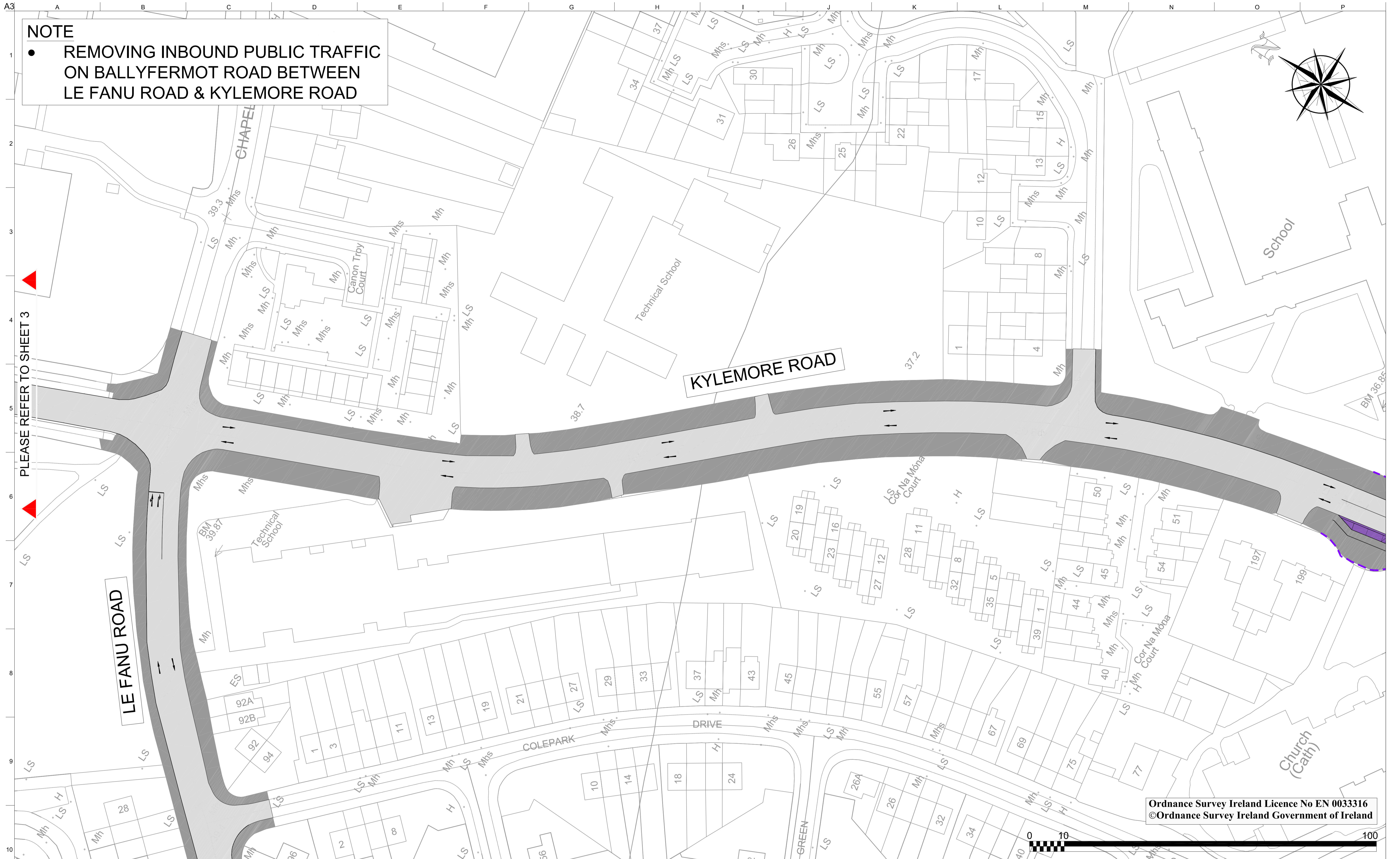

NOTE

- REMOVING INBOUND PUBLIC TRAFFIC ON BALLYFERMOT ROAD BETWEEN LE FANU ROAD & KYLEMORE ROAD

PLEASE REFER TO SHEET 3

Ordnance Survey Ireland Licence No EN 0033316
© Ordnance Survey Ireland Government of Ireland



EXISTING BOUNDARY -		PROPOSED CARRIAGEWAY -	
EXISTING KERB -		PROPOSED ROAD RAMP -	
POSSIBLE LAND ACQUISITION -		PROPOSED CYCLETRACK -	
PROPOSED ROAD KERBS -		PROPOSED FOOTPATH -	
PROPOSED BUS LANE /		GRASS VERGE -	
SHARED BUS AND CYCLETRACK -		PARKING AREA -	
PROPOSED BUS STOP -		LUAS LANE -	
PROPOSED SHARED SURFACE -		CONCRETE ISLAND -	

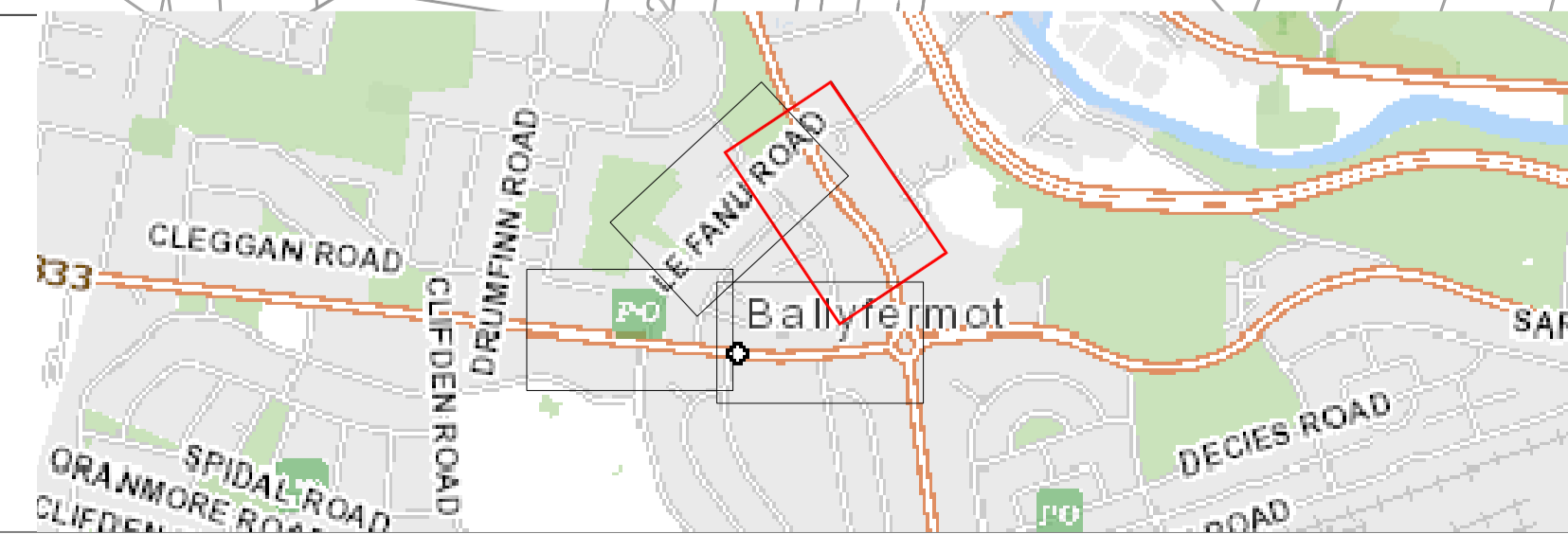

Liffey Valley To City Centre Sheet 4 of 4