

Shankill N11
Possible Option with Alternative Cycle Route

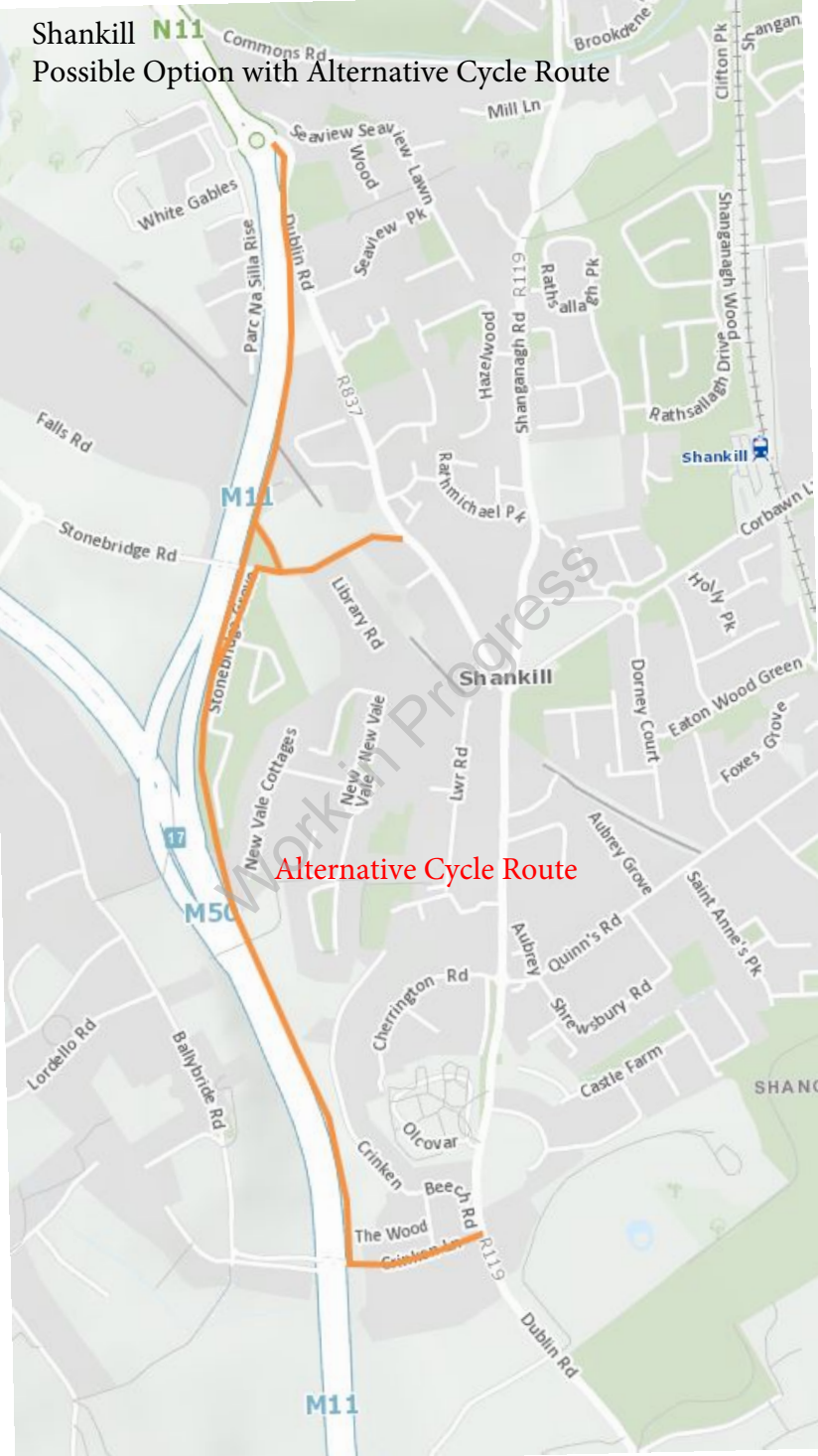

- LEGEND:**
- BUS LANE
 - CYCLE TRACK
 - FOOTPATH
 - CARRIAGEWAY
 - GRASS AREA / VERGE
 - SHARED AREA
 - BUS STOP LOCATIONS
 - EXISTING BOUNDARY
 - PROPOSED NEW BOUNDARY (POSSIBLE LAND ACQUISITION)

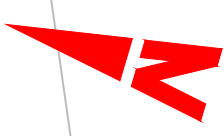
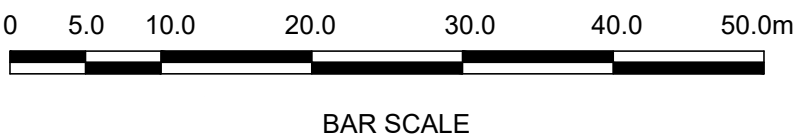

Shankill

Possible Option with Alternative Cycle Route

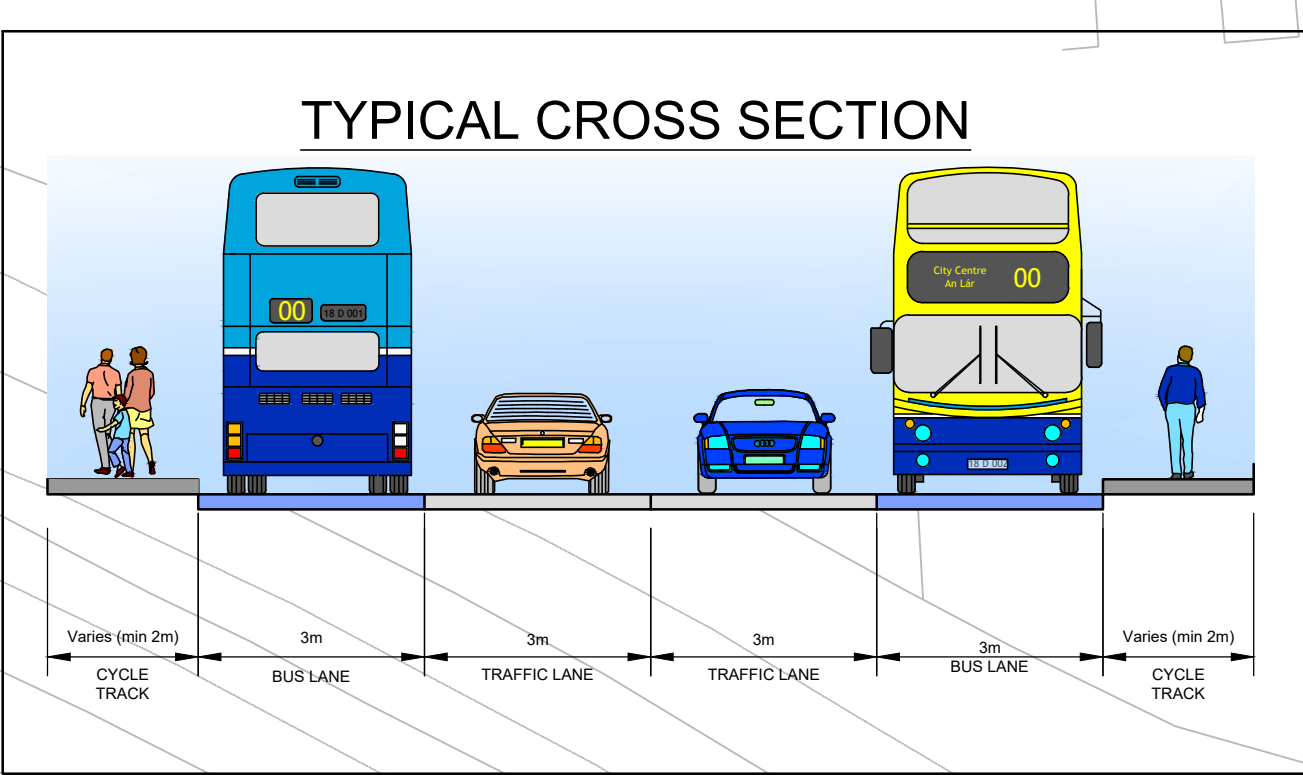
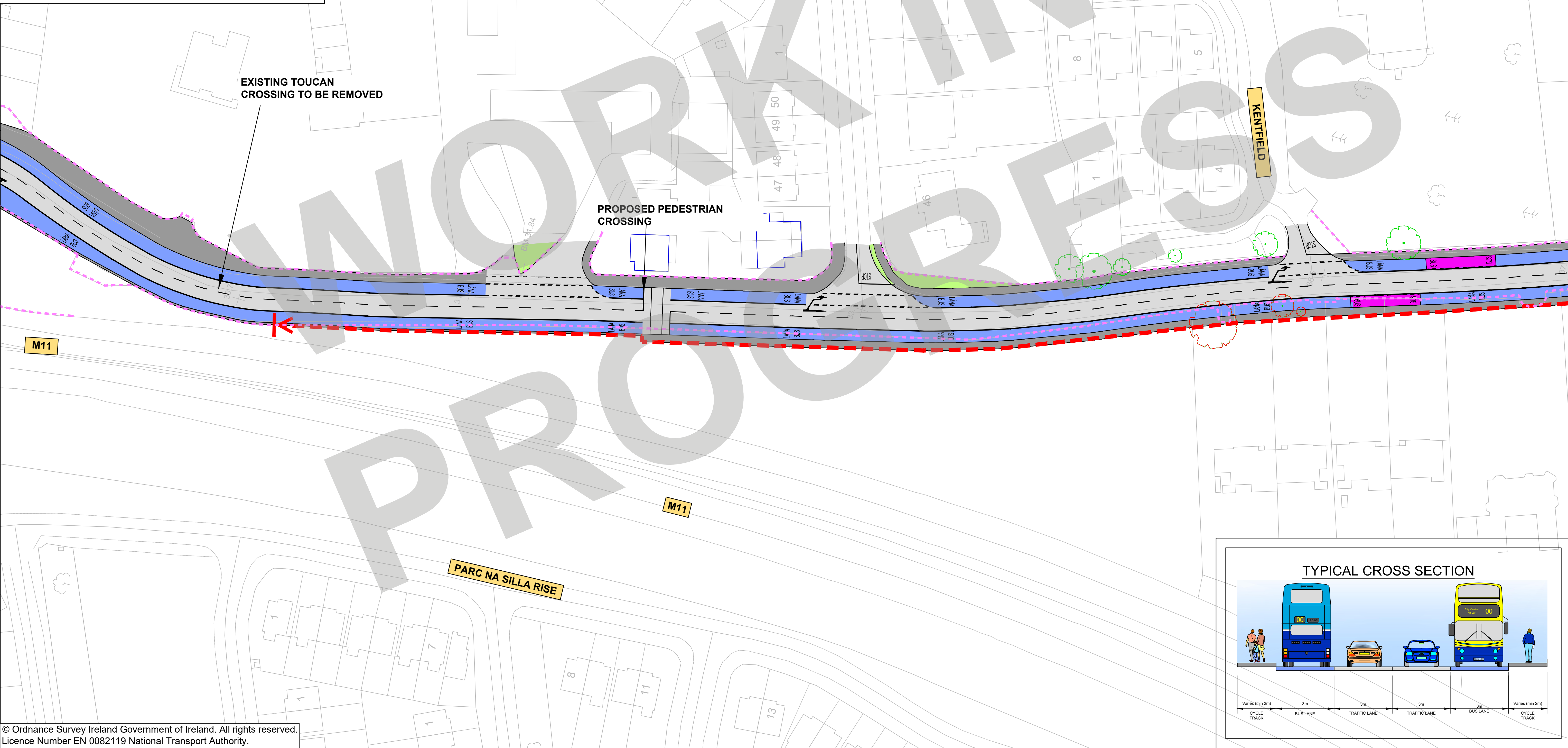

LEGEND:

- BUS LANE
- CYCLE TRACK
- FOOTPATH
- CARRIAGEWAY
- GRASS AREA / VERGE
- SHARED AREA
- BUS STOP LOCATIONS
- EXISTING BOUNDARY
- PROPOSED NEW BOUNDARY (POSSIBLE LAND ACQUISITION)

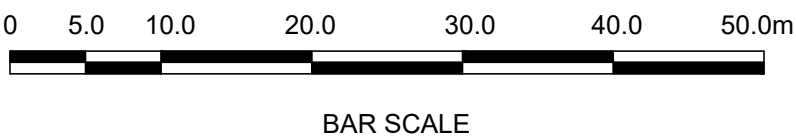

Shankill

Possible Option with Alternative Cycle Route

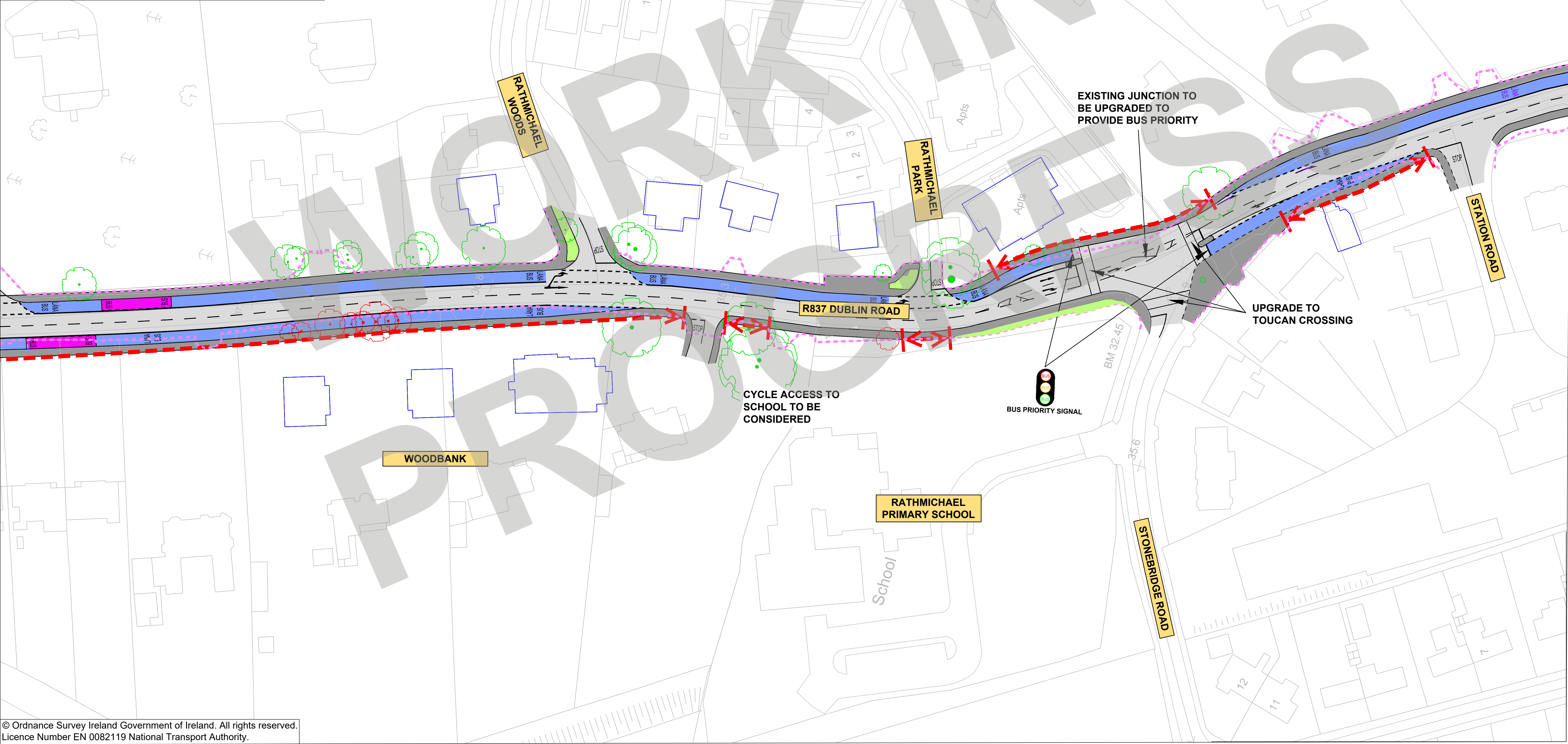

BAR SCALE



LEGEND:

BUS LANE

CYCLE TRACK

FOOTPATH

CARRIAGEWAY

GRASS AREA / VERGE

SHARED AREA

BUS STOP LOCATIONS

EXISTING BOUNDARY

PROPOSED NEW BOUNDARY
(POSSIBLE LAND ACQUISITION)

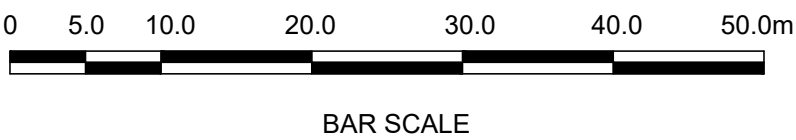

MAP 45A

Shankill

Possible Option with Alternative Cycle Route

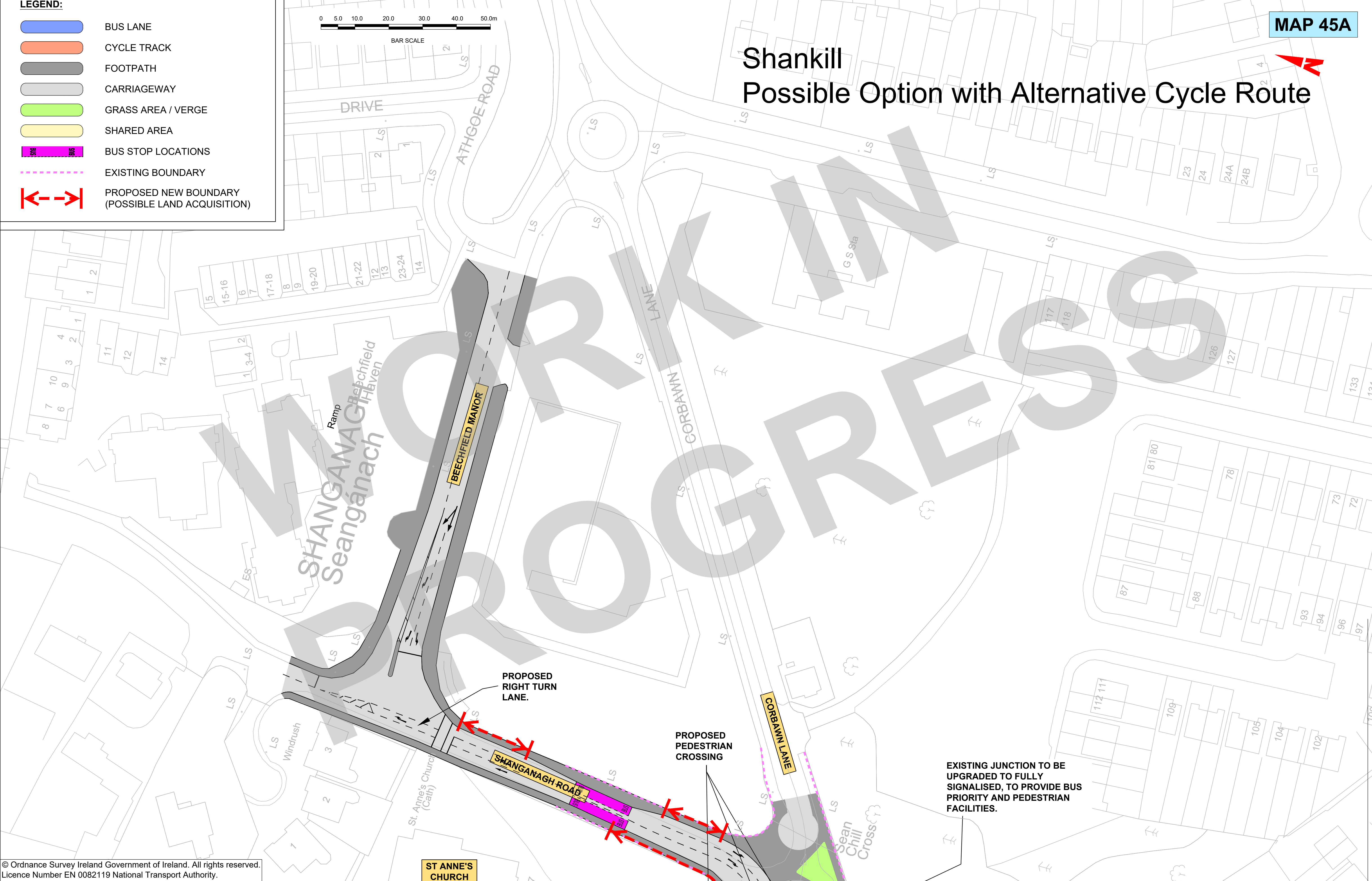

© Ordnance Survey Ireland Government of Ireland. All rights reserved.
Licence Number EN 0082119 National Transport Authority.

Disclaimer

a. © National Transport Authority (NTA) 2019. This drawing is confidential and the copyright in it is owned by NTA. This drawing must not be either loaned, copied or otherwise reproduced in whole or in part or used for any purpose without the prior permission of NTA.

b. This drawing is to be used for the design element identified in the titlebox. Other information shown is to be considered indicative only. The drawing is to be read in conjunction with all other relevant design drawings.

c. O.S. data used for plans are printed under © Ordnance Survey Ireland Government of Ireland. All rights reserved. Licence Number EN 0082119 National Transport Authority. All elevations are in metres and relate to OSI Geoid Model (OSGM15) Malin Head. All Co-ordinates are in Irish Transverse Mercator Grid (ITM) as defined by OSI active local GPS station.

d. Information concerning the position of apparatus shown in this drawing is based on drawings supplied by the utility owners and/or the utility works contractor, whilst every care has been taken in the preparation of this drawing, positions should be taken as approximate and are intended for general guidance only and no representation is made by the NTA as to the accuracy, completeness, sufficiency or otherwise of this drawing and the position of the apparatus. The information contained herein does not purport to be comprehensive or final as the apparatus is subject to being altered and/or superceded. Recipients should not rely on this information. Any liabilities are hereby expressly disclaimed.

e. The information contained herein has been provided by the NTA but does not purport to be comprehensive or final. Recipients should not rely on the information. Neither the NTA nor any of its directors, officers, employees, agents, stakeholders or advisers make any representation or warranty as to, or accept any liability or responsibility in relation to, the adequacy, accuracy, reasonableness or completeness of the information provided as part of this document or any matter on which the information is based (including but not limited to loss or damage arising as a result of reliance by recipients on the information or any part of it. Any liabilities are hereby expressly disclaimed.

ST ANNE'S CHURCH

Rev	Date	Drn	Chk'd	App'd	Description
					SCHEME CONCEPT
AutoCAD data does NOT comply with the NTA CAD Standard					

Client ..Inta\nta.jpg		Engineering Designer DRAFT			Project Title BUSCONNECTS Core Bus Corridors Emerging Preferred Routes / Public Consultation			
Date OCT. 2019	Scale 1:500 @ A1 1:1000 @ A3	Drawn	Checked	Approved	Drawing Title ROUTE 13 BRAY TO CITY CENTRE GENERAL ARRANGEMENT			
Project Code	Originator Code	QMS Code			Drawing File Reference SHANKILL NORTH	Sheet Number 45A of 56	Status	Rev

DO NOT SCALE USE FIGURED DIMENSIONS ONLY

LEGEND:

- BUS LANE
- CYCLE TRACK
- FOOTPATH
- CARRIAGEWAY
- GRASS AREA / VERGE
- SHARED AREA
- BUS STOP LOCATIONS
- EXISTING BOUNDARY
- PROPOSED NEW BOUNDARY (POSSIBLE LAND ACQUISITION)



MAP 46



Shankill

Possible Option with Alternative Cycle Route

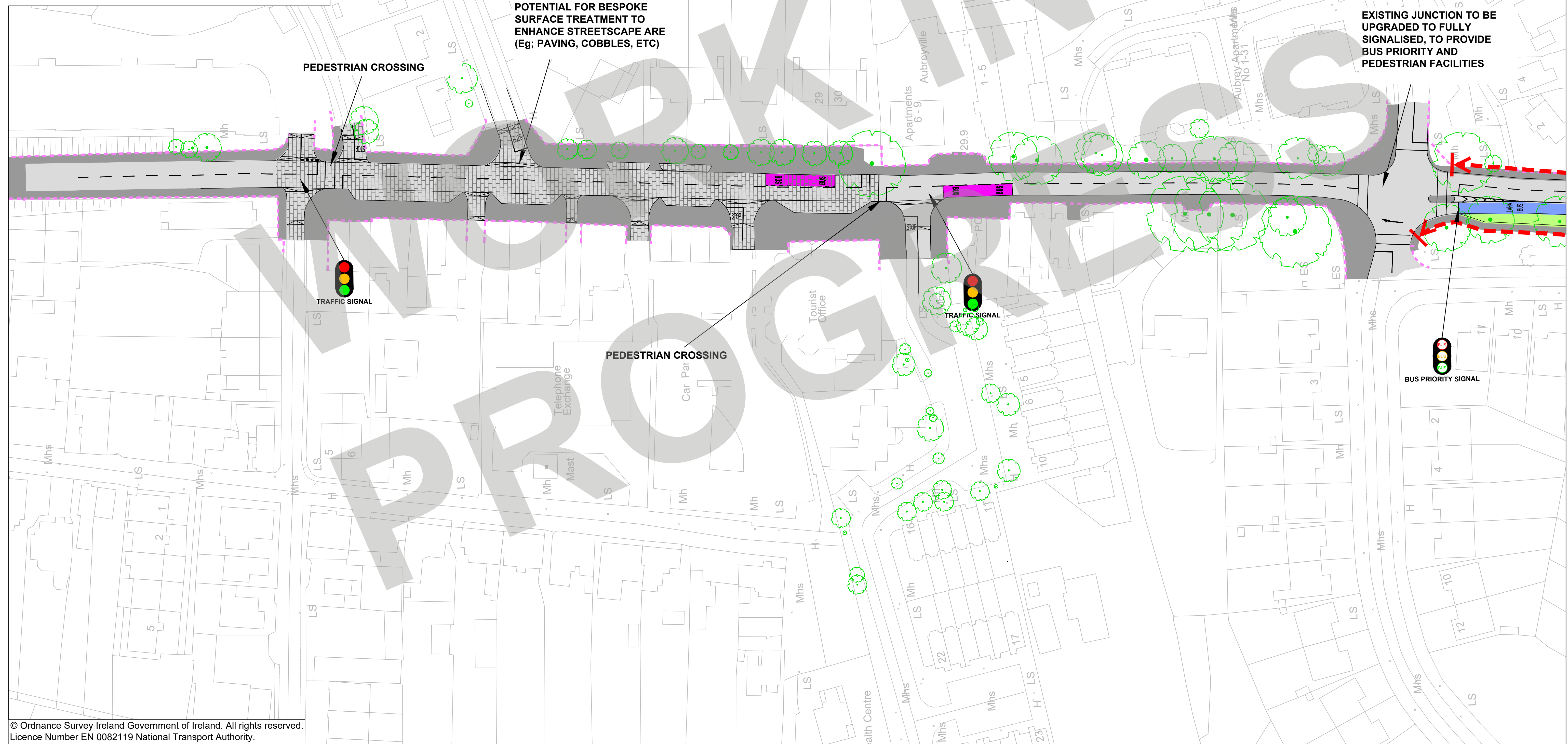

- LEGEND:**
- BUS LANE
 - CYCLE TRACK
 - FOOTPATH
 - CARRIAGEWAY
 - GRASS AREA / VERGE
 - SHARED AREA
 - BUS STOP LOCATIONS
 - EXISTING BOUNDARY
 - PROPOSED NEW BOUNDARY (POSSIBLE LAND ACQUISITION)

0 5.0 10.0 20.0 30.0 40.0 50.0m
BAR SCALE

MAP 47

Shankill

Possible Option with Alternative Cycle Route

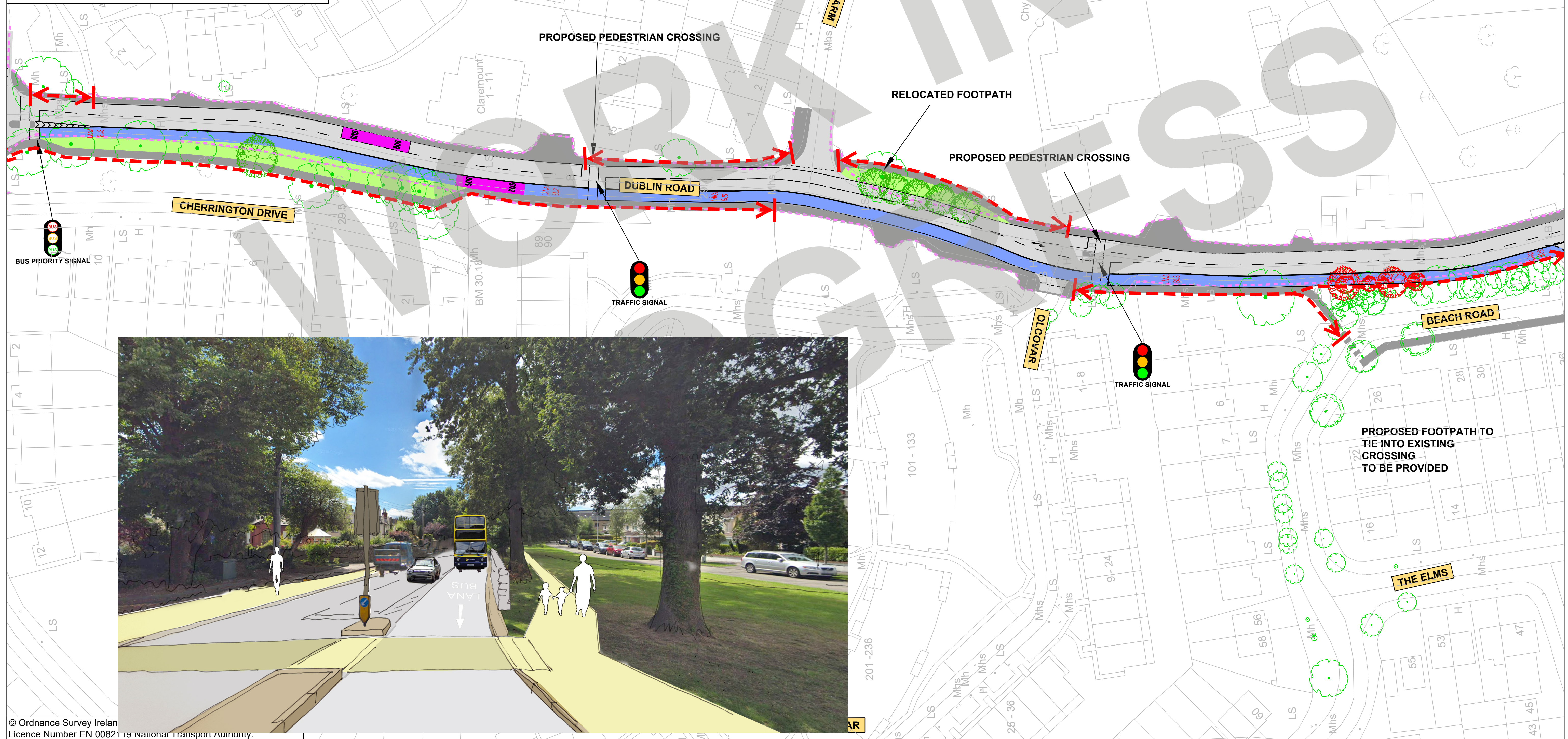

LEGEND:

- BUS LANE
- CYCLE TRACK
- FOOTPATH
- CARRIAGEWAY
- GRASS AREA / VERGE
- SHARED AREA
- BUS STOP LOCATIONS
- EXISTING BOUNDARY
- PROPOSED NEW BOUNDARY (POSSIBLE LAND ACQUISITION)

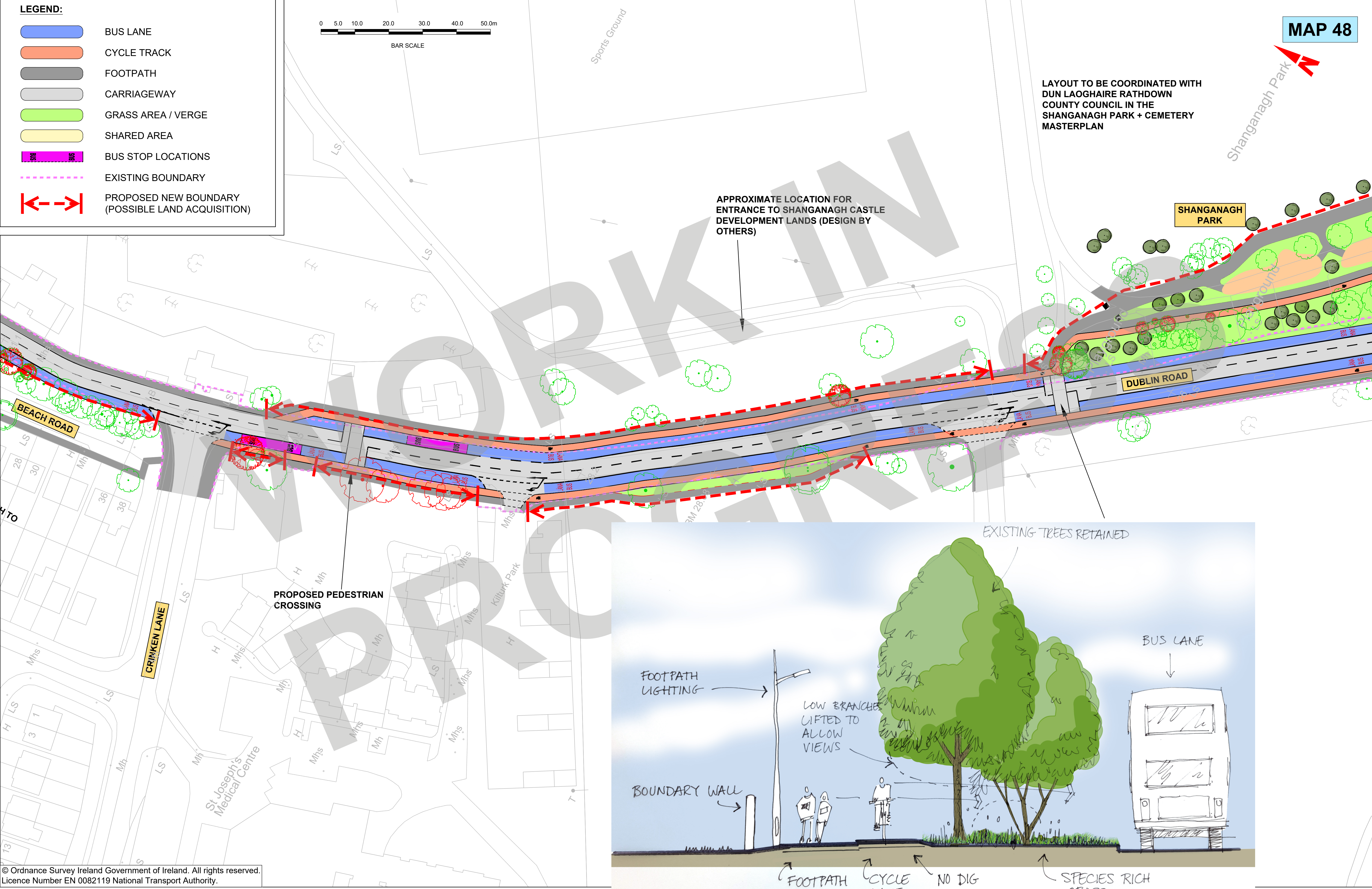
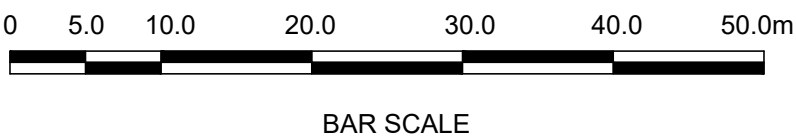

© Ordnance Survey Ireland Government of Ireland. All rights reserved.
Licence Number EN 0082119 National Transport Authority.

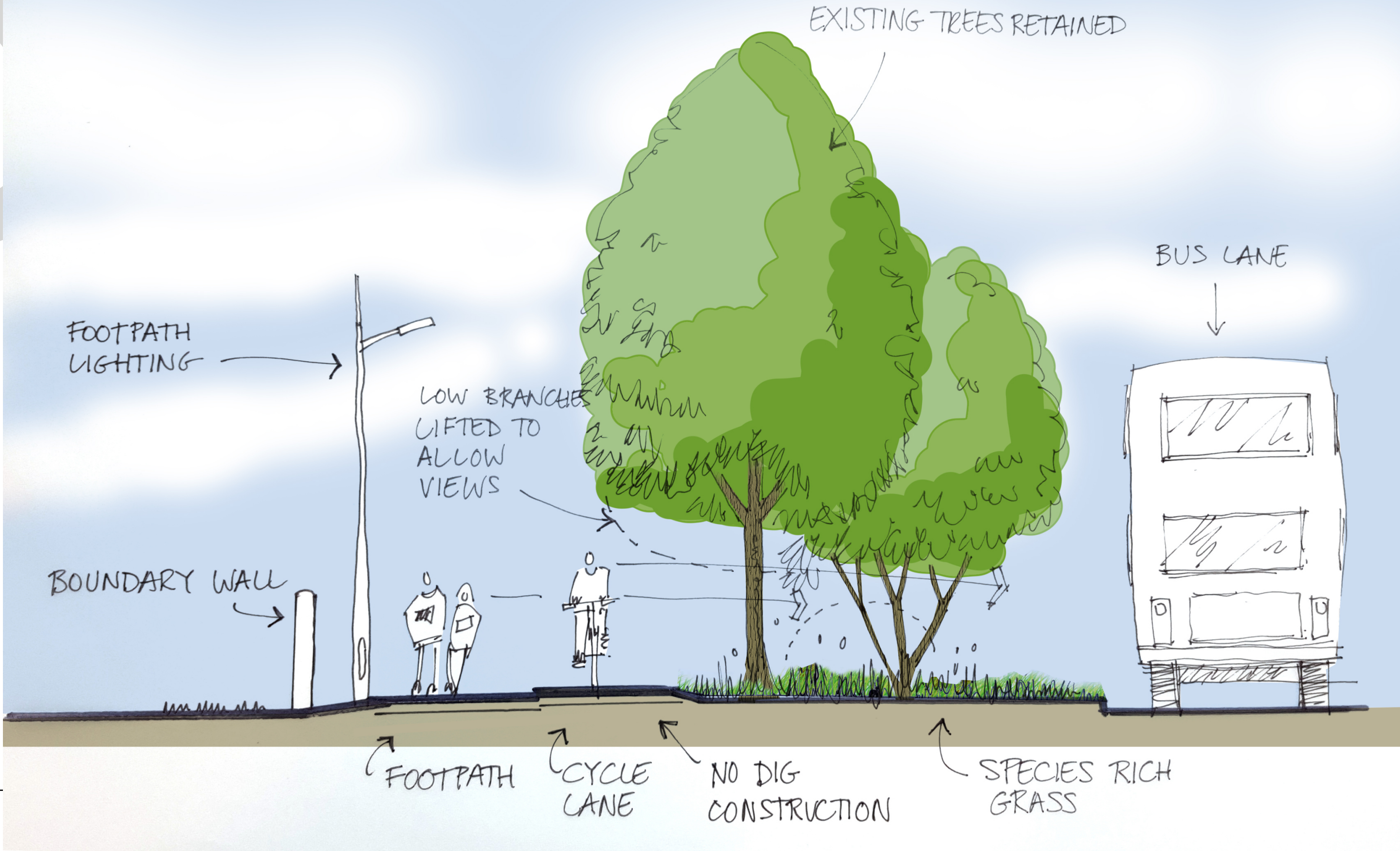

LEGEND:

- BUS LANE
- CYCLE TRACK
- FOOTPATH
- CARRIAGEWAY
- GRASS AREA / VERGE
- SHARED AREA
- BUS STOP LOCATIONS
- EXISTING BOUNDARY
- PROPOSED NEW BOUNDARY (POSSIBLE LAND ACQUISITION)

