



**Ballincollig to City**  
Sustainable Transport Corridor  
Preferred Route

3rd Round of Public Consultation November 2023



Rialtas  
na hÉireann  
Government  
of Ireland

Tionscadal Éireann  
Project Ireland  
**2040**

**BUS  
CONNECTS  
CORK**  
SUSTAINABLE TRANSPORT FOR A BETTER CITY.

# Index Map

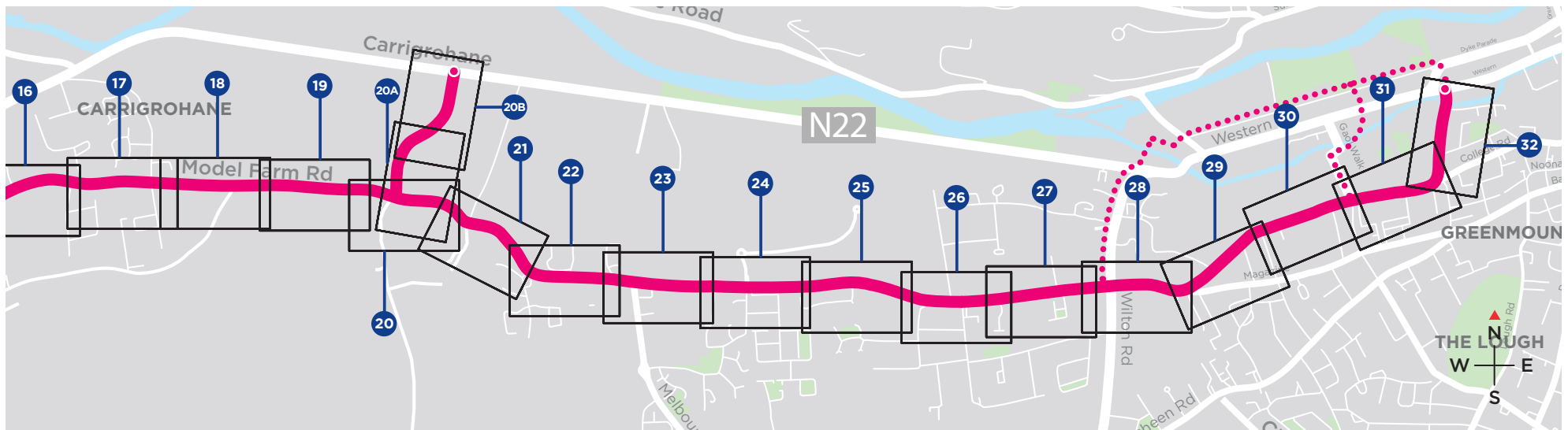
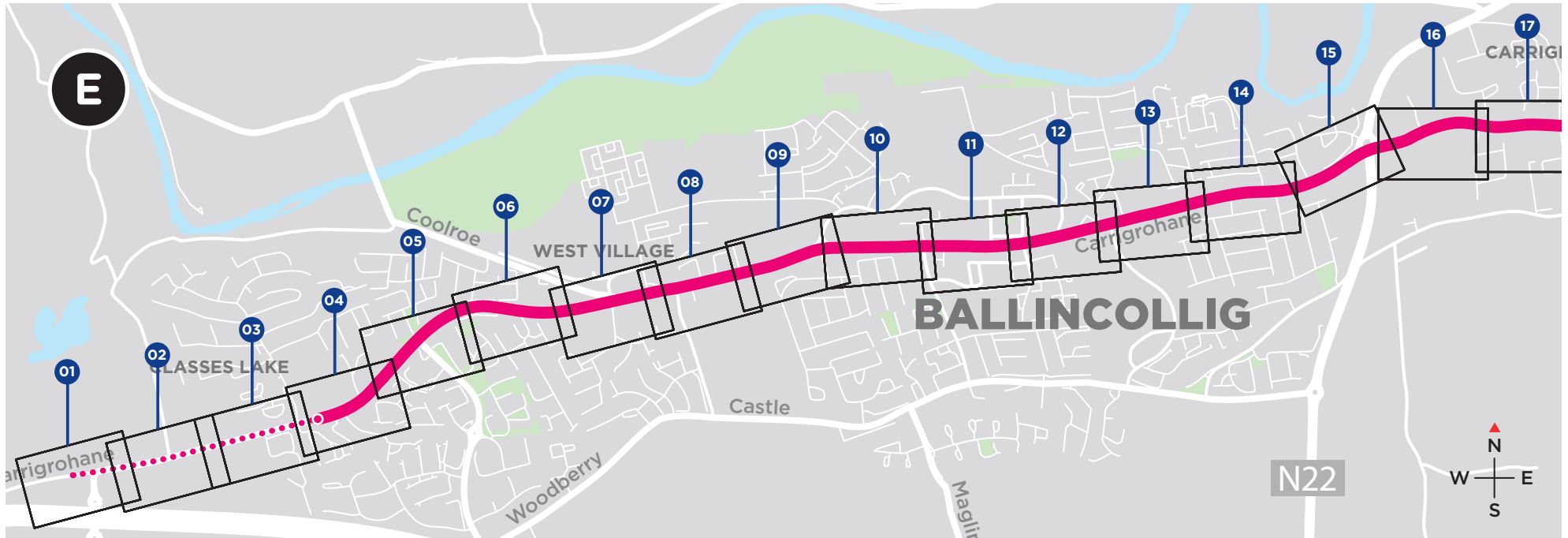

NOTE: The Preferred Route shown on the following drawings is indicative only and is subject to change following consultation and as part of the design development process.

CYAL50298388 © Ordnance Survey Ireland/Government of Ireland.  
OSI Mapping has been "adjusted in accordance with survey evidence"

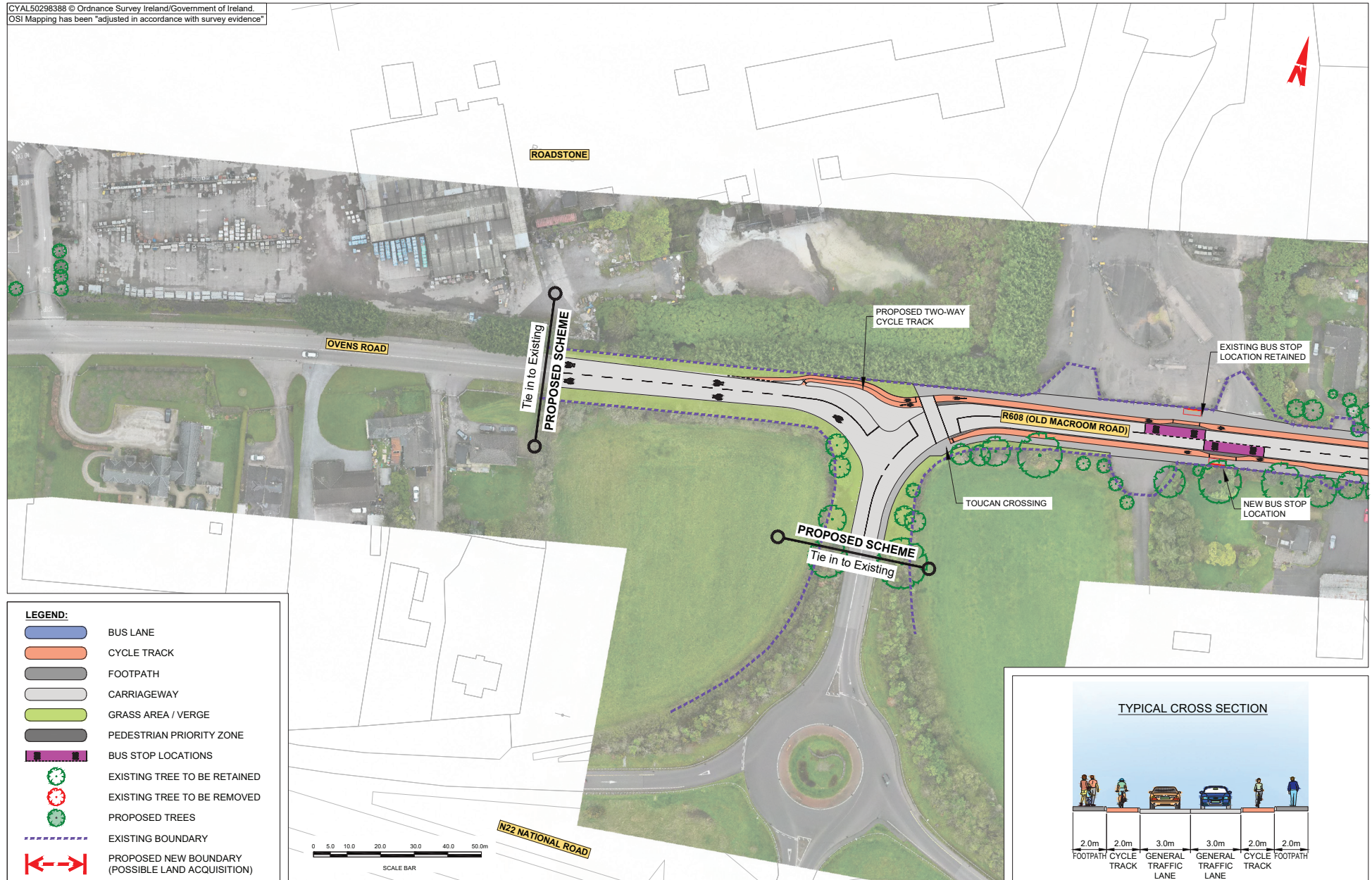

CYAL50298388 © Ordnance Survey Ireland/Government of Ireland.  
OSI Mapping has been "adjusted in accordance with survey evidence"

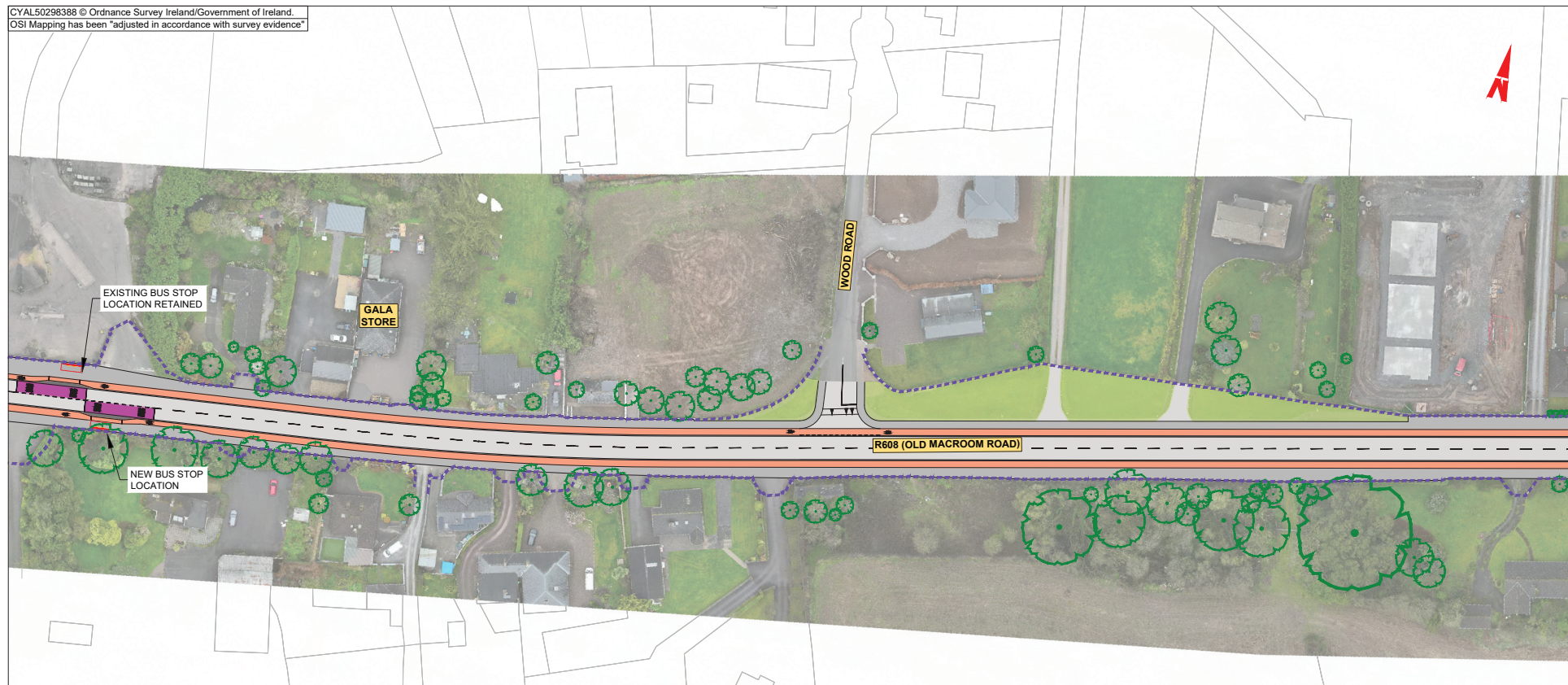

**LEGEND:**

- BUS LANE
- CYCLE TRACK
- FOOTPATH
- CARRIAGEWAY
- GRASS AREA / VERGE
- PEDESTRIAN PRIORITY ZONE
- BUS STOP LOCATIONS
- EXISTING TREE TO BE RETAINED
- EXISTING TREE TO BE REMOVED
- PROPOSED TREES
- EXISTING BOUNDARY
- PROPOSED NEW BOUNDARY (POSSIBLE LAND ACQUISITION)

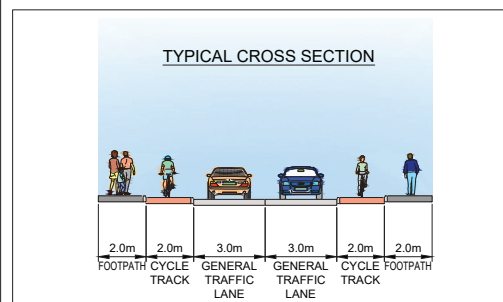

CYAL50298388 © Ordnance Survey Ireland/Government of Ireland.  
OSI Mapping has been "adjusted in accordance with survey evidence"

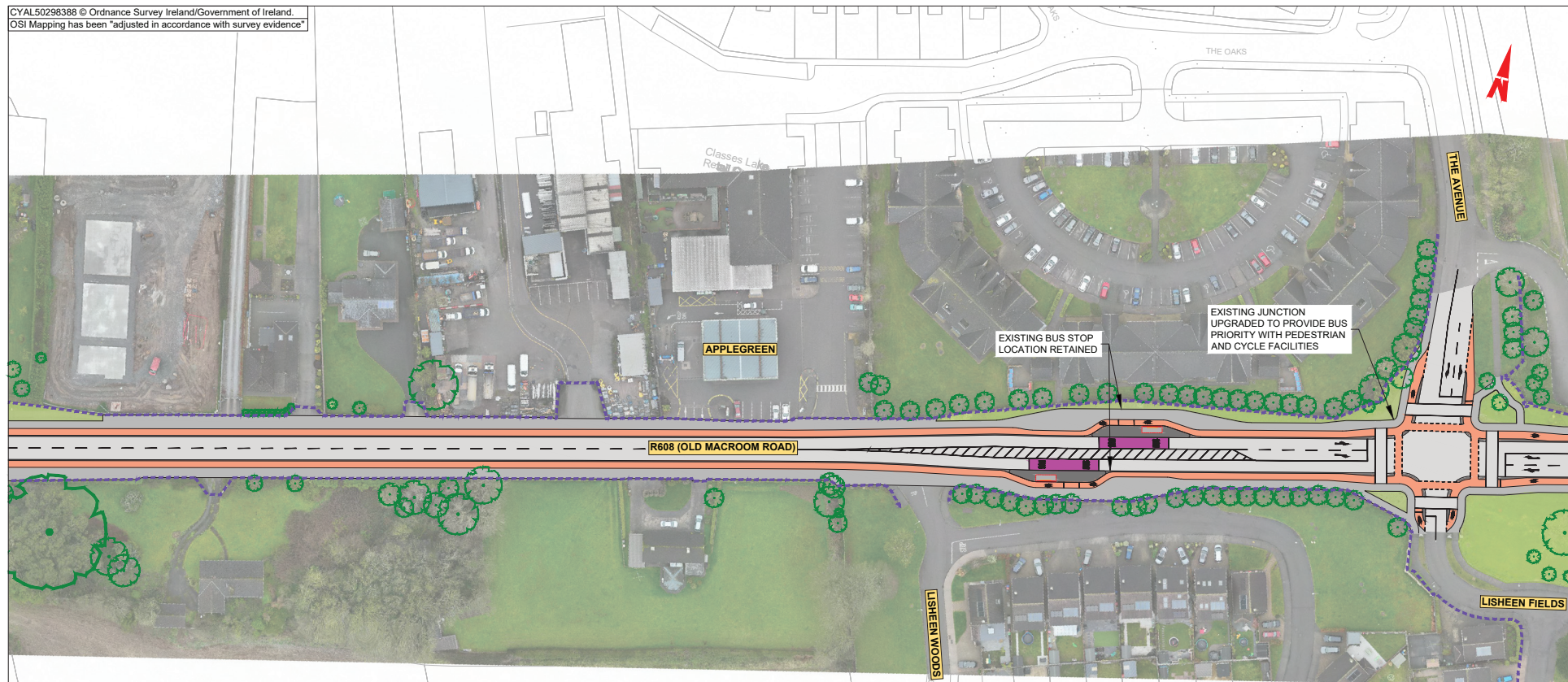

**LEGEND:**

- BUS LANE
- CYCLE TRACK
- FOOTPATH
- CARRIAGEWAY
- GRASS AREA / VERGE
- PEDESTRIAN PRIORITY ZONE
- BUS STOP LOCATIONS
- EXISTING TREE TO BE RETAINED
- EXISTING TREE TO BE REMOVED
- PROPOSED TREES
- EXISTING BOUNDARY
- PROPOSED NEW BOUNDARY (POSSIBLE LAND ACQUISITION)

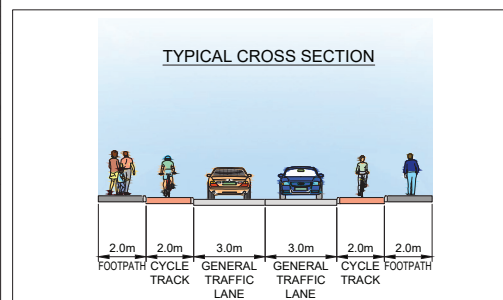
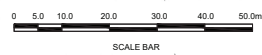

CYAL50298388 © Ordnance Survey Ireland/Government of Ireland.  
OSI Mapping has been "adjusted in accordance with survey evidence"



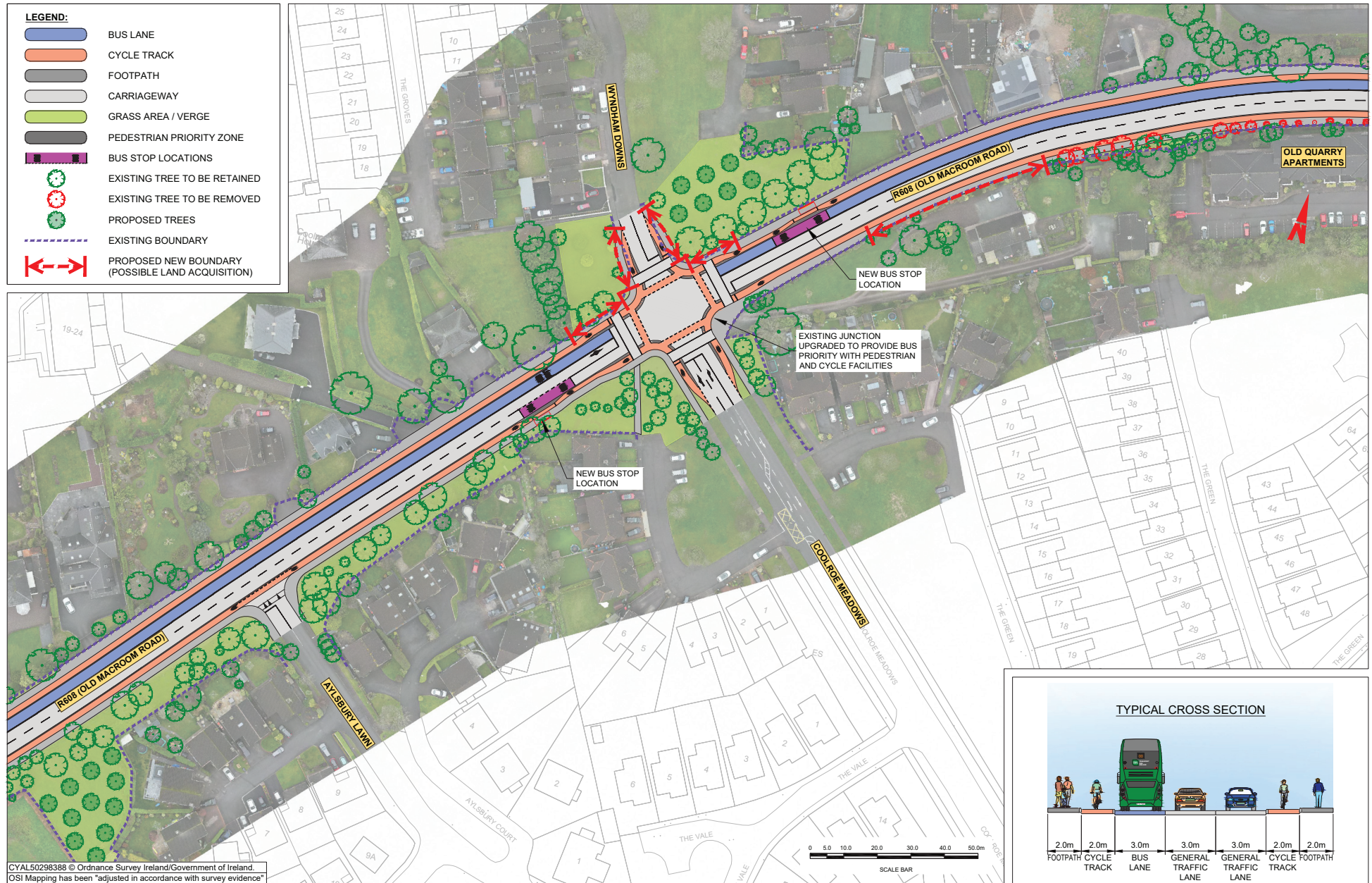

CYAL50298388 © Ordnance Survey Ireland/Government of Ireland.  
OSI Mapping has been "adjusted in accordance with survey evidence"

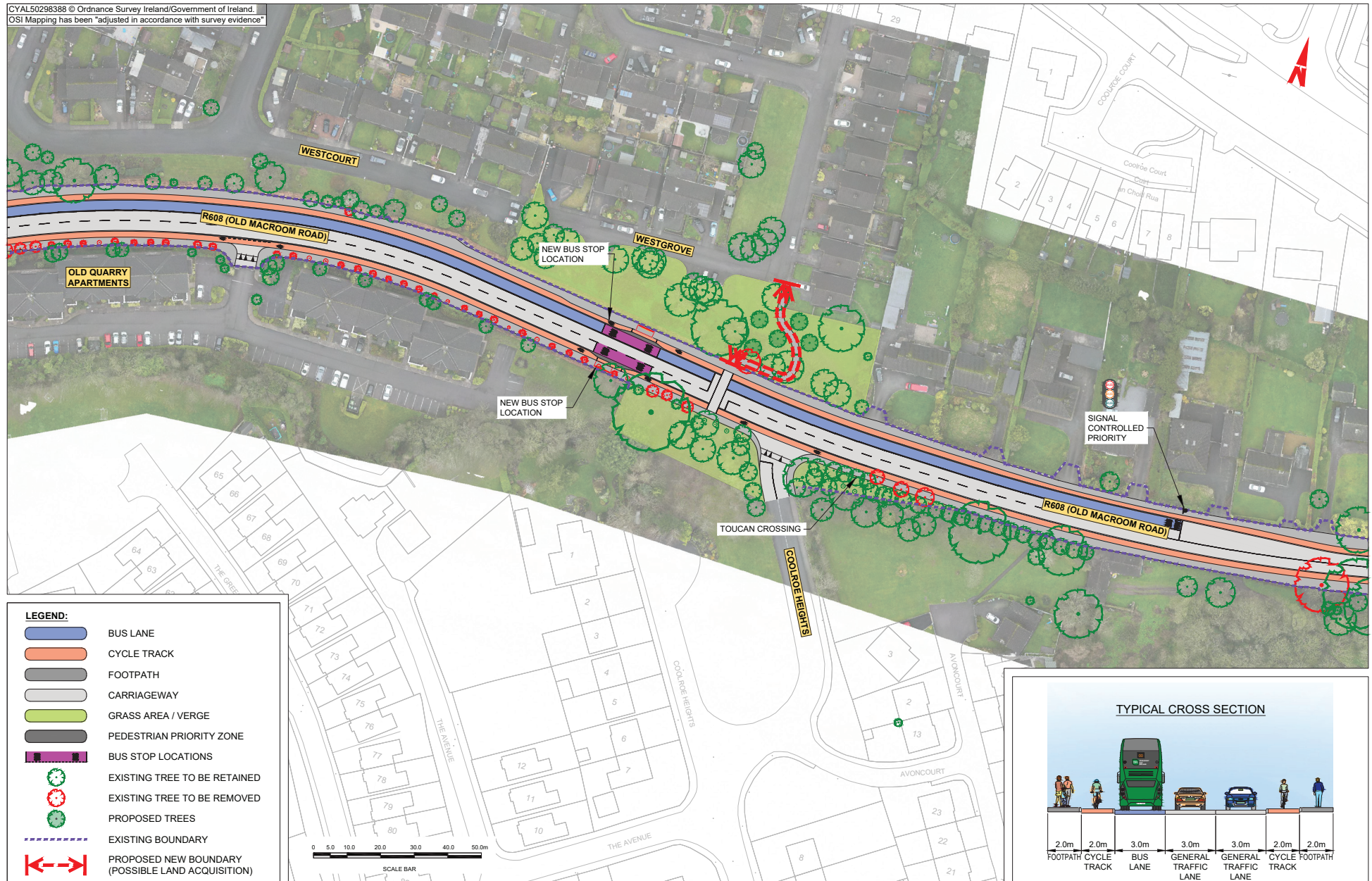



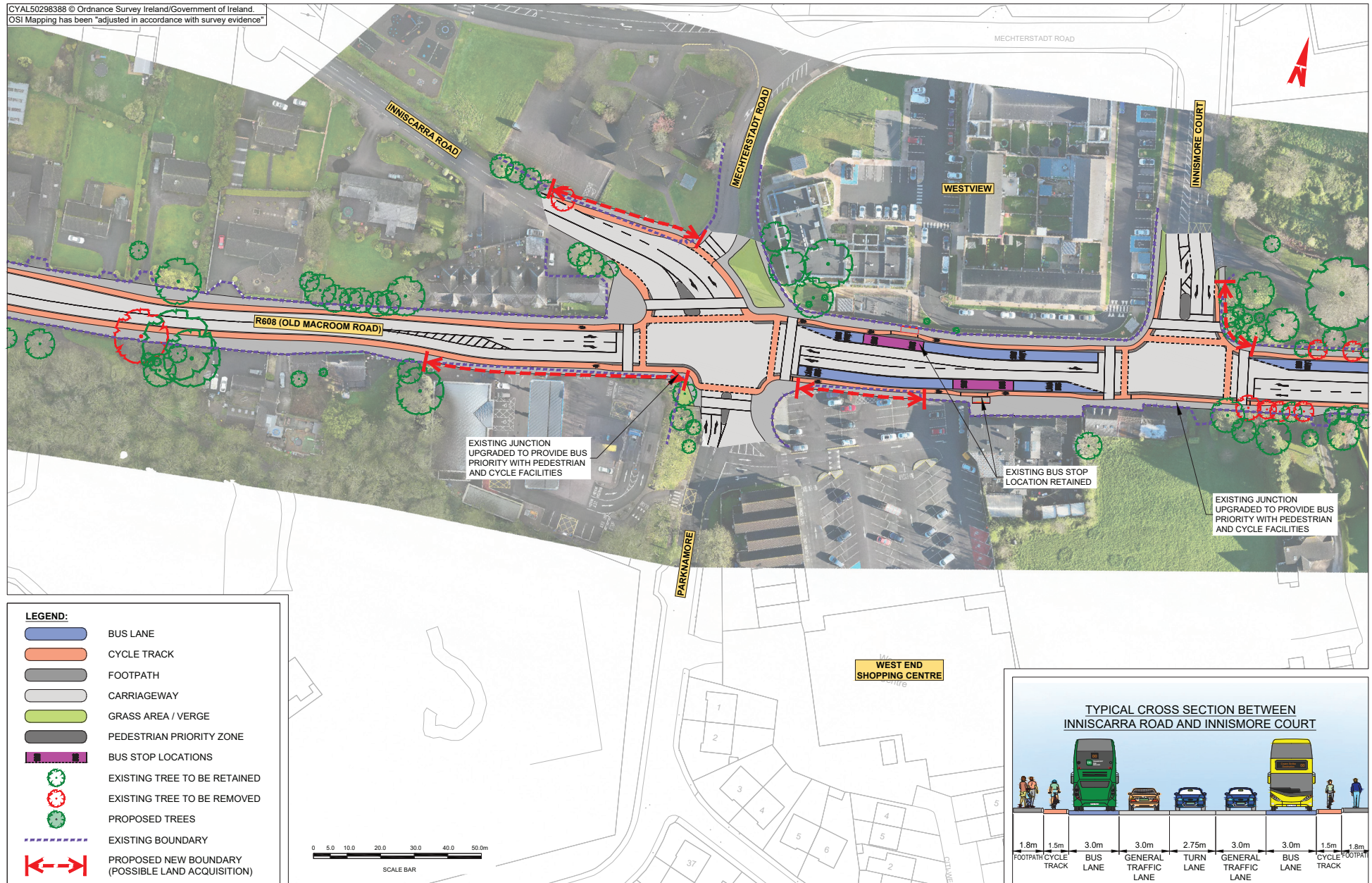













CYAL50298388 © Ordnance Survey Ireland/Government of Ireland.  
OSI Mapping has been "adjusted in accordance with survey evidence"



**LEGEND:**

-  BUS LANE
-  CYCLE TRACK
-  FOOTPATH
-  CARRIAGEWAY
-  GRASS AREA / VERGE
-  PEDESTRIAN PRIORITY ZONE
-  BUS STOP LOCATIONS
-  EXISTING TREE TO BE RETAINED
-  EXISTING TREE TO BE REMOVED
-  PROPOSED TREES
-  EXISTING BOUNDARY
-  PROPOSED NEW BOUNDARY (POSSIBLE LAND ACQUISITION)

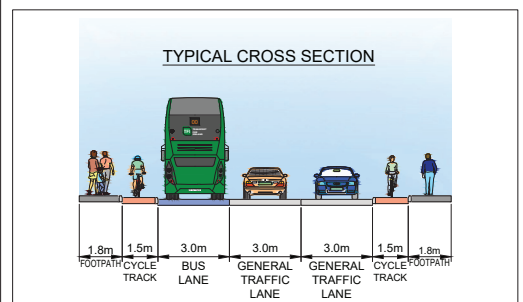
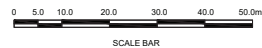

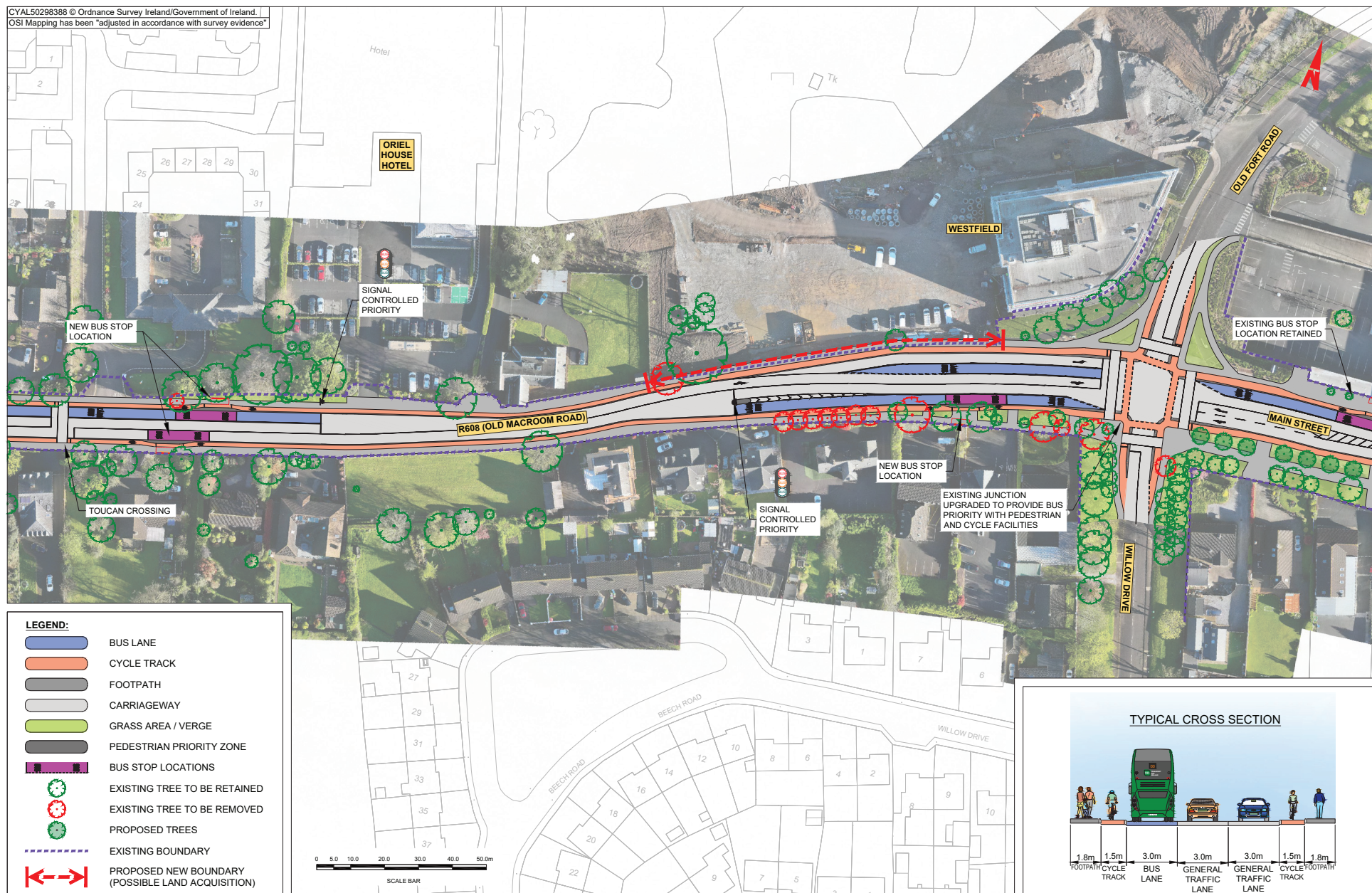













CYAL50298388 © Ordnance Survey Ireland/Government of Ireland.  
OSI Mapping has been "adjusted in accordance with survey evidence"



**LEGEND:**

-  BUS LANE
-  CYCLE TRACK
-  FOOTPATH
-  CARRIAGEWAY
-  GRASS AREA / VERGE
-  PEDESTRIAN PRIORITY ZONE
-  BUS STOP LOCATIONS
-  EXISTING TREE TO BE RETAINED
-  EXISTING TREE TO BE REMOVED
-  PROPOSED TREES
-  EXISTING BOUNDARY
-  PROPOSED NEW BOUNDARY (POSSIBLE LAND ACQUISITION)

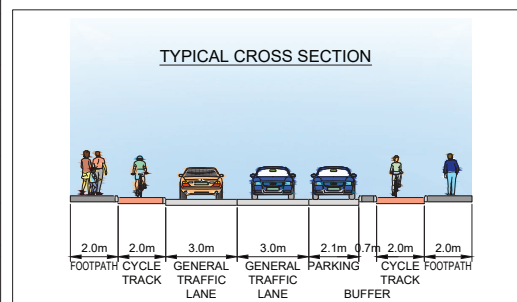
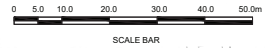

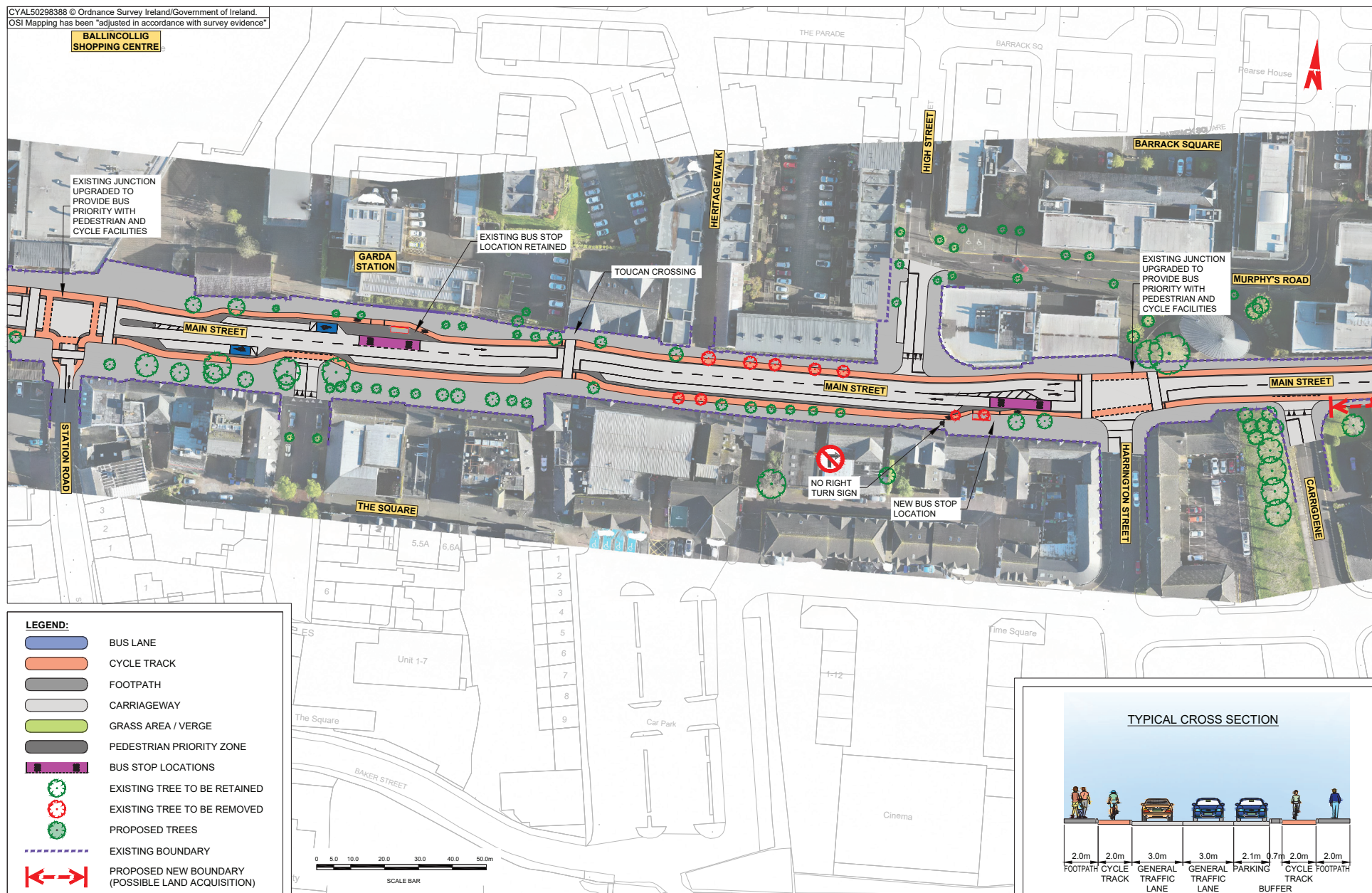

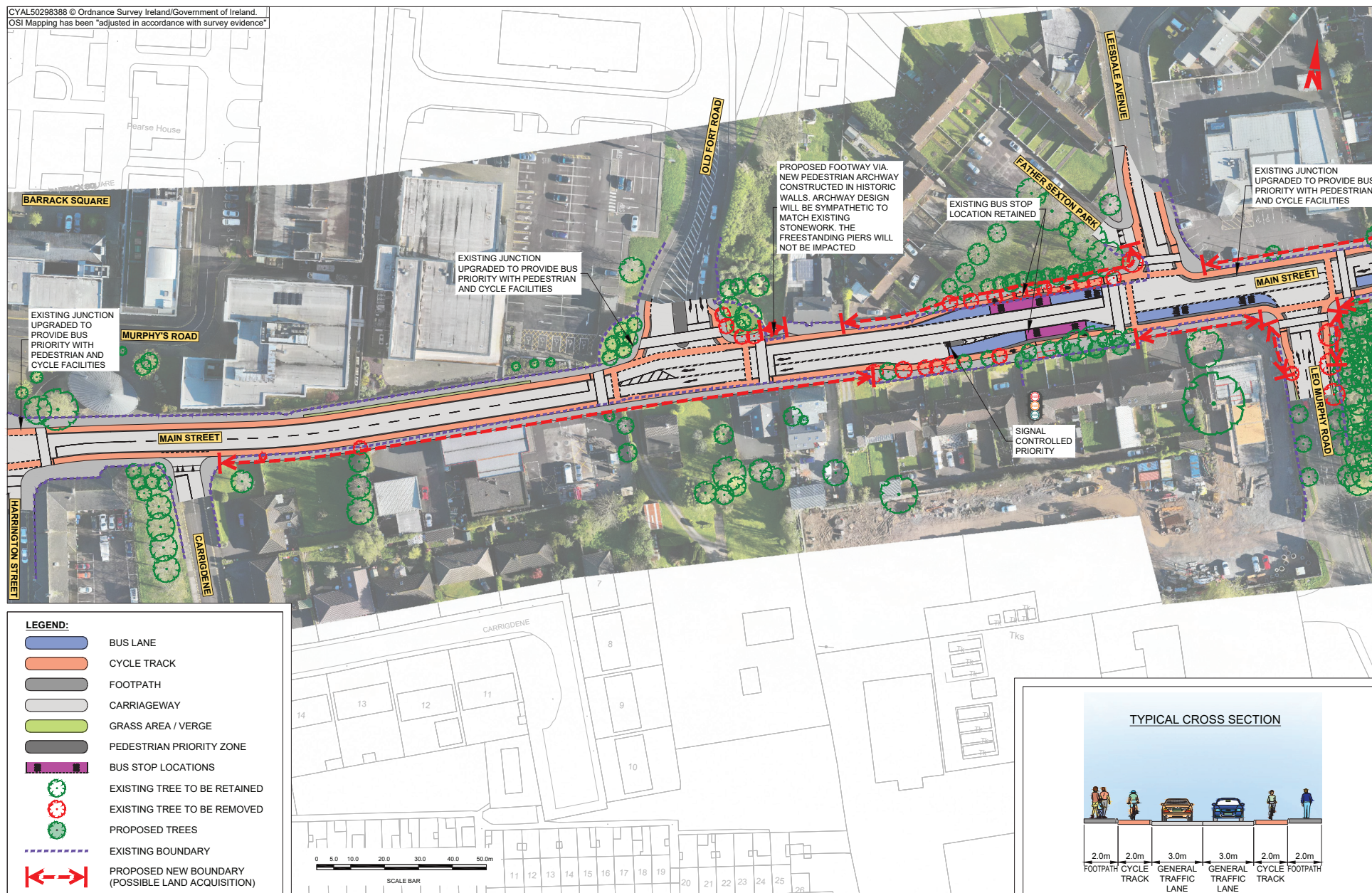













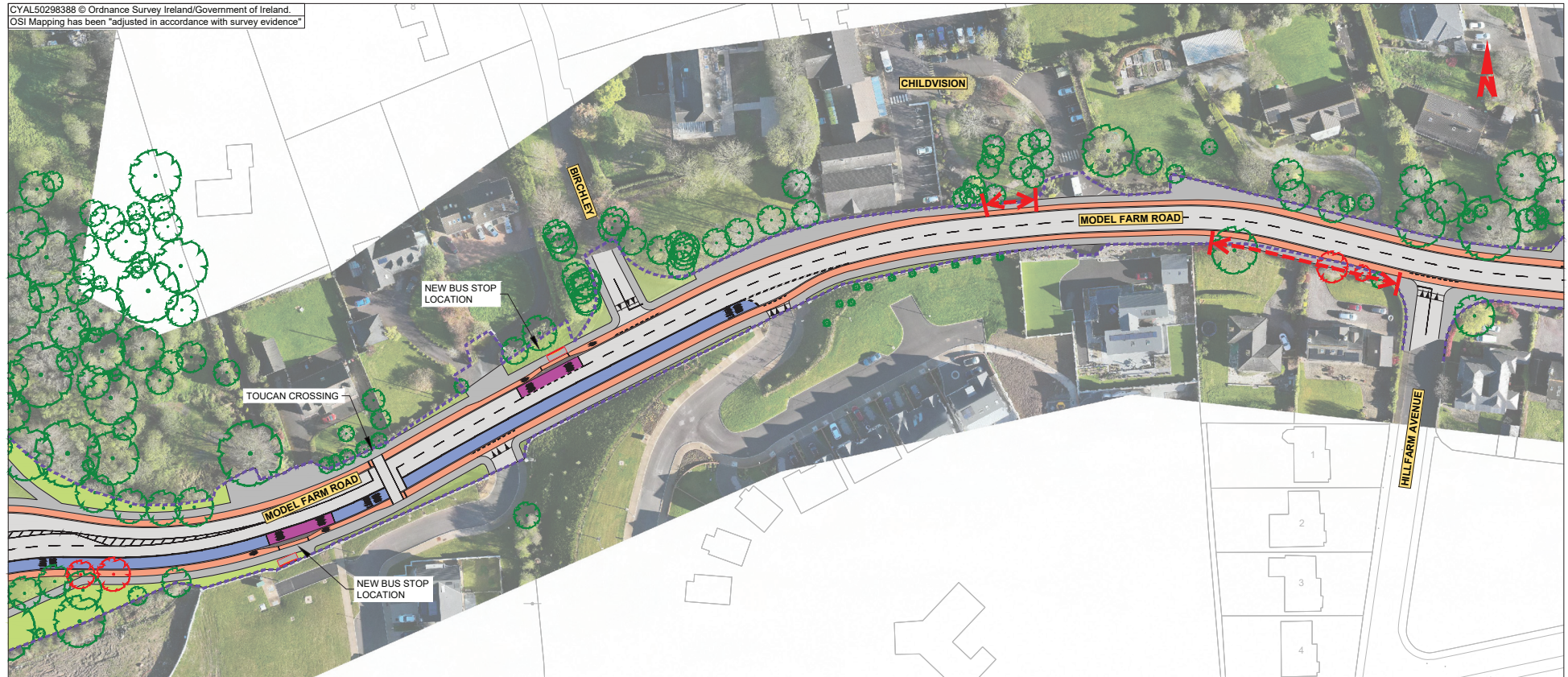





CYAL50298388 © Ordnance Survey Ireland/Government of Ireland.  
OSI Mapping has been "adjusted in accordance with survey evidence"



CYAL50298388 © Ordnance Survey Ireland/Government of Ireland.  
OSI Mapping has been "adjusted in accordance with survey evidence"



**LEGEND:**

-  BUS LANE
-  CYCLE TRACK
-  FOOTPATH
-  CARRIAGEWAY
-  GRASS AREA / VERGE
-  PEDESTRIAN PRIORITY ZONE
-  BUS STOP LOCATIONS
-  EXISTING TREE TO BE RETAINED
-  EXISTING TREE TO BE REMOVED
-  PROPOSED TREES
-  EXISTING BOUNDARY
-  PROPOSED NEW BOUNDARY (POSSIBLE LAND ACQUISITION)

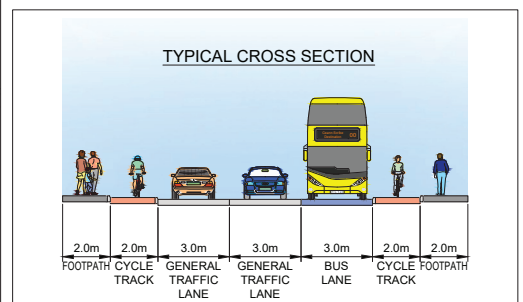
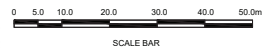

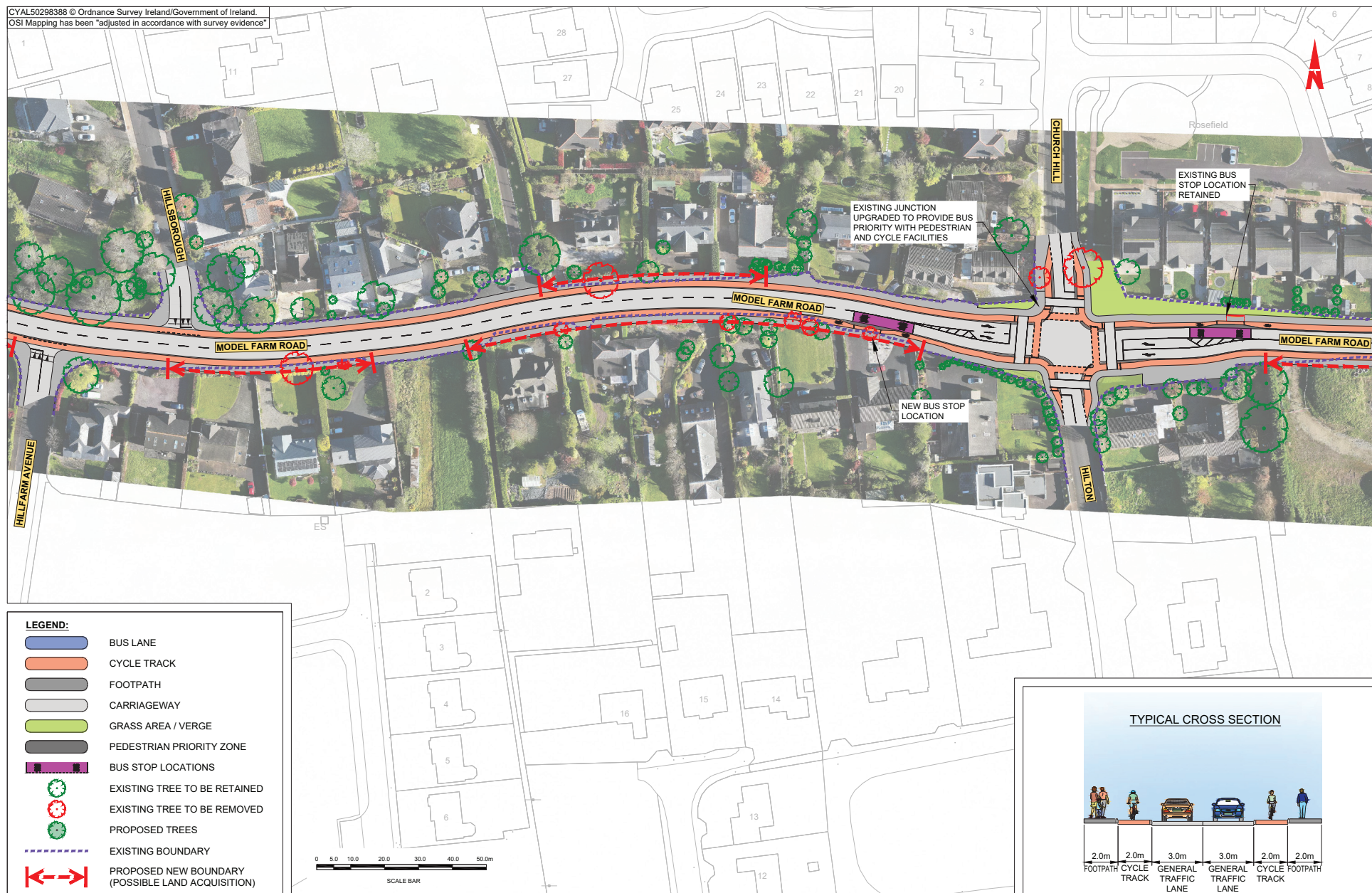















CYAL50298388 © Ordnance Survey Ireland/Government of Ireland.  
OSI Mapping has been "adjusted in accordance with survey evidence"



**LEGEND:**

-  BUS LANE
-  CYCLE TRACK
-  FOOTPATH
-  CARRIAGEWAY
-  GRASS AREA / VERGE
-  PEDESTRIAN PRIORITY ZONE
-  BUS STOP LOCATIONS
-  EXISTING TREE TO BE RETAINED
-  EXISTING TREE TO BE REMOVED
-  PROPOSED TREES
-  EXISTING BOUNDARY
-  PROPOSED NEW BOUNDARY (POSSIBLE LAND ACQUISITION)

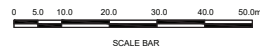

**TYPICAL CROSS SECTION**

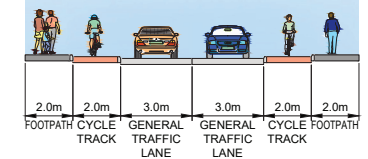

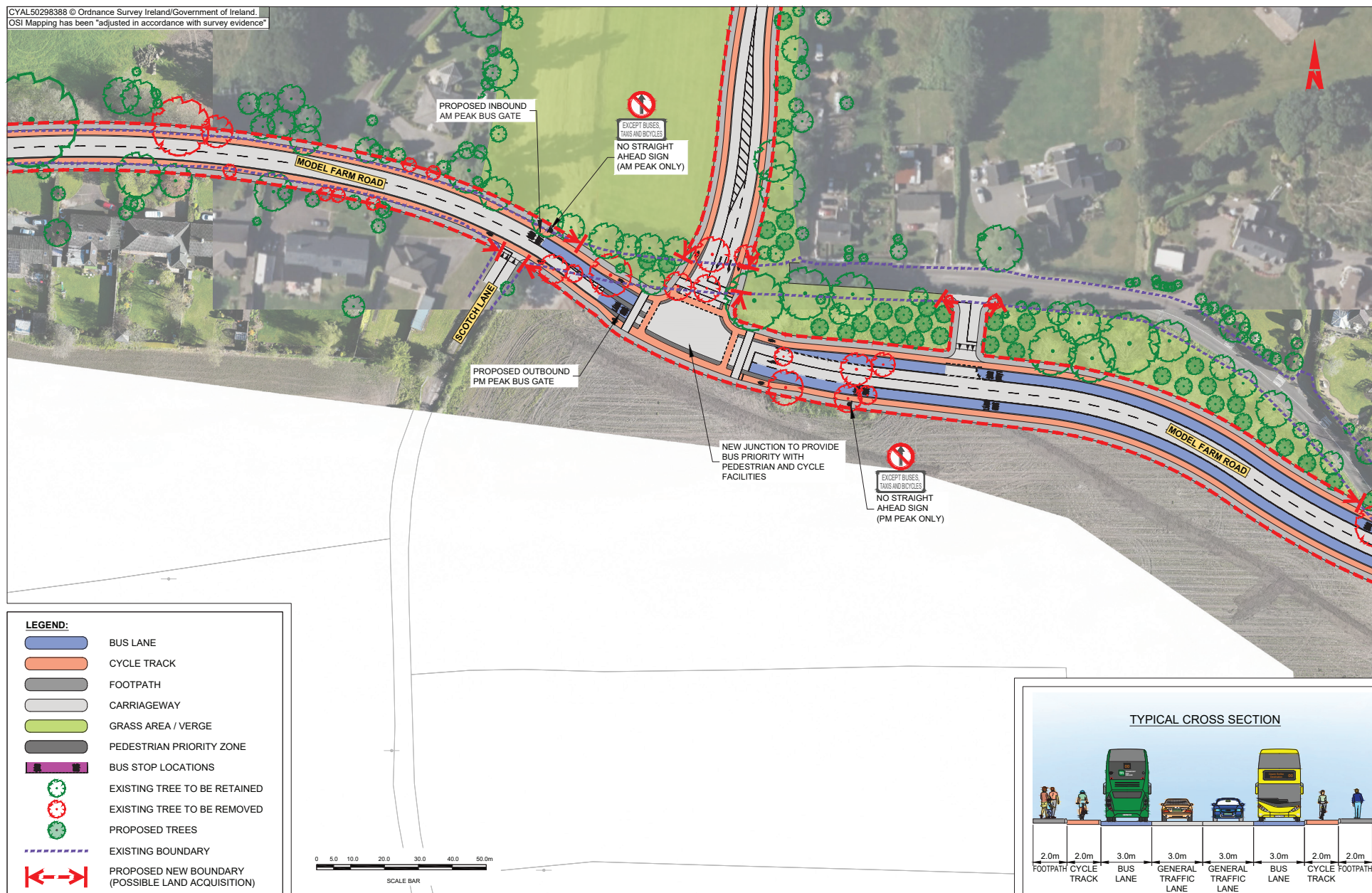

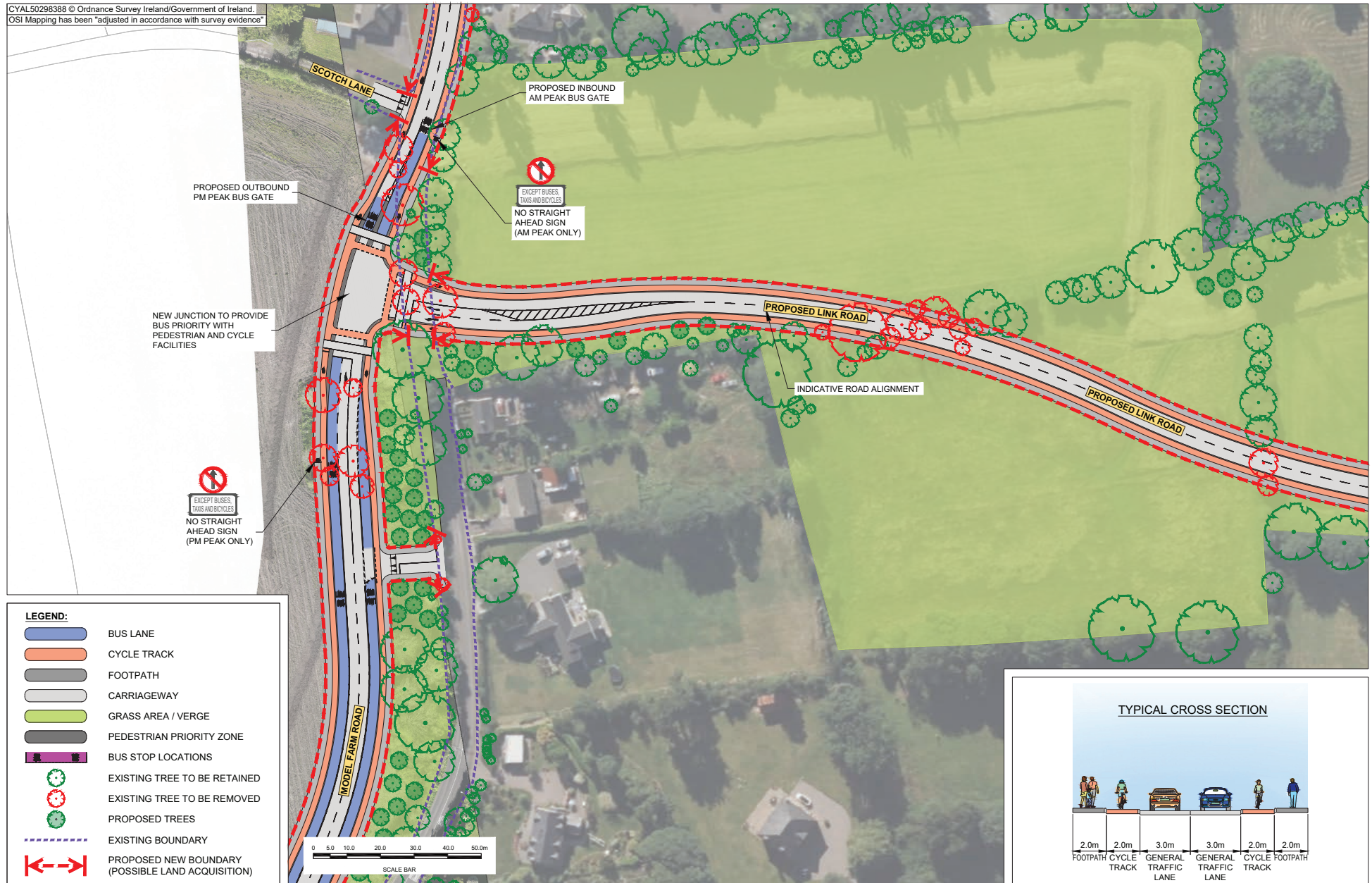





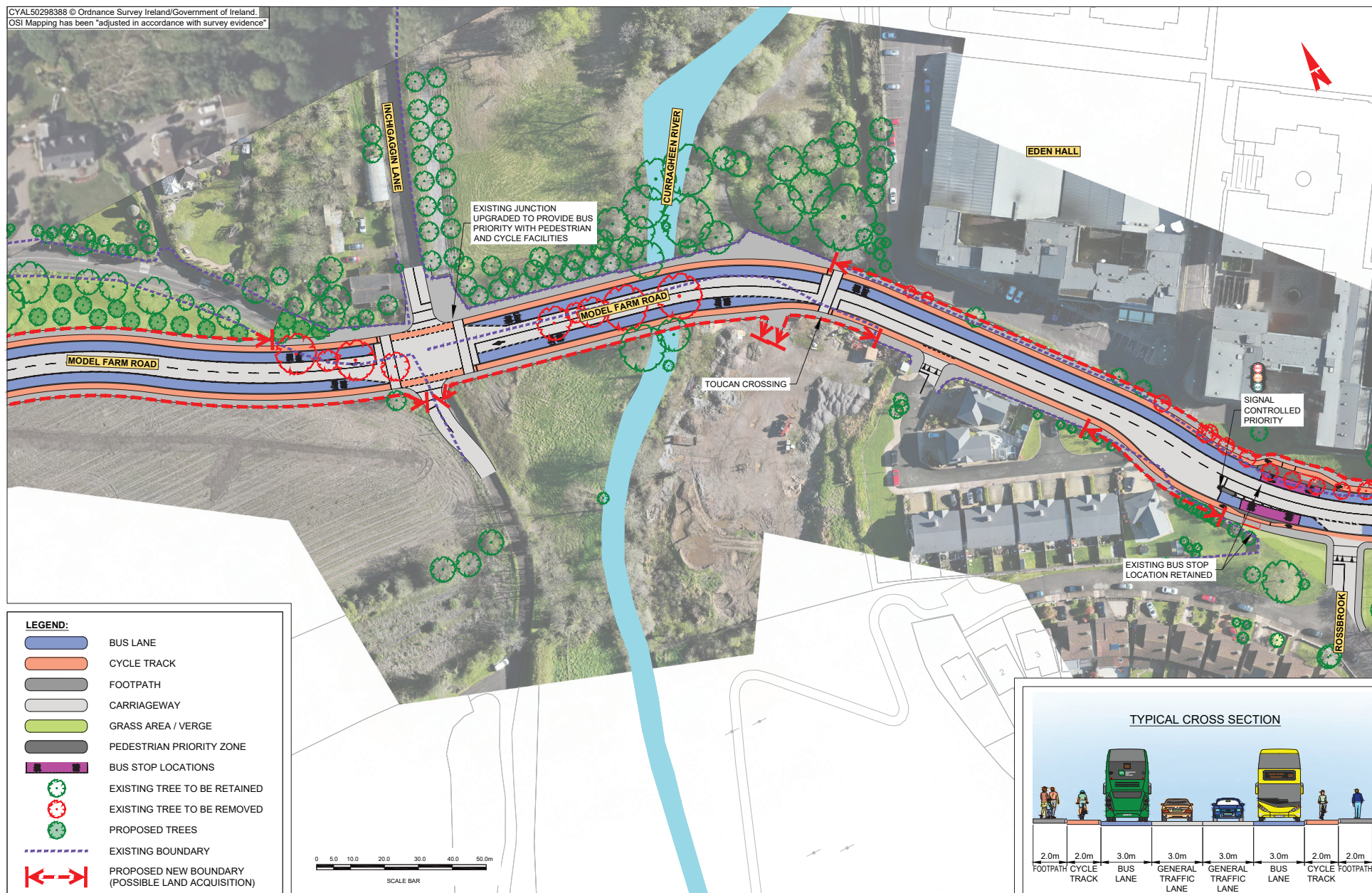

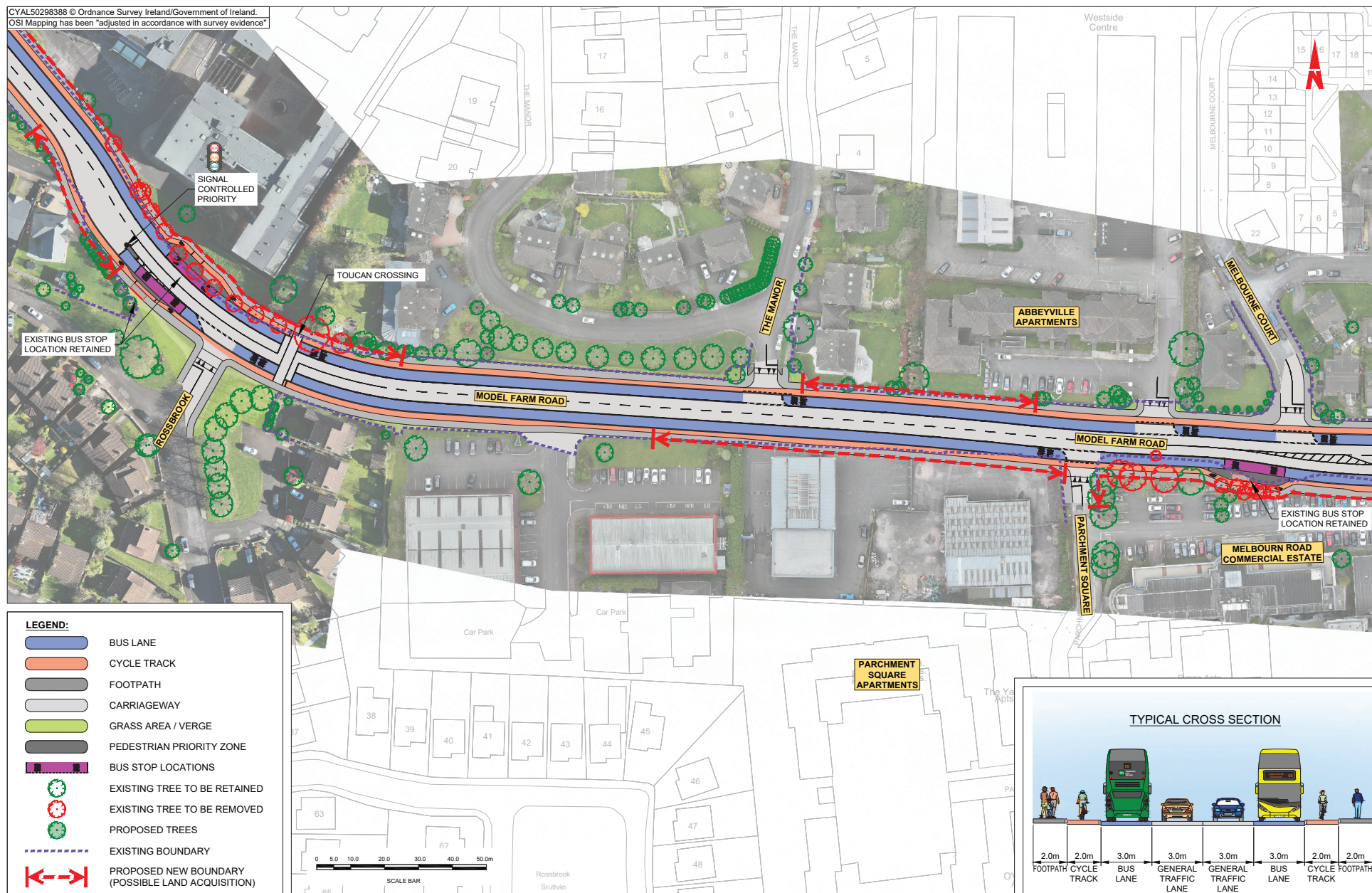

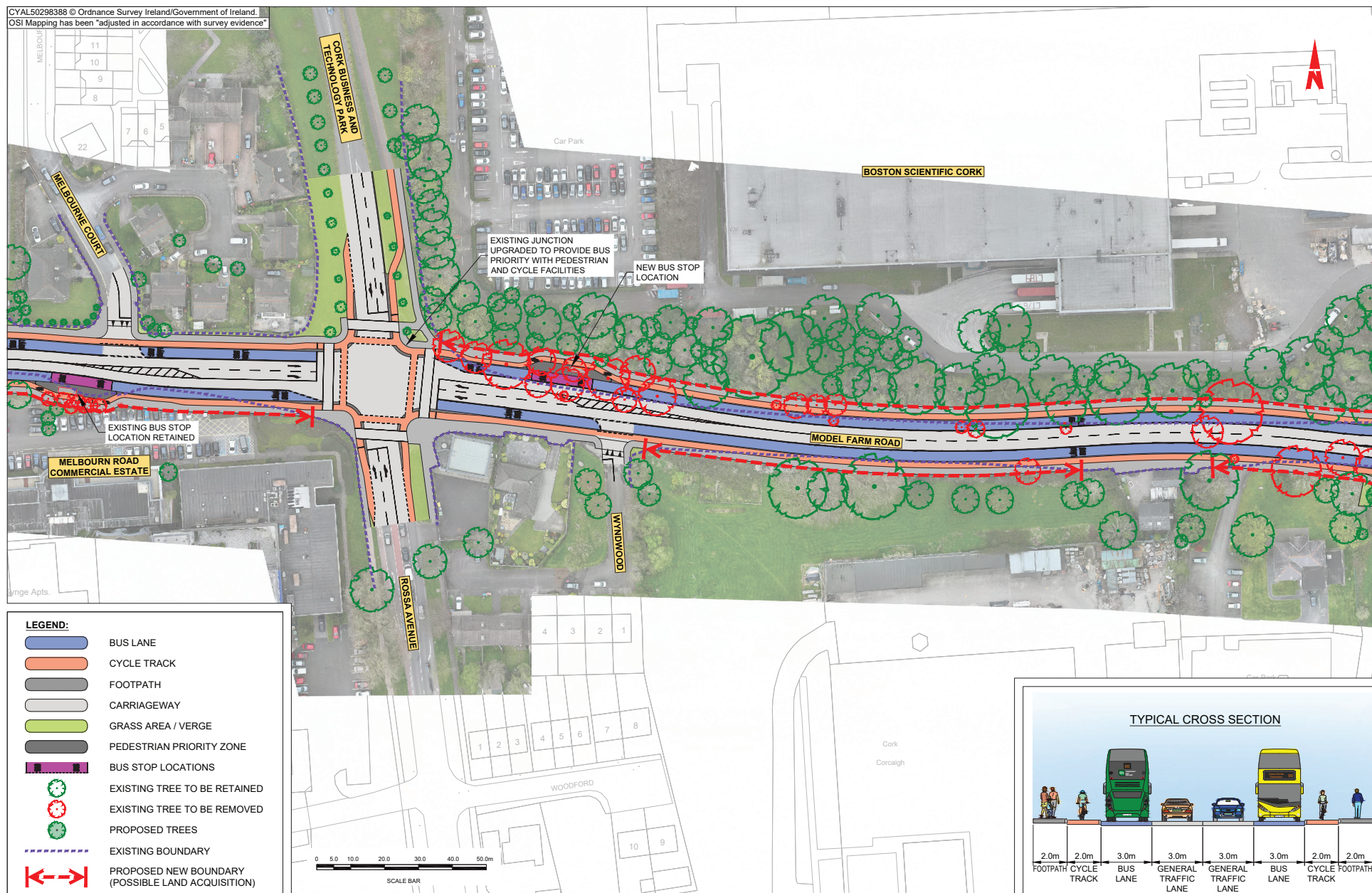

CYAL50298388 © Ordnance Survey Ireland/Government of Ireland.  
OSI Mapping has been "adjusted in accordance with survey evidence"

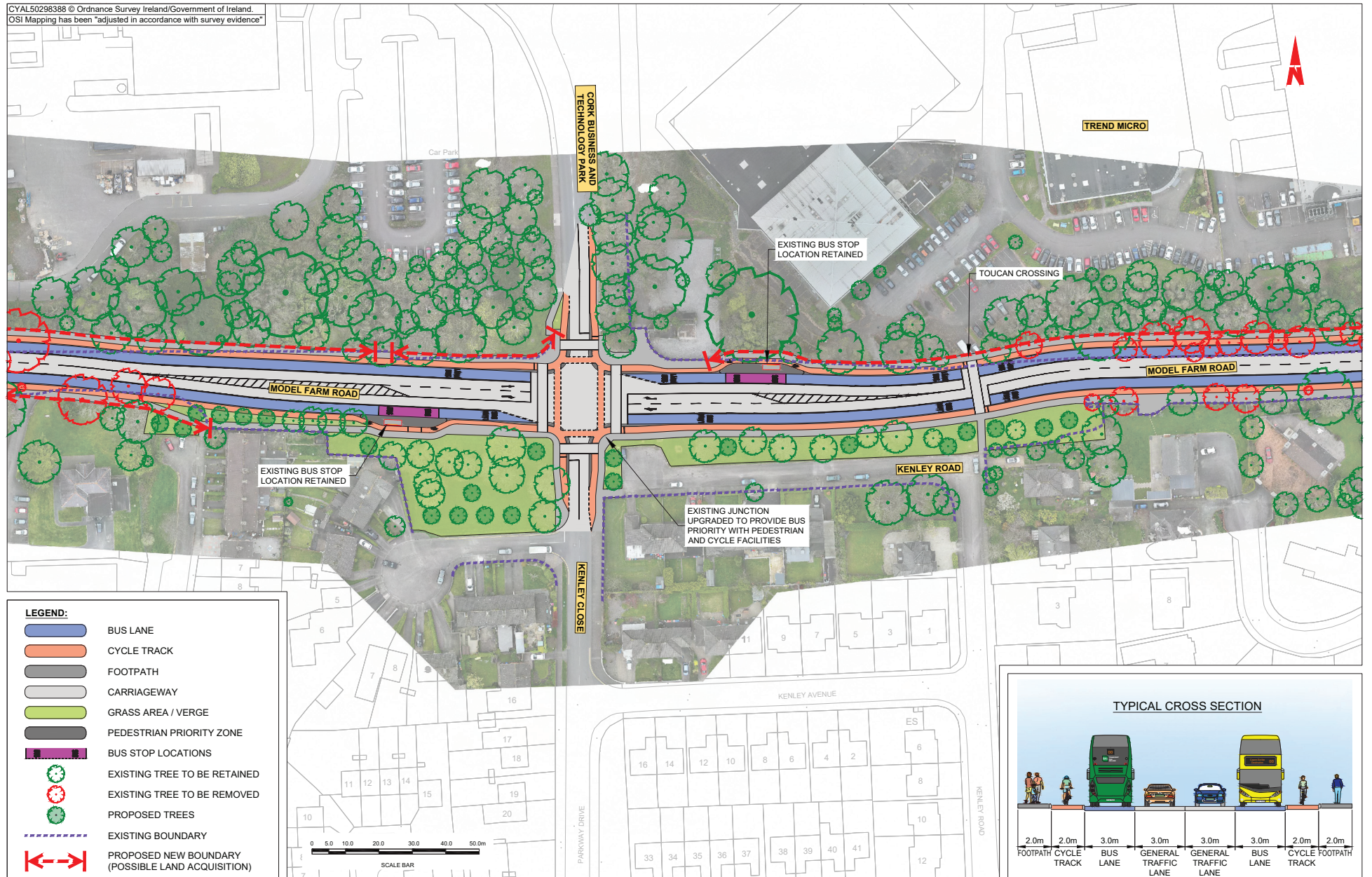

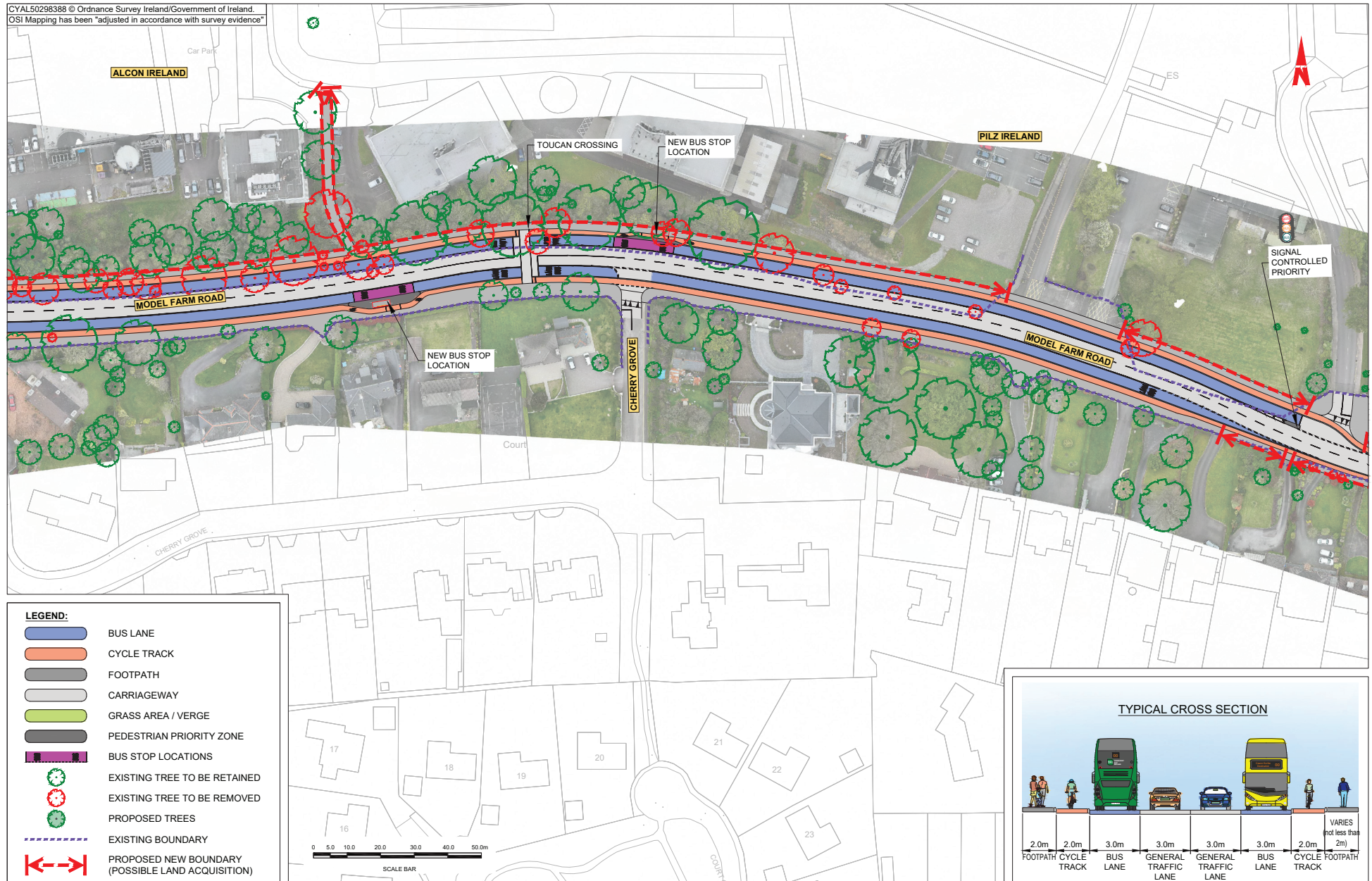



CYAL50298388 © Ordnance Survey Ireland/Government of Ireland.  
OSI Mapping has been "adjusted in accordance with survey evidence"

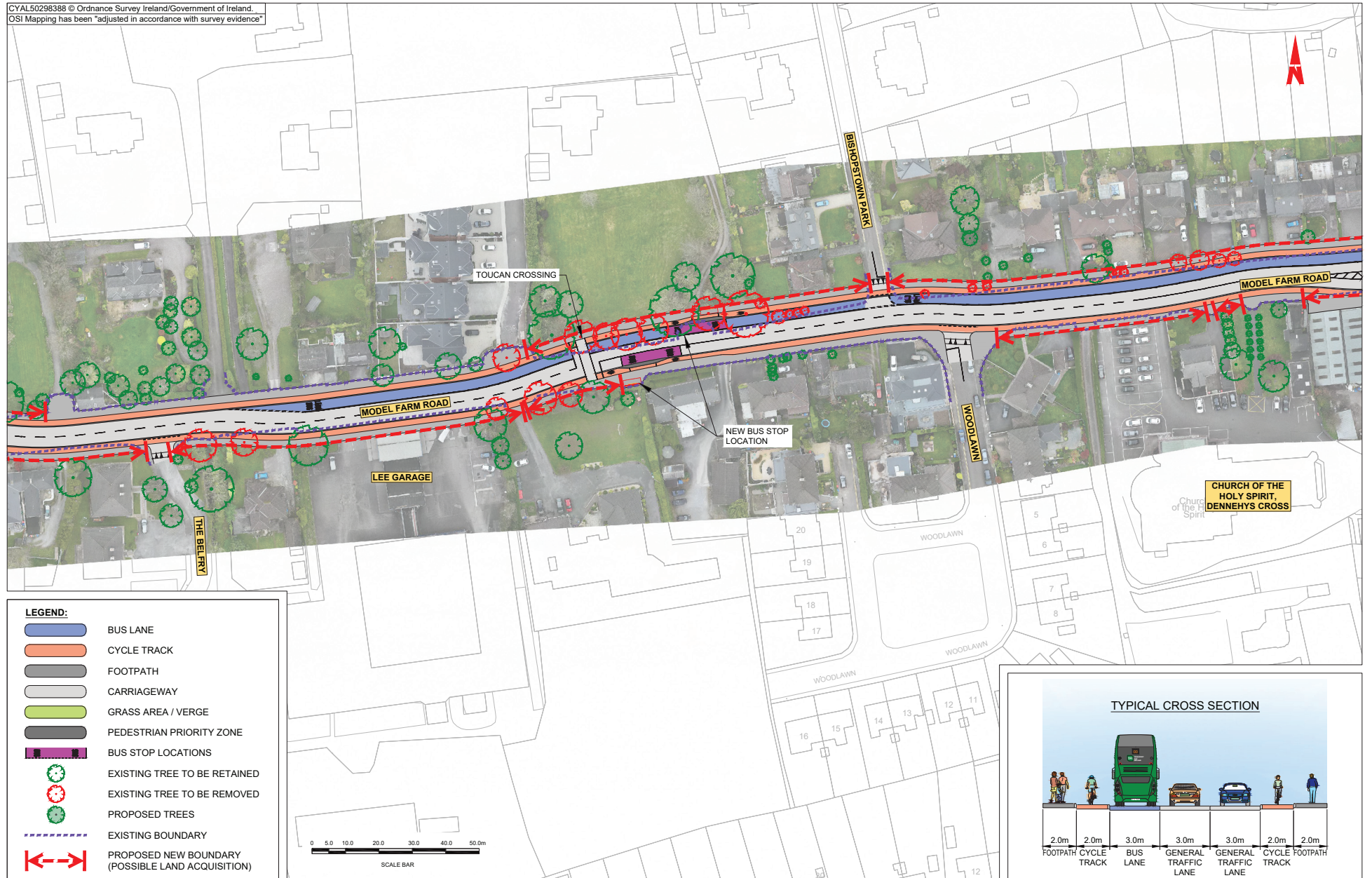

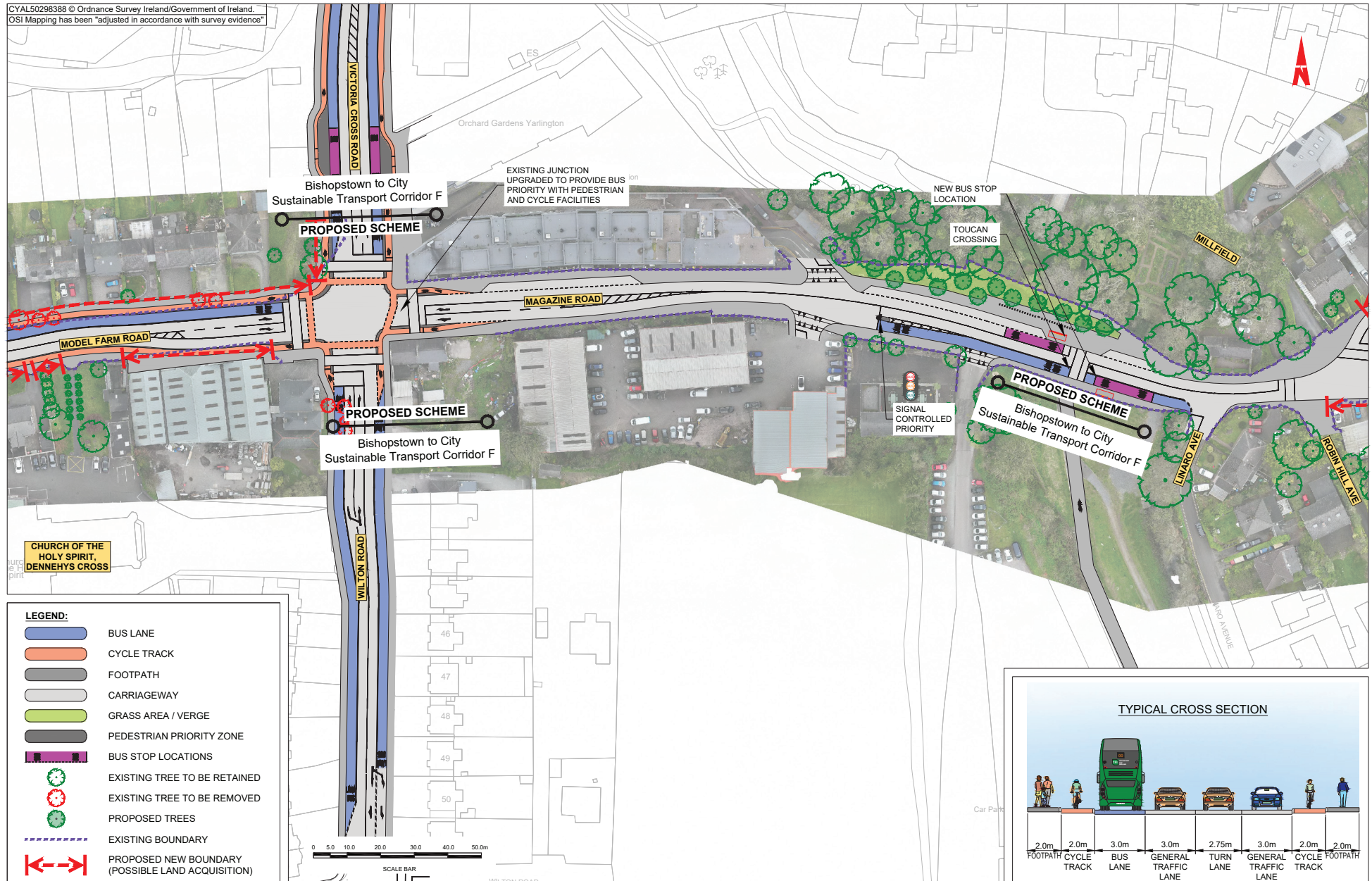



CYAL50298388 © Ordnance Survey Ireland/Government of Ireland.  
OSI Mapping has been "adjusted in accordance with survey evidence"

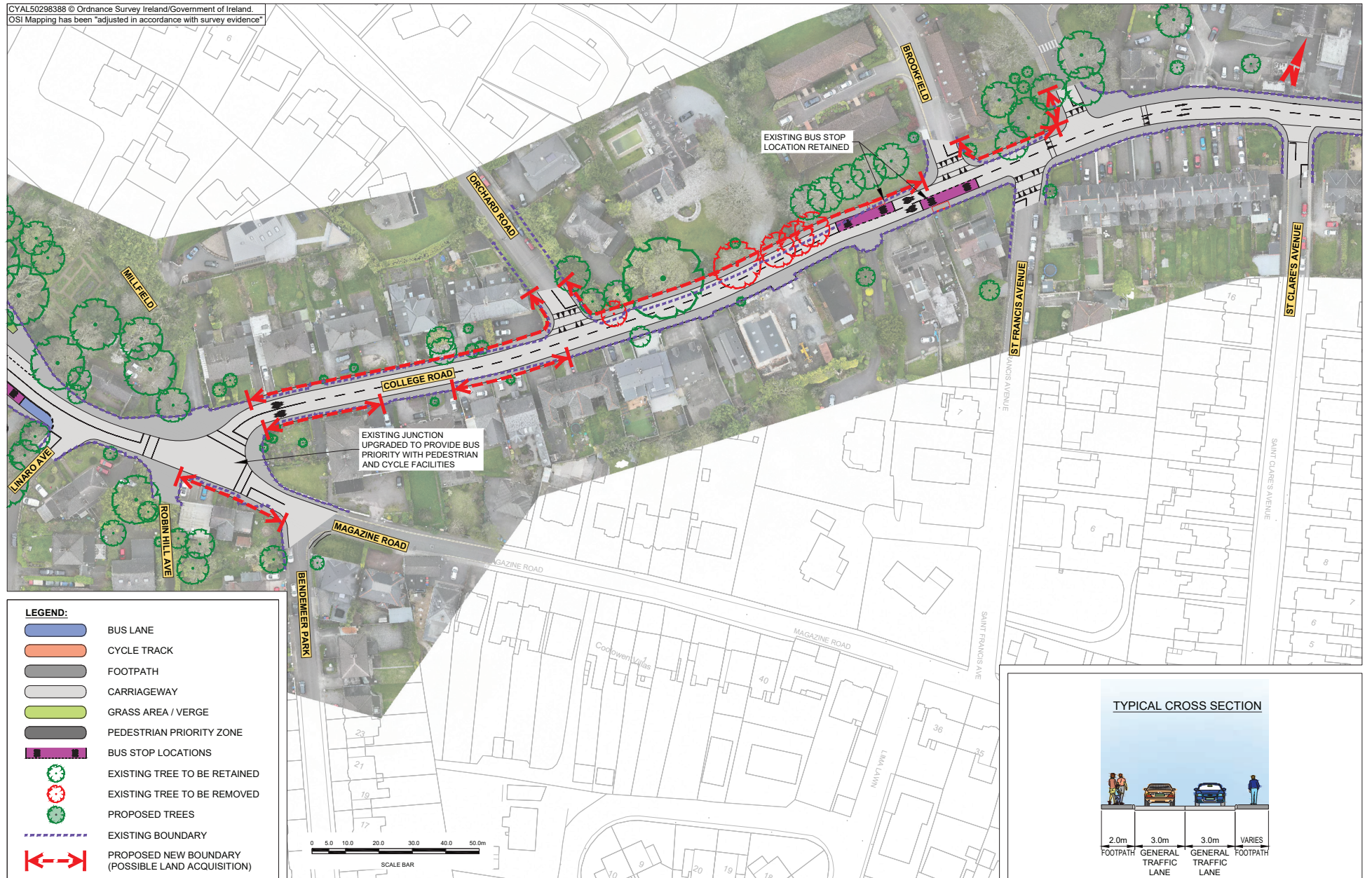

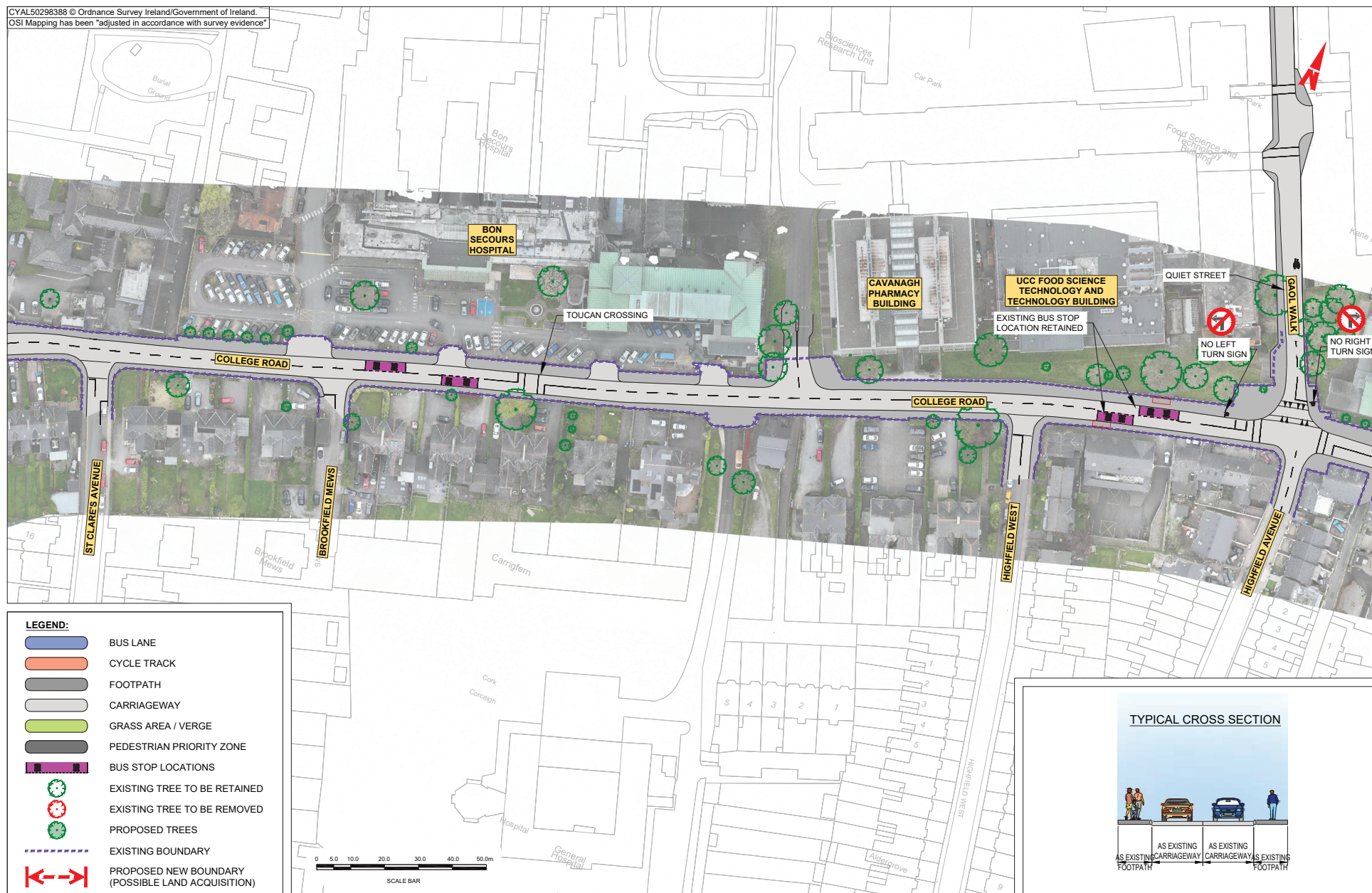

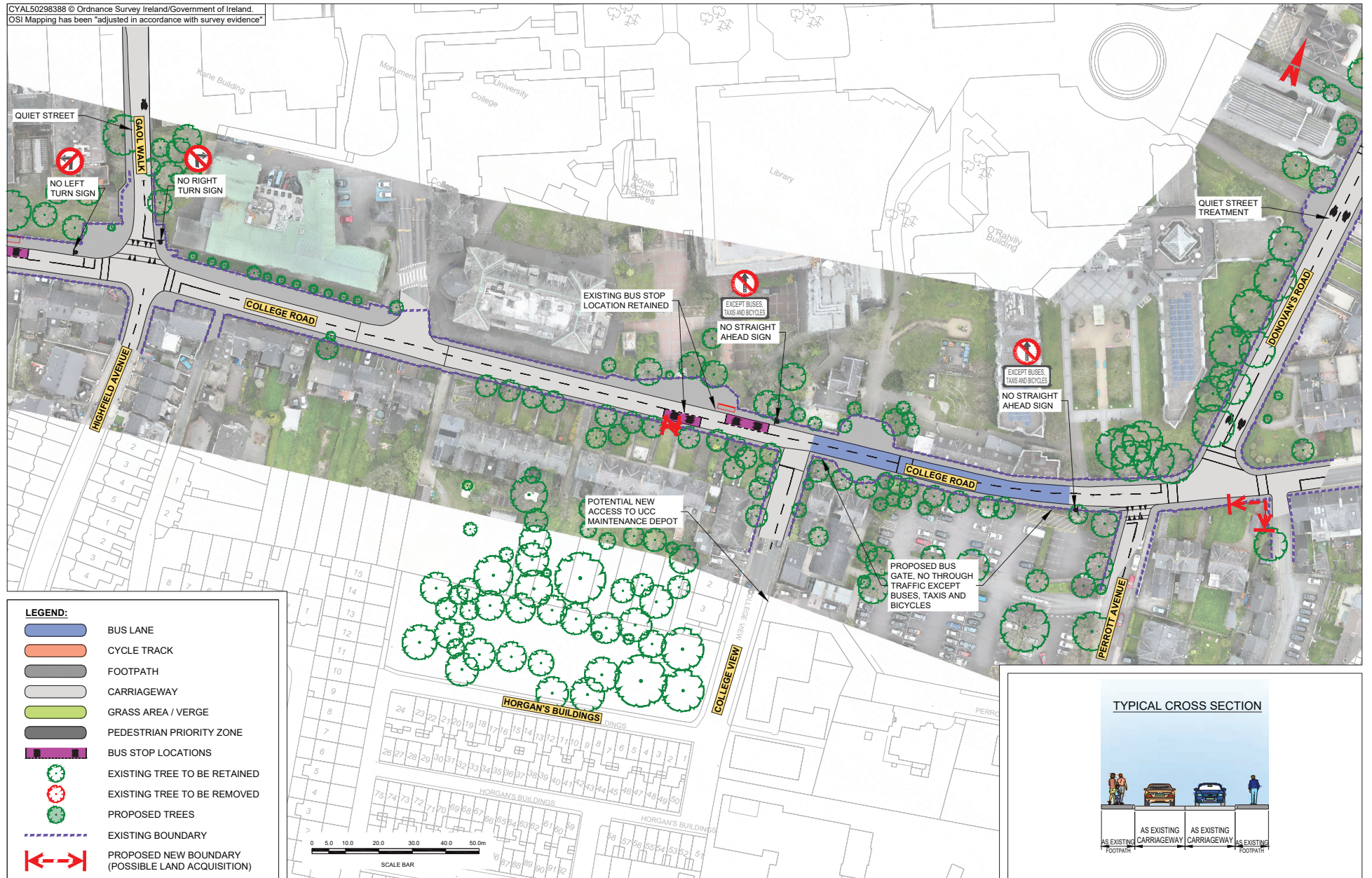

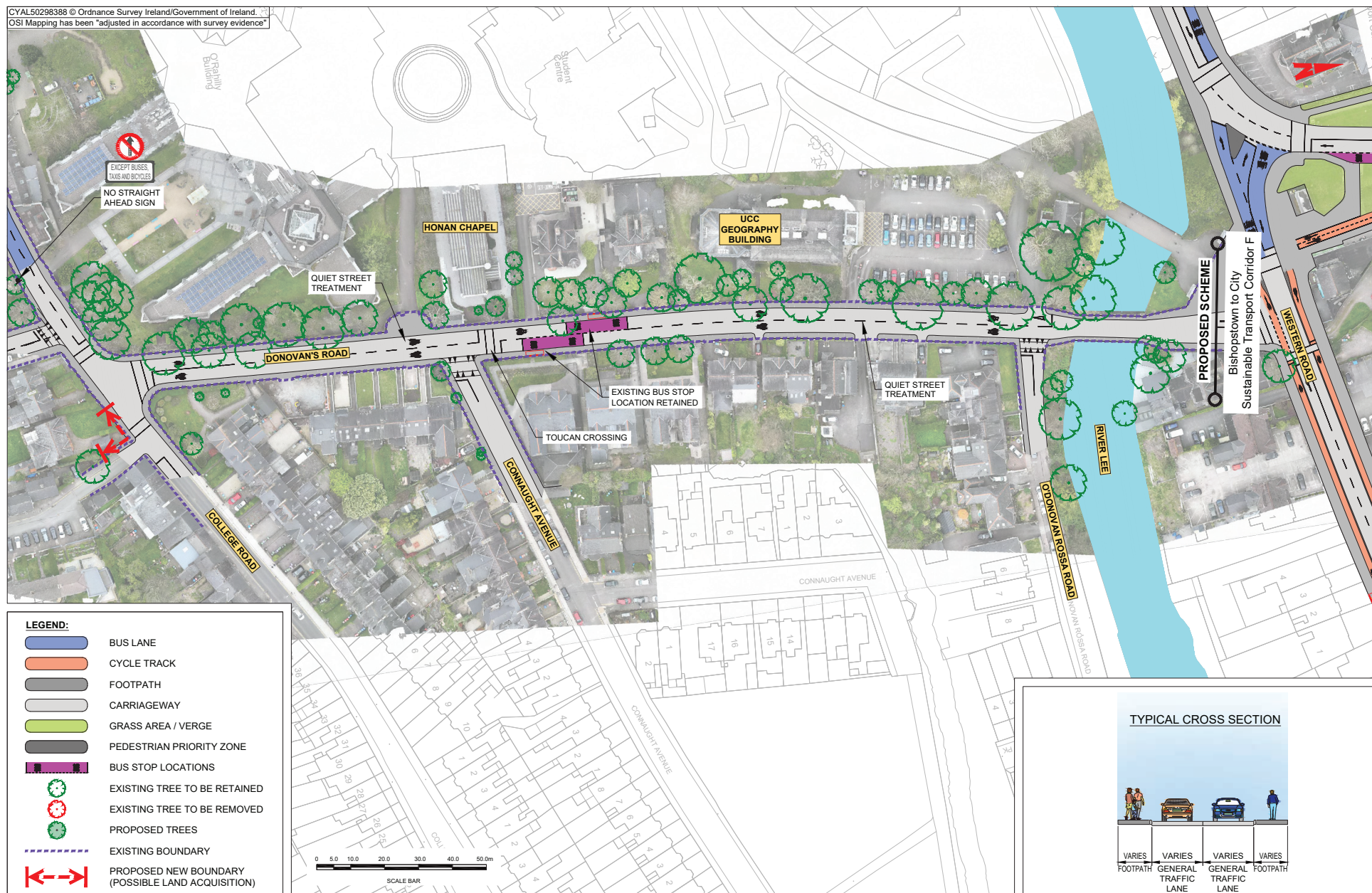



**Údarás Náisiúnta Iompair**  
National Transport Authority

National Transport Authority  
Harcourt Lane,  
Dun Sceine,  
Dublin 2,  
D02 WT20.

NTA - Cork Office  
Suite 427  
1 Horgan's Quay, Waterfront Square,  
Cork  
T23 PPT8



Riailtas  
na hÉireann  
Government  
of Ireland

Tionscadal Éireat  
Project Ireland  
**2040**