



Mahon to City
Sustainable Transport Corridor
Preferred Route

3rd Round of Public Consultation November 2023



Rialtas
na hÉireann
Government
of Ireland

Tionscadal Éireann
Project Ireland
2040

**BUS
CONNECTS
CORK**
SUSTAINABLE TRANSPORT FOR A BETTER CITY.

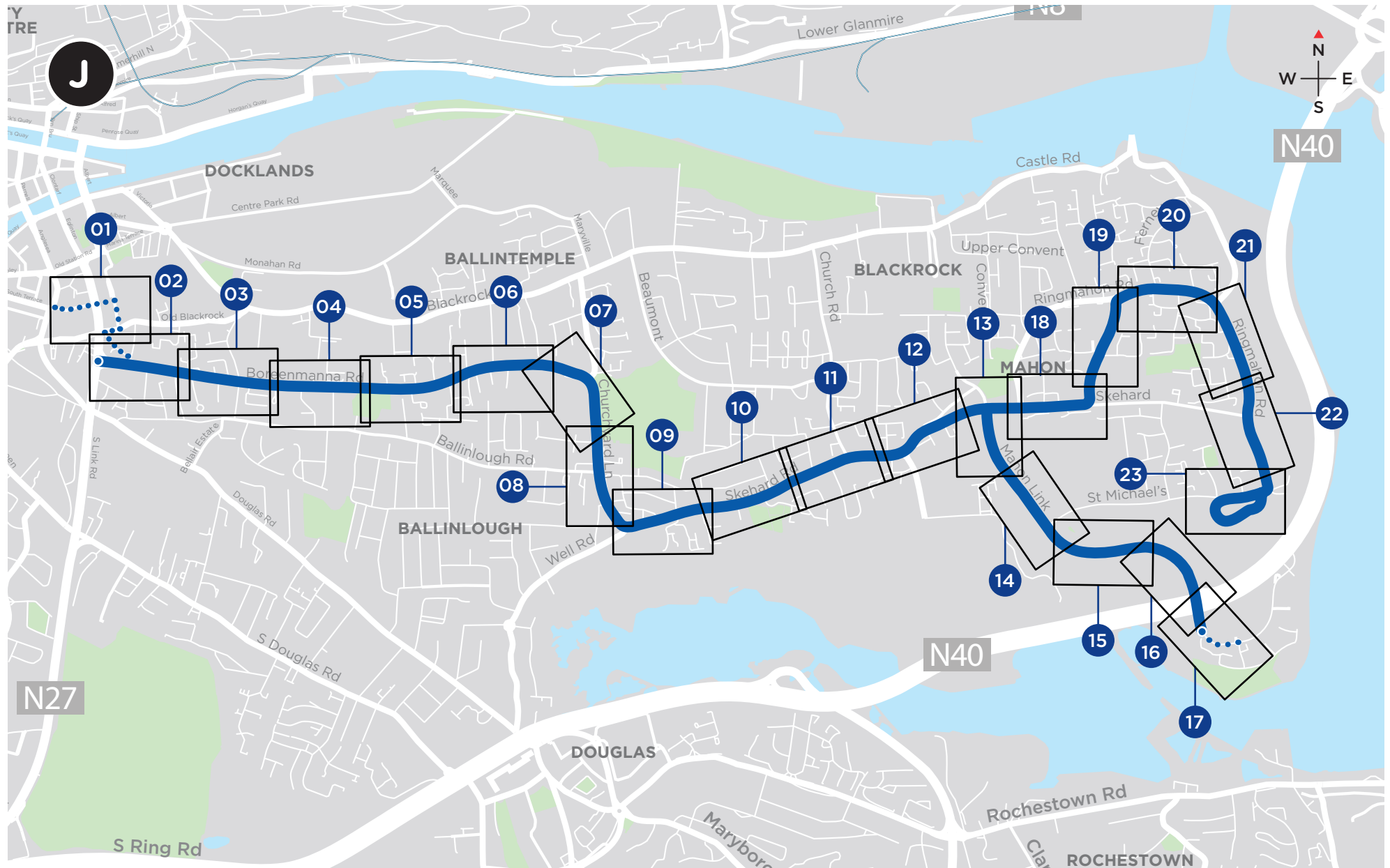

NOTE: The Preferred Route shown on the following drawings is indicative only and is subject to change following consultation and as part of the design development process.

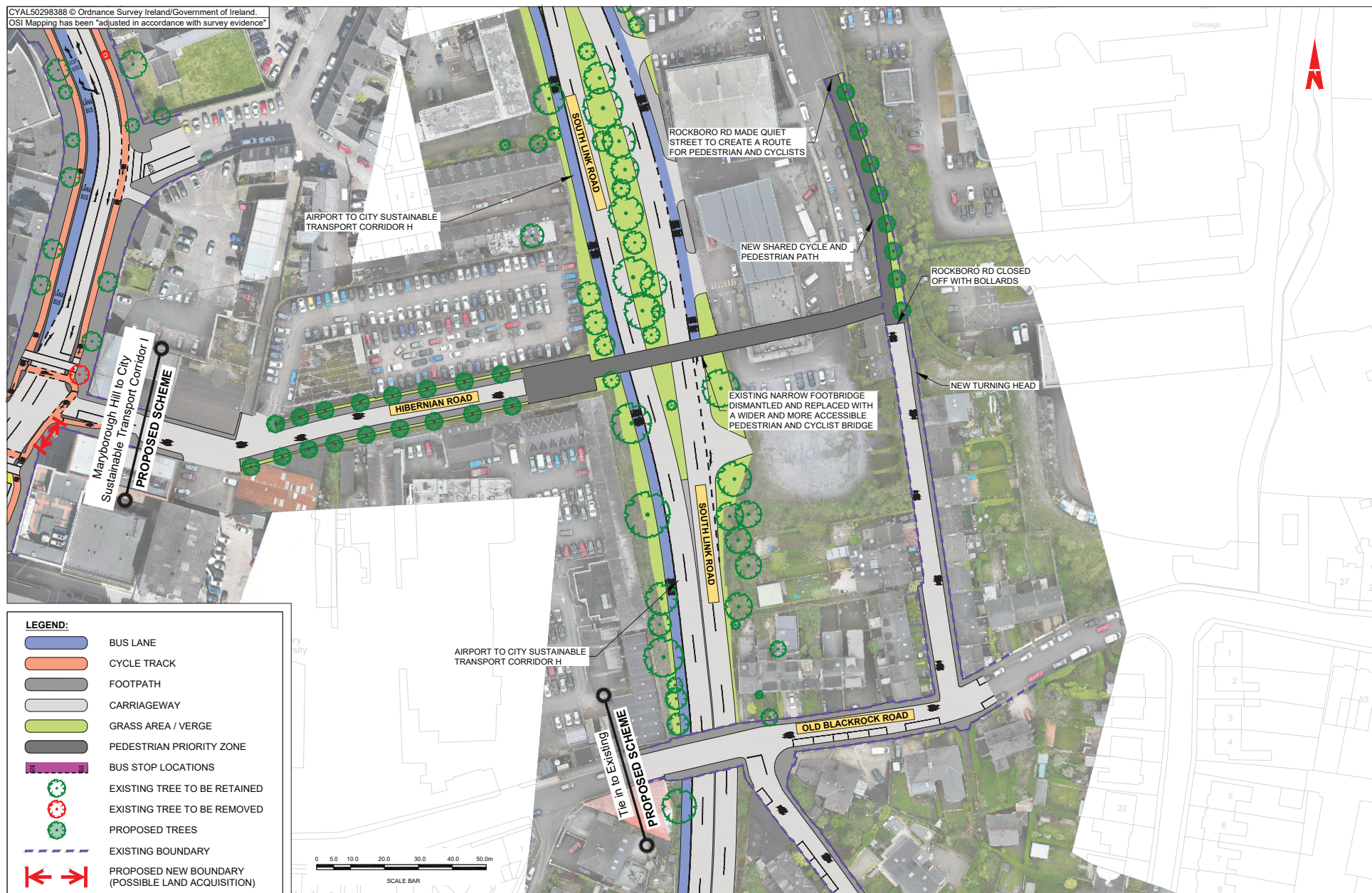

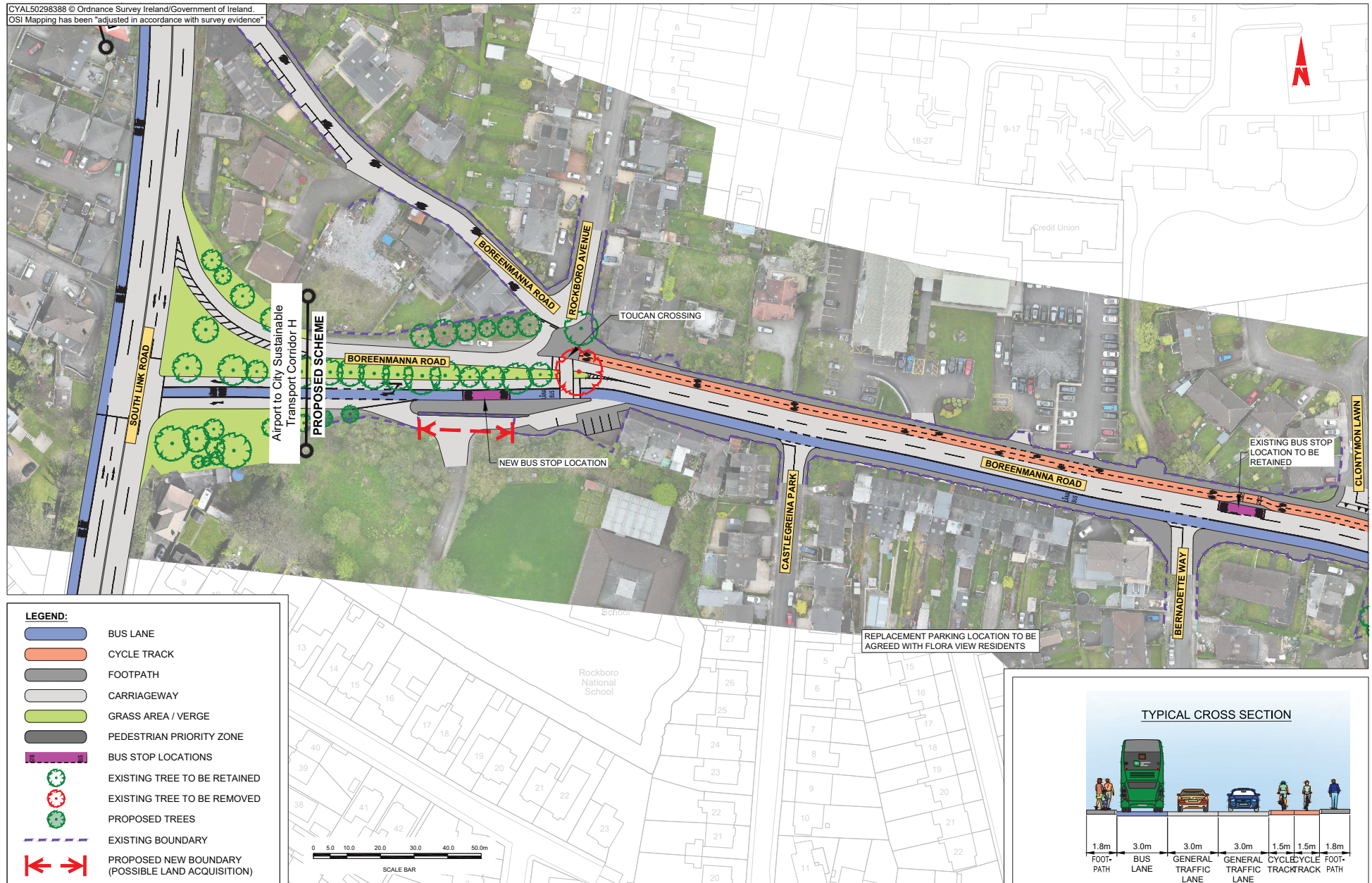

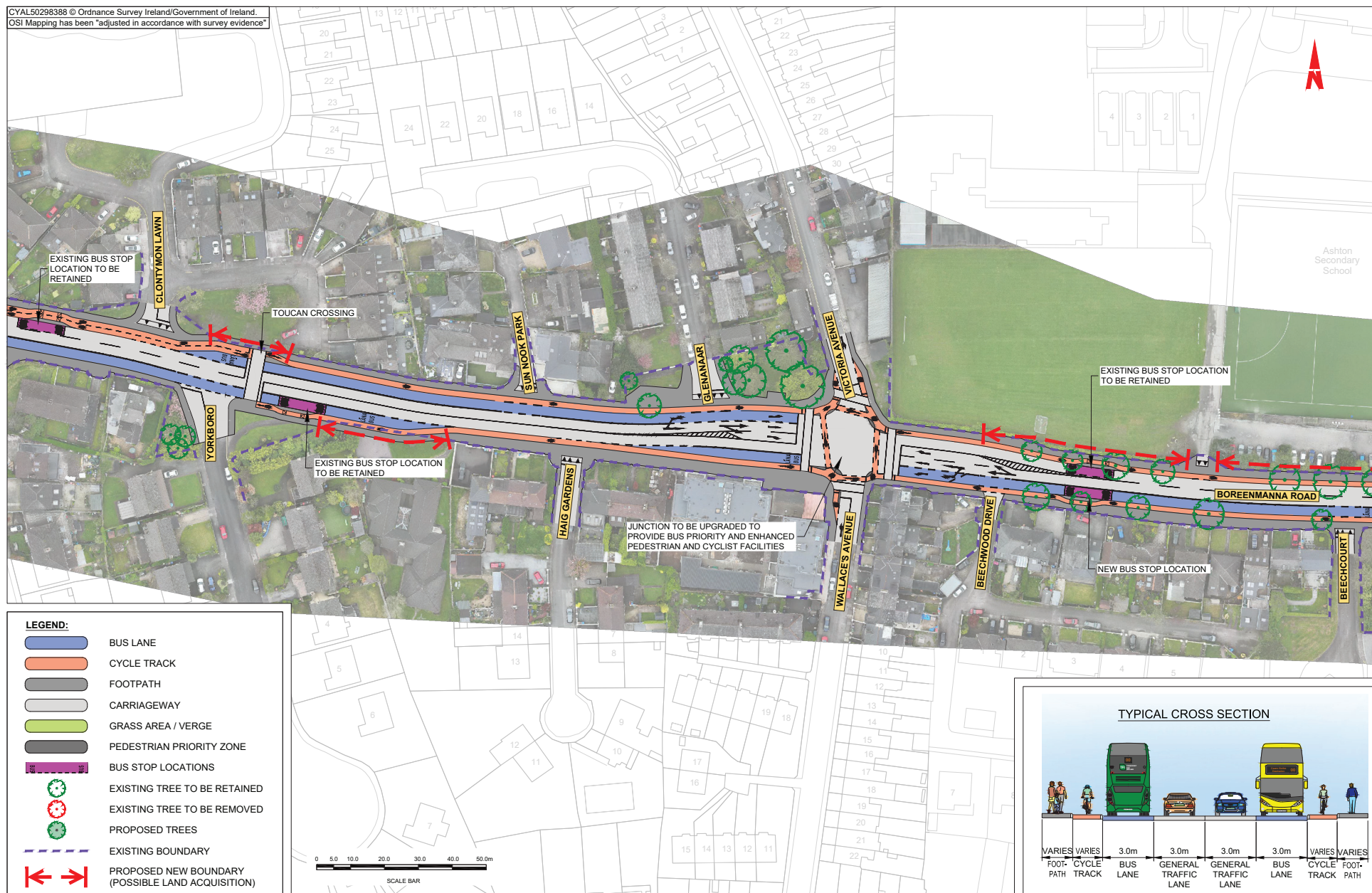

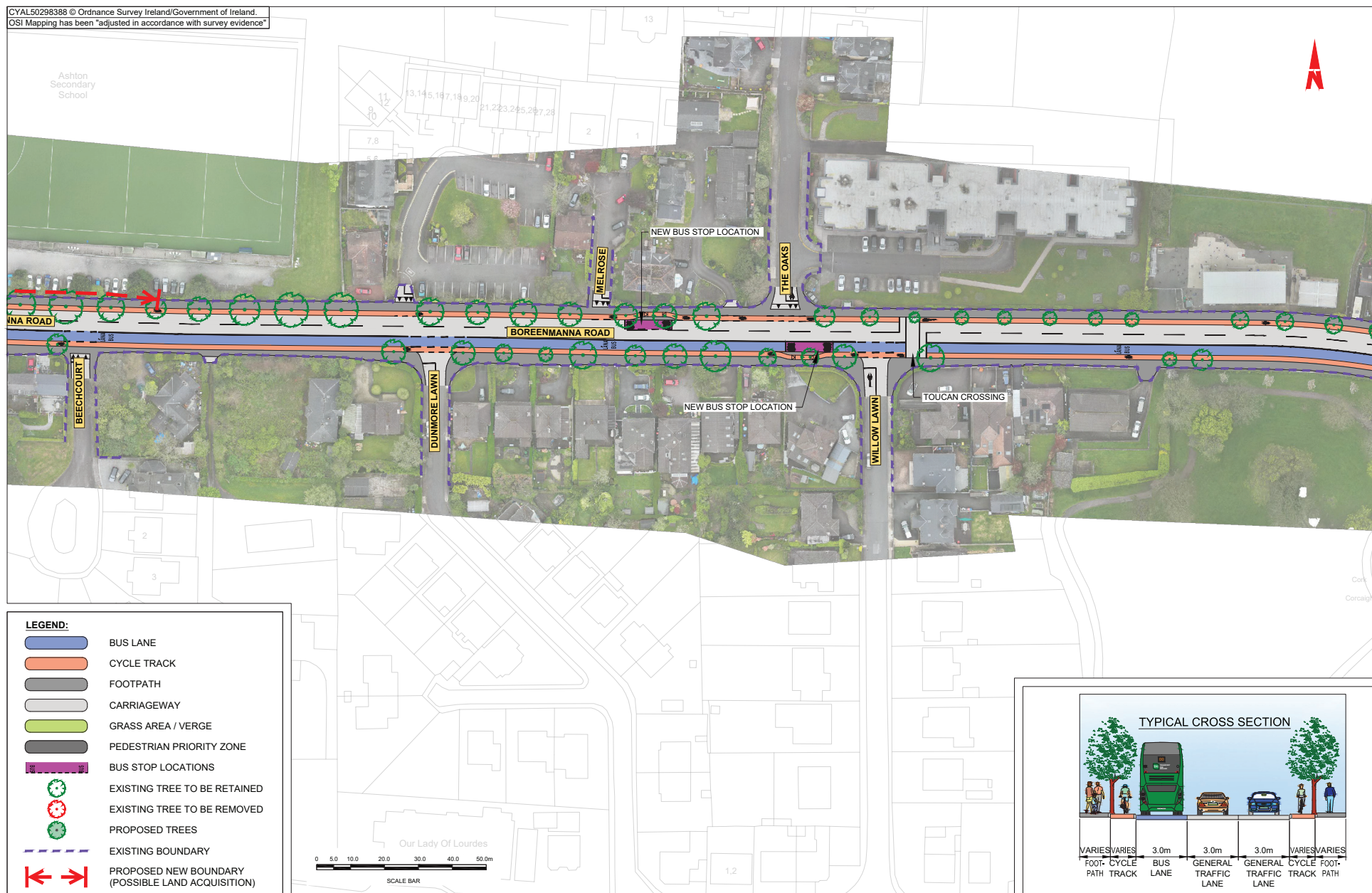

CYAL50298388 © Ordnance Survey Ireland/Government of Ireland.
OSI Mapping has been "adjusted in accordance with survey evidence"

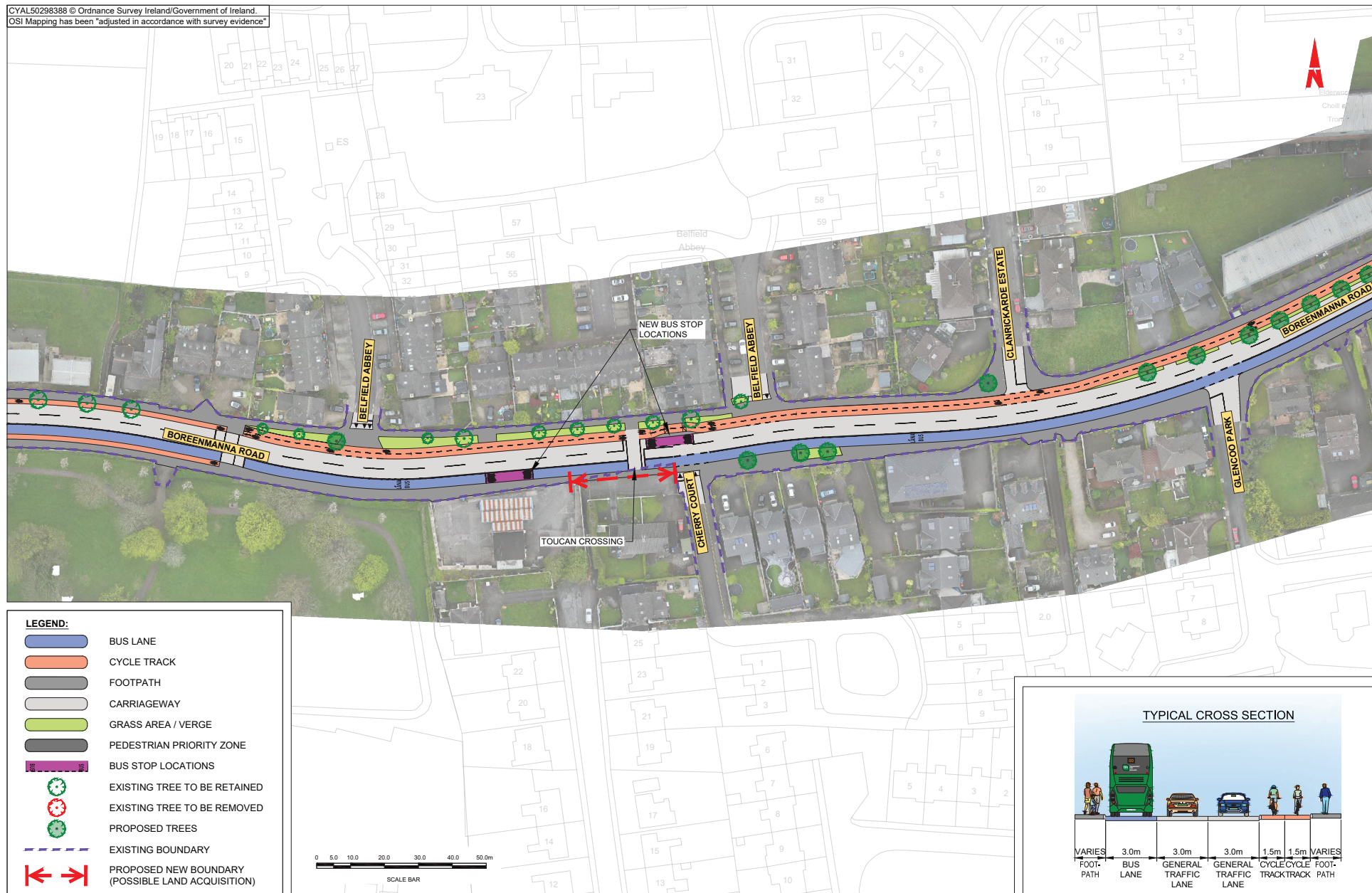

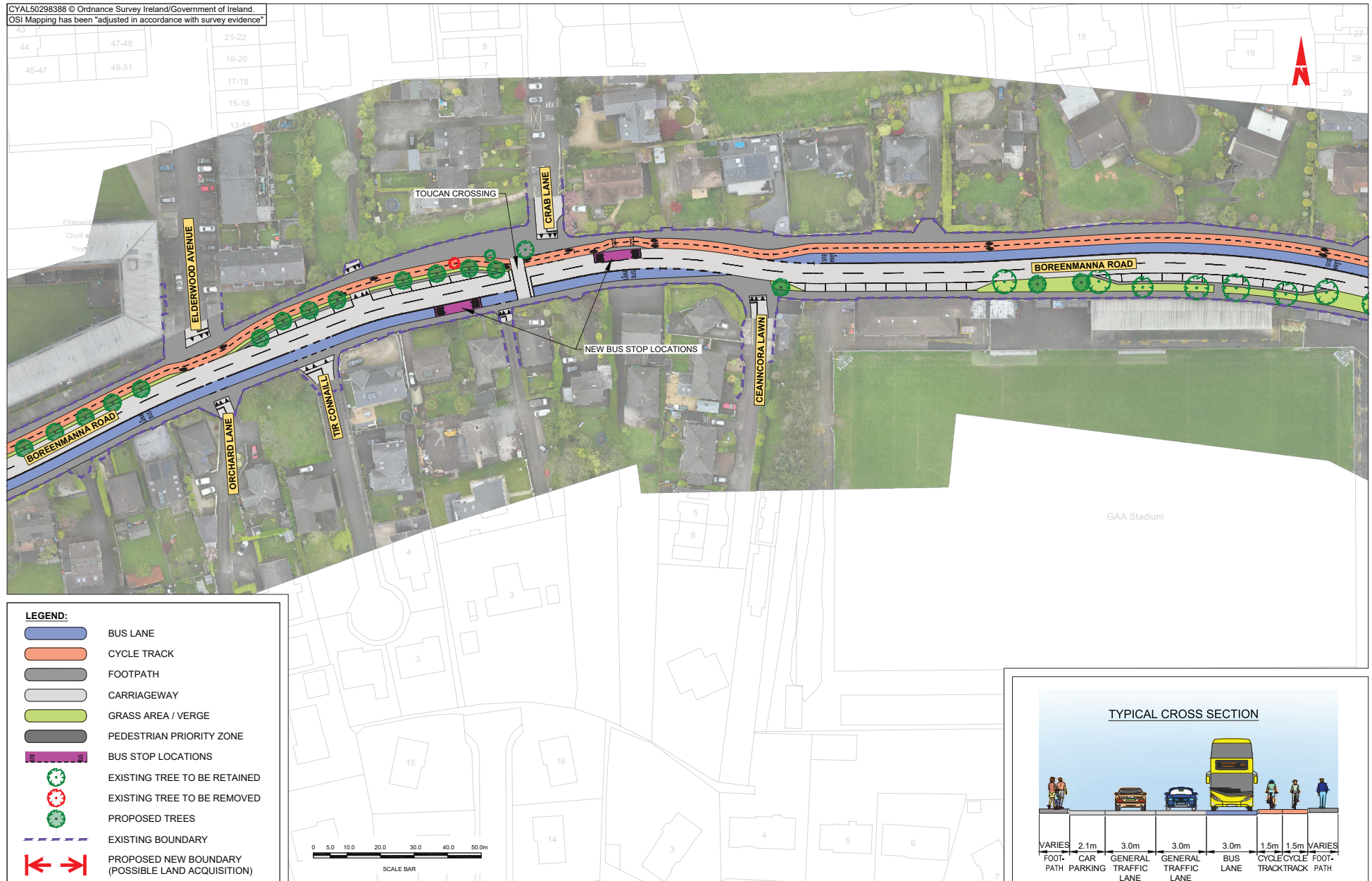

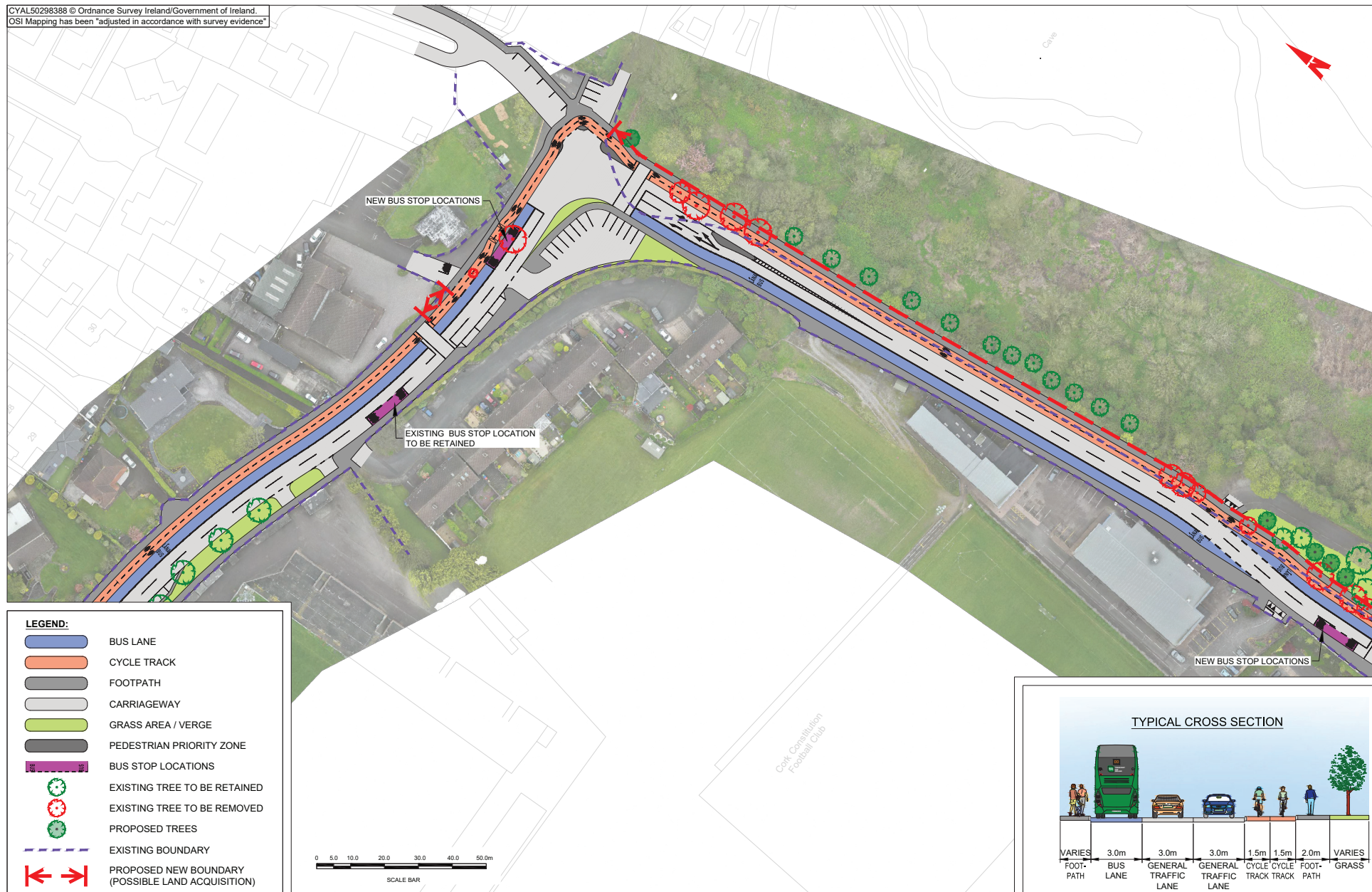

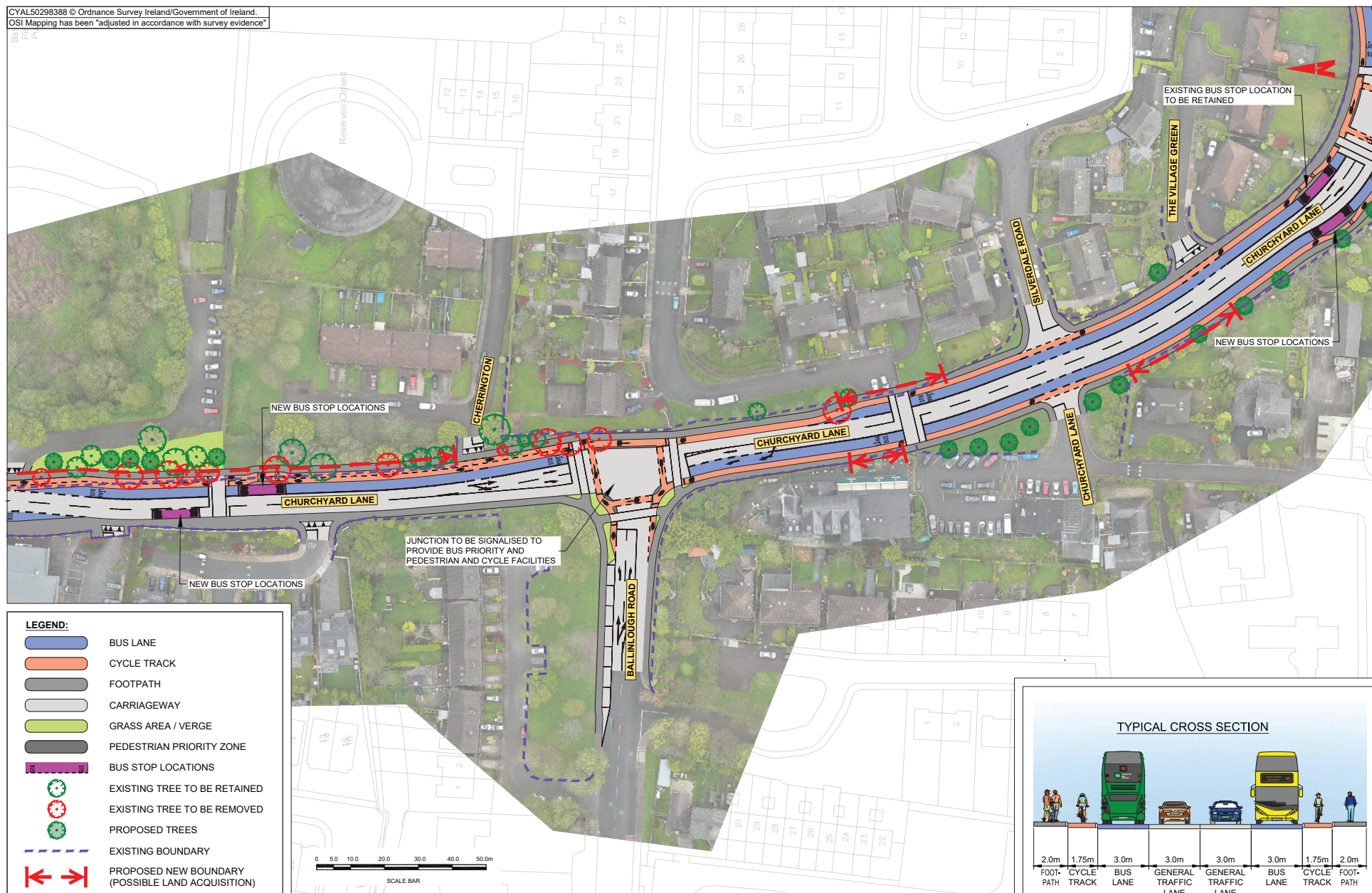

CYAL50298388 © Ordnance Survey Ireland/Government of Ireland.
OSI Mapping has been "adjusted in accordance with survey evidence"

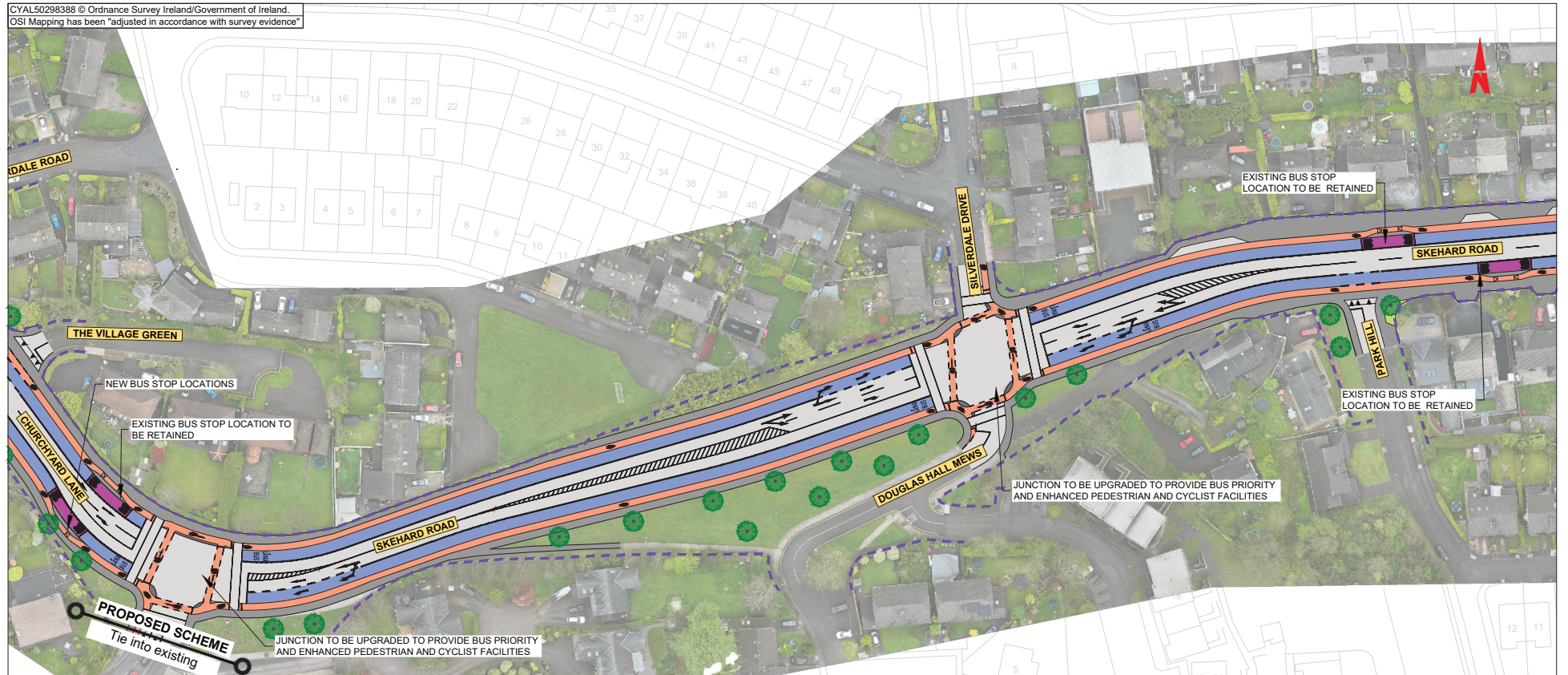

LEGEND:

- BUS LANE
- CYCLE TRACK
- FOOTPATH
- CARRIAGEWAY
- GRASS AREA / VERGE
- PEDESTRIAN PRIORITY ZONE
- BUS STOP LOCATIONS
- EXISTING TREE TO BE RETAINED
- EXISTING TREE TO BE REMOVED
- PROPOSED TREES
- EXISTING BOUNDARY
- PROPOSED NEW BOUNDARY (POSSIBLE LAND ACQUISITION)

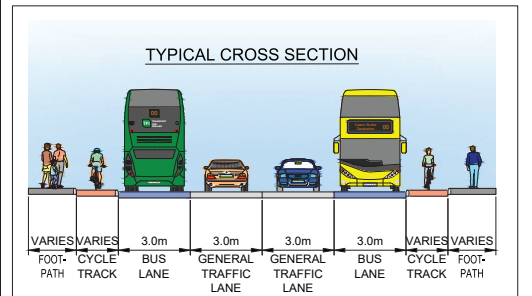
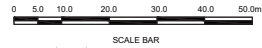

CYAL50298388 © Ordnance Survey Ireland/Government of Ireland.
OSI Mapping has been "adjusted in accordance with survey evidence"

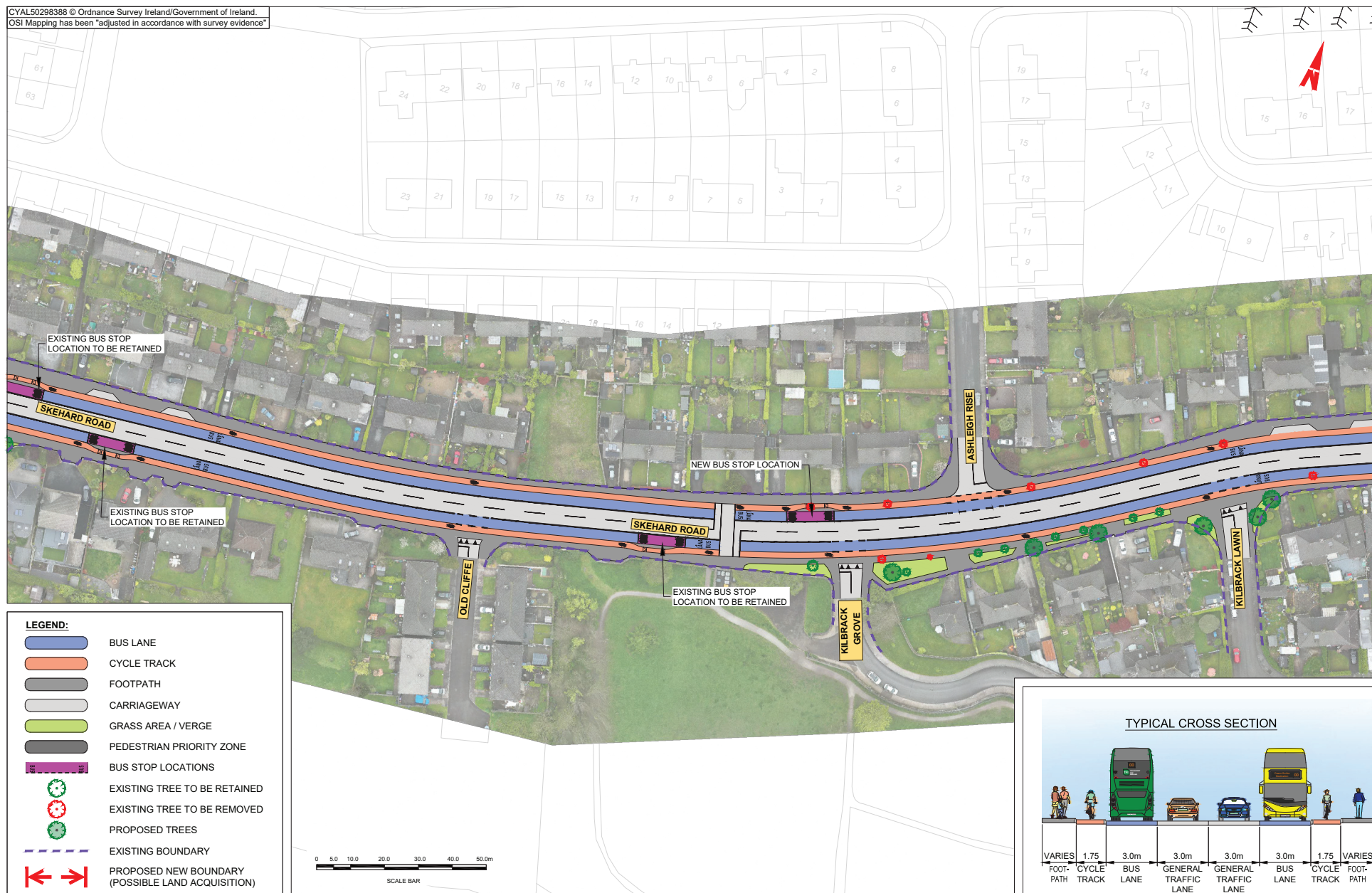

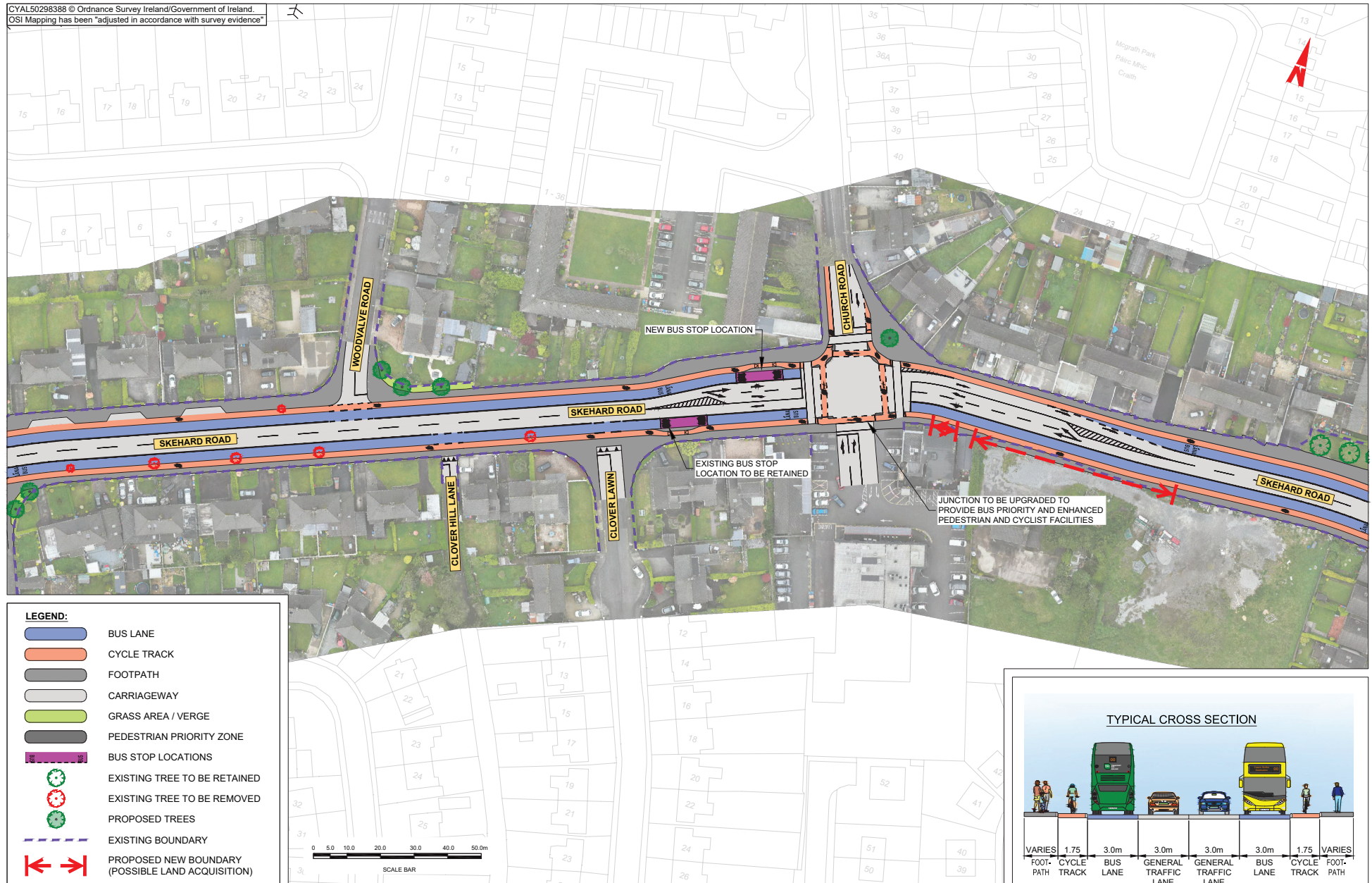

CYAL50298388 © Ordnance Survey Ireland/Government of Ireland.
OSI Mapping has been "adjusted in accordance with survey evidence"

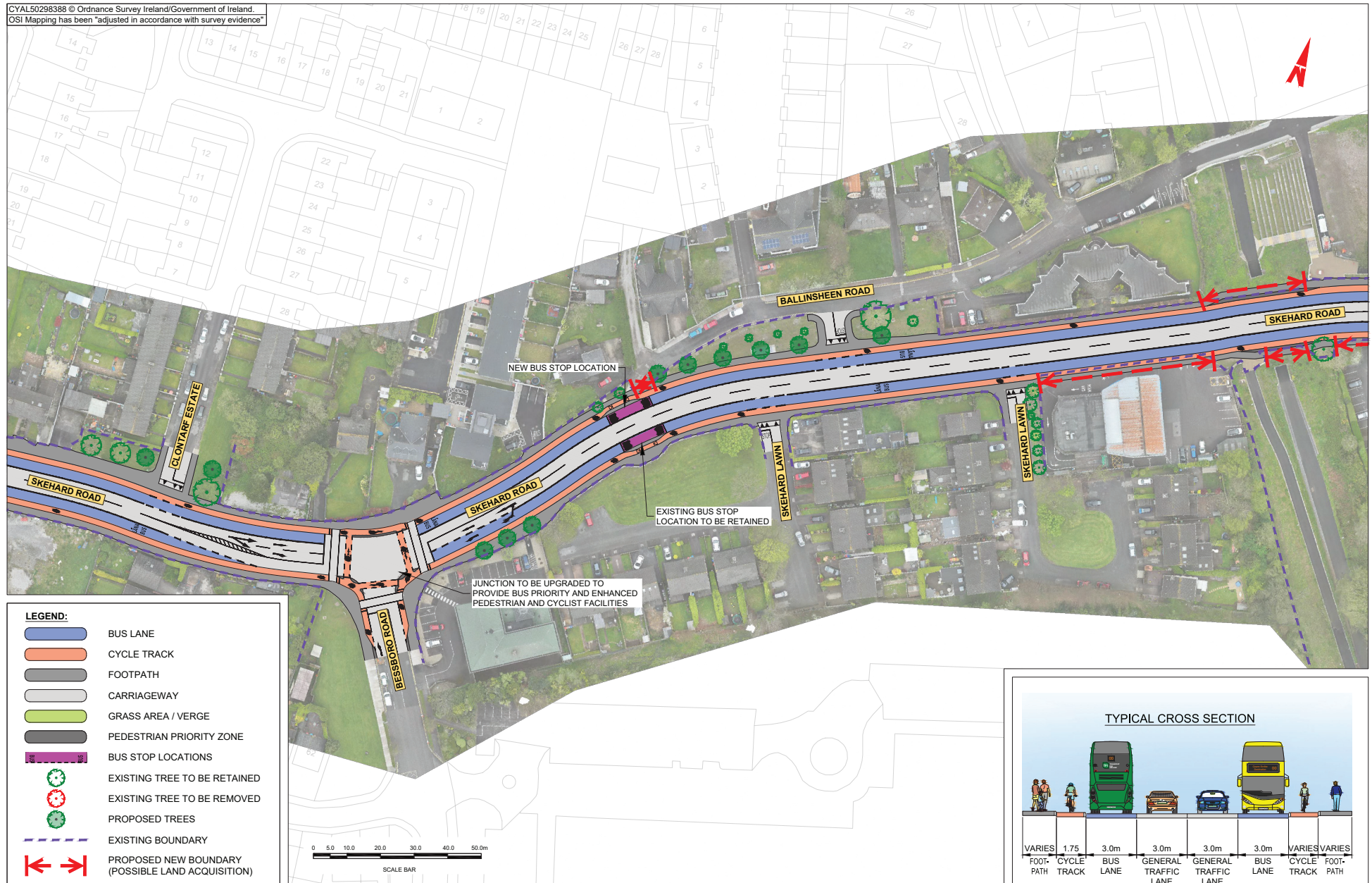

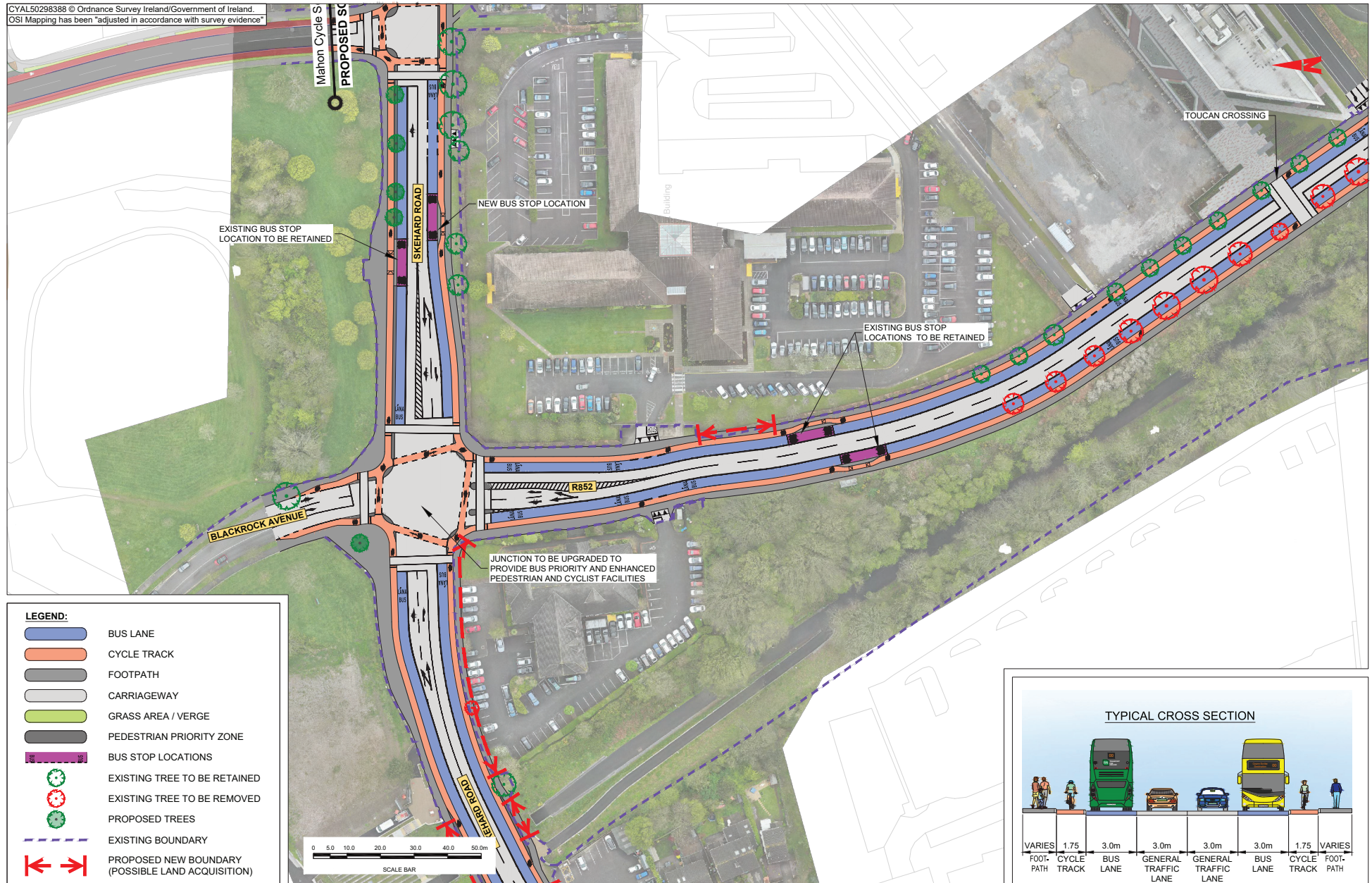

CYAL50298388 © Ordnance Survey Ireland/Government of Ireland.
OSI Mapping has been "adjusted in accordance with survey evidence"

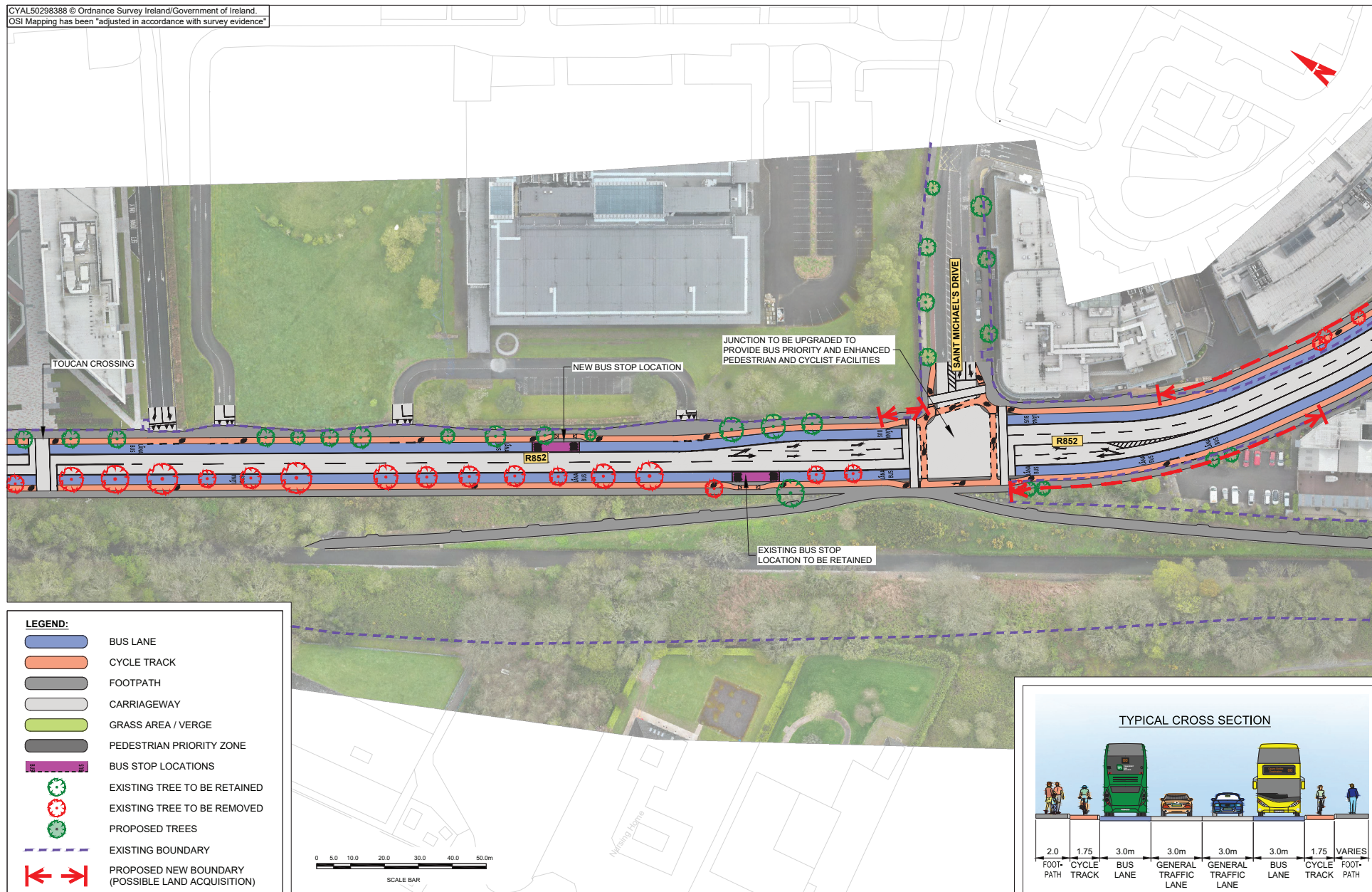

CYAL50298388 © Ordnance Survey Ireland/Government of Ireland.
OSI Mapping has been "adjusted in accordance with survey evidence"

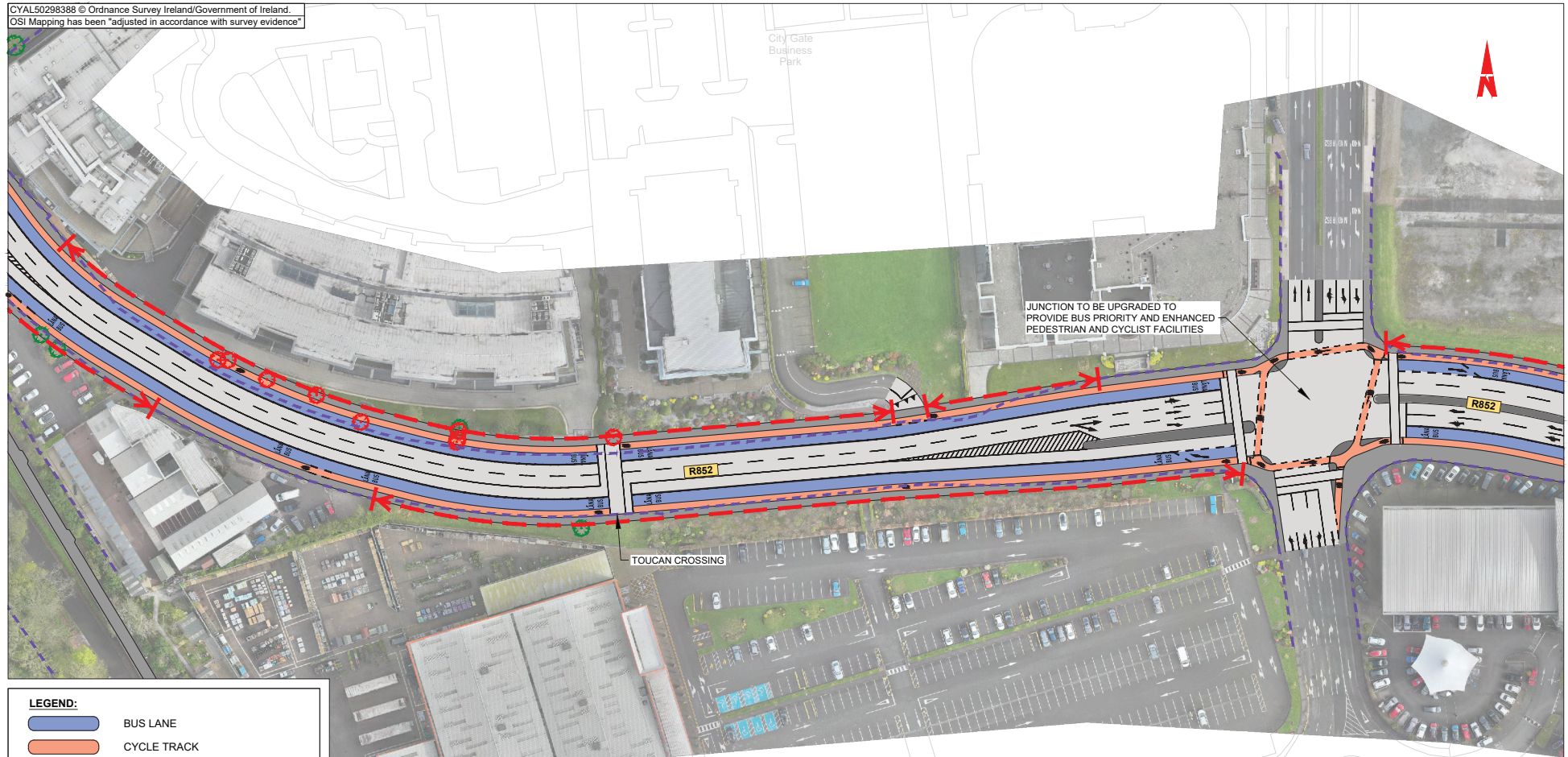

LEGEND:

- BUS LANE
- CYCLE TRACK
- FOOTPATH
- CARRIAGEWAY
- GRASS AREA / VERGE
- PEDESTRIAN PRIORITY ZONE
- BUS STOP LOCATIONS
- EXISTING TREE TO BE RETAINED
- EXISTING TREE TO BE REMOVED
- PROPOSED TREES
- EXISTING BOUNDARY
- PROPOSED NEW BOUNDARY (POSSIBLE LAND ACQUISITION)

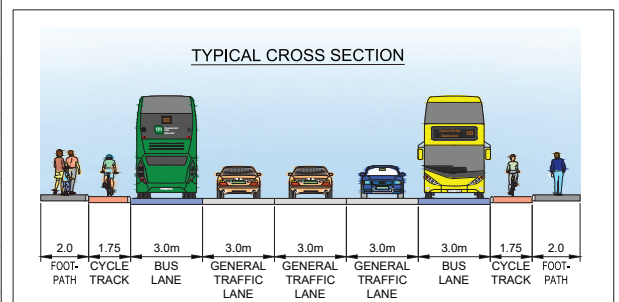

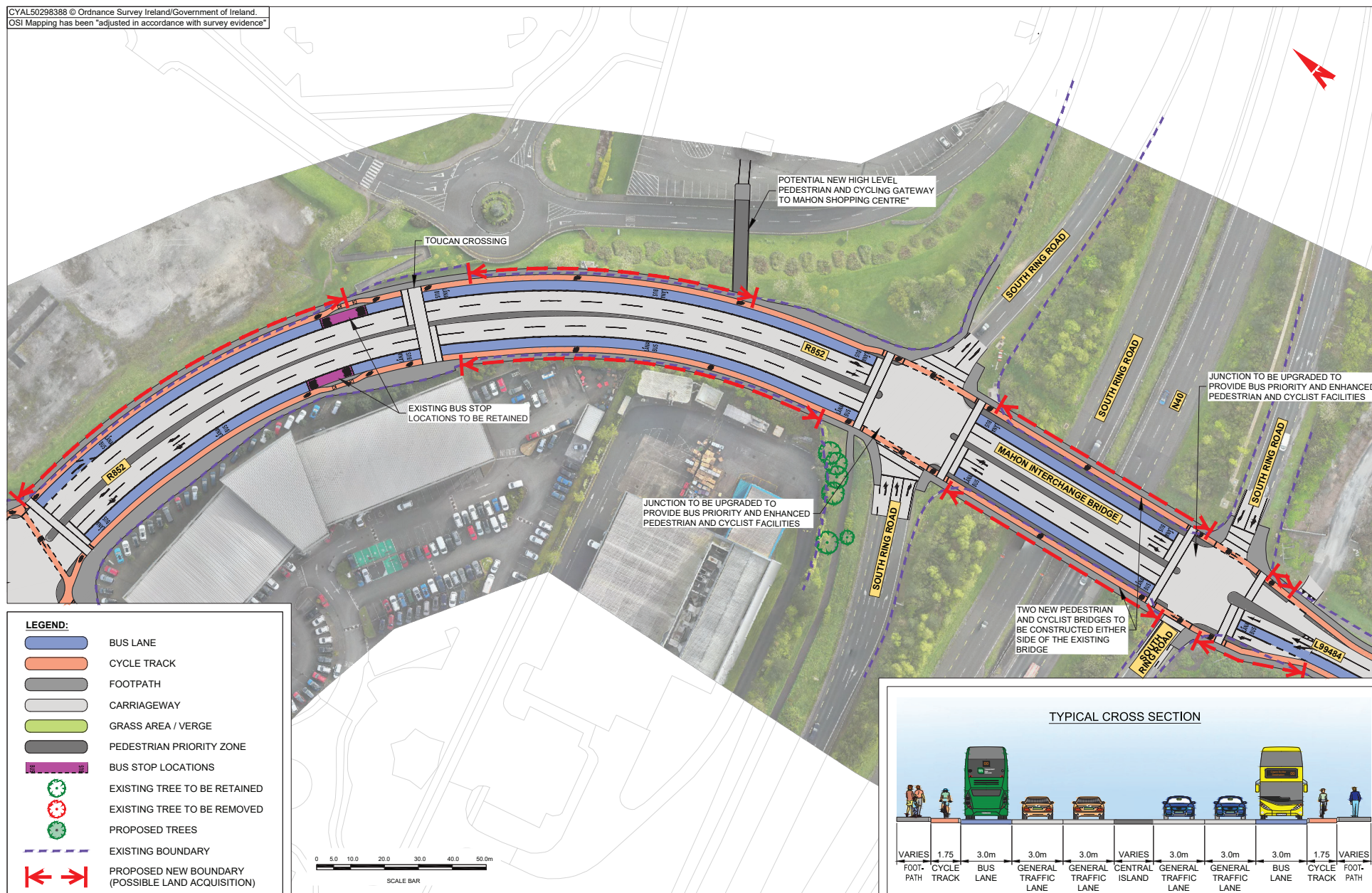

CYAL50298388 © Ordnance Survey Ireland/Government of Ireland.
OSI Mapping has been "adjusted in accordance with survey evidence"

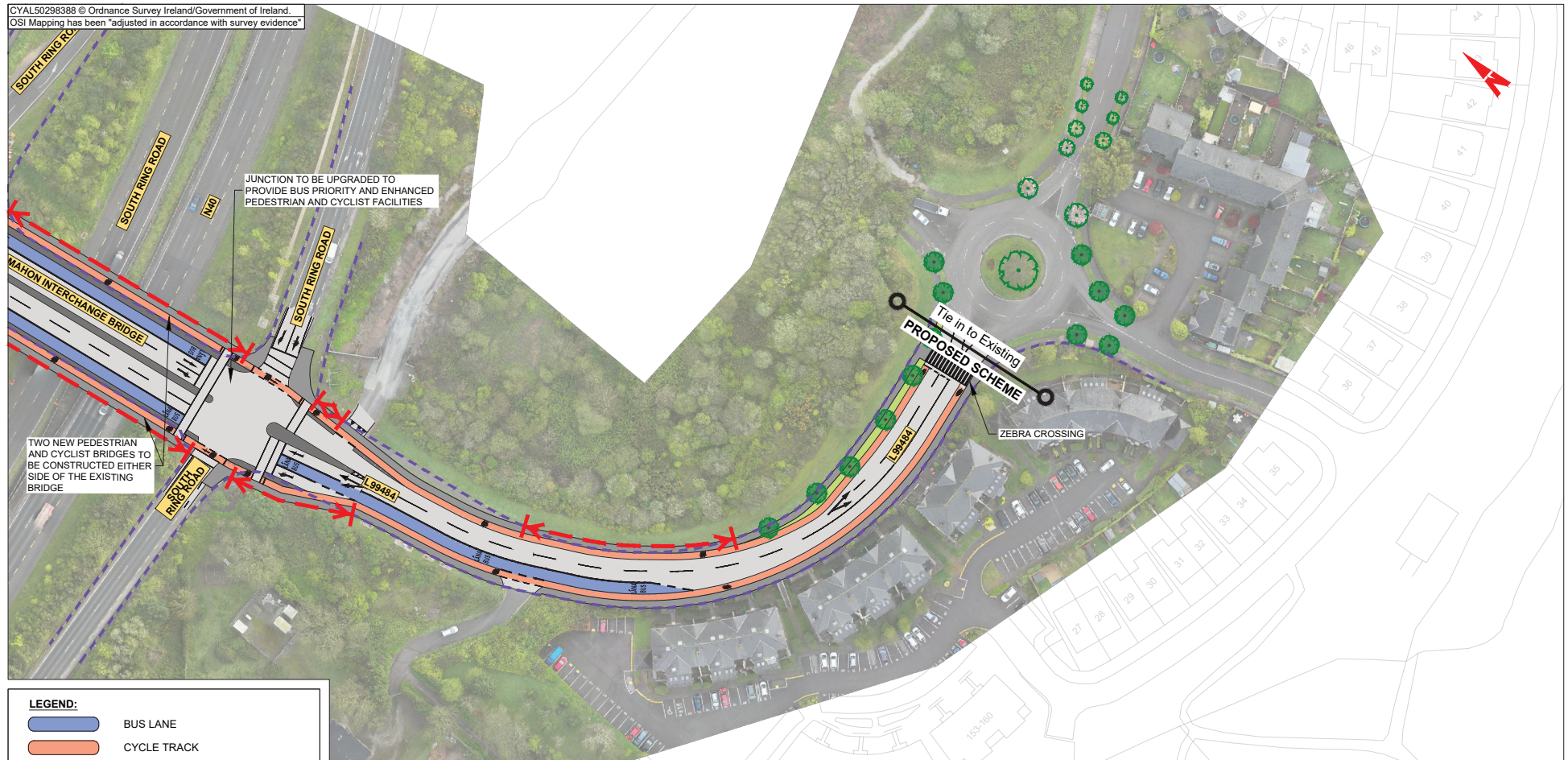

JUNCTION TO BE UPGRADED TO PROVIDE BUS PRIORITY AND ENHANCED PEDESTRIAN AND CYCLIST FACILITIES

TWO NEW PEDESTRIAN AND CYCLIST BRIDGES TO BE CONSTRUCTED EITHER SIDE OF THE EXISTING BRIDGE

Tie in to Existing
PROPOSED SCHEME

ZEBRA CROSSING

LEGEND:

- BUS LANE
- CYCLE TRACK
- FOOTPATH
- CARRIAGEWAY
- GRASS AREA / VERGE
- PEDESTRIAN PRIORITY ZONE
- BUS STOP LOCATIONS
- EXISTING TREE TO BE RETAINED
- EXISTING TREE TO BE REMOVED
- PROPOSED TREES
- EXISTING BOUNDARY
- PROPOSED NEW BOUNDARY (POSSIBLE LAND ACQUISITION)

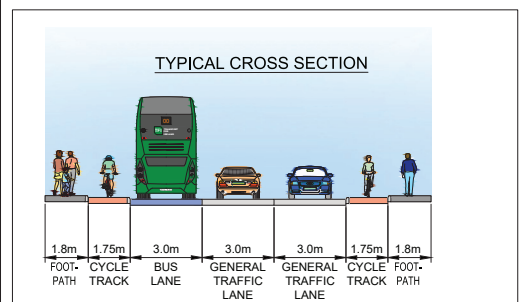
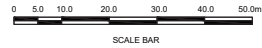

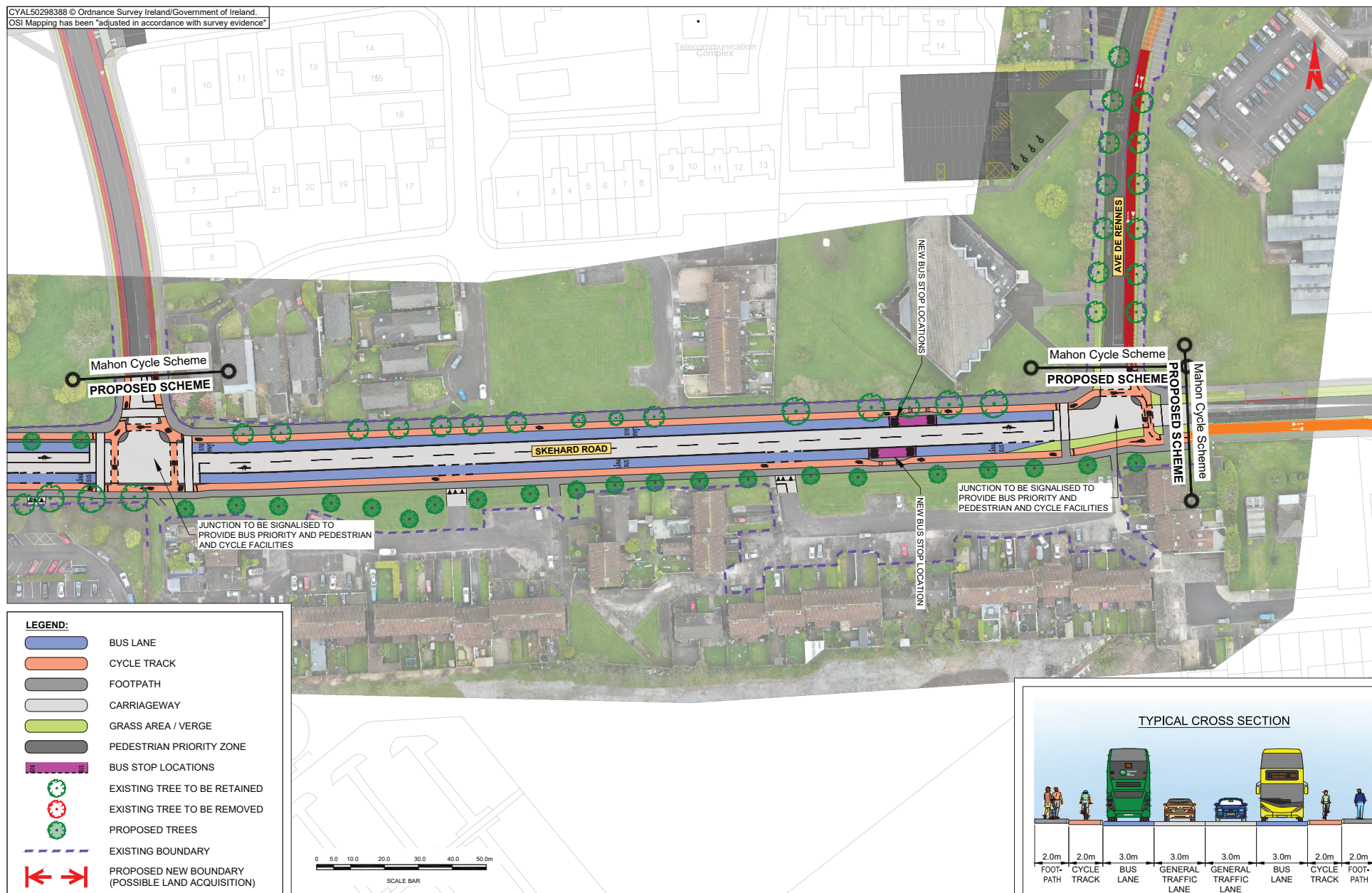



CYAL50298388 © Ordnance Survey Ireland/Government of Ireland.
OSI Mapping has been "adjusted in accordance with survey evidence"



CYAL50298388 © Ordnance Survey Ireland/Government of Ireland.
OSI Mapping has been "adjusted in accordance with survey evidence"



CYAL50298388 © Ordnance Survey Ireland/Government of Ireland.
OSI Mapping has been "adjusted in accordance with survey evidence"

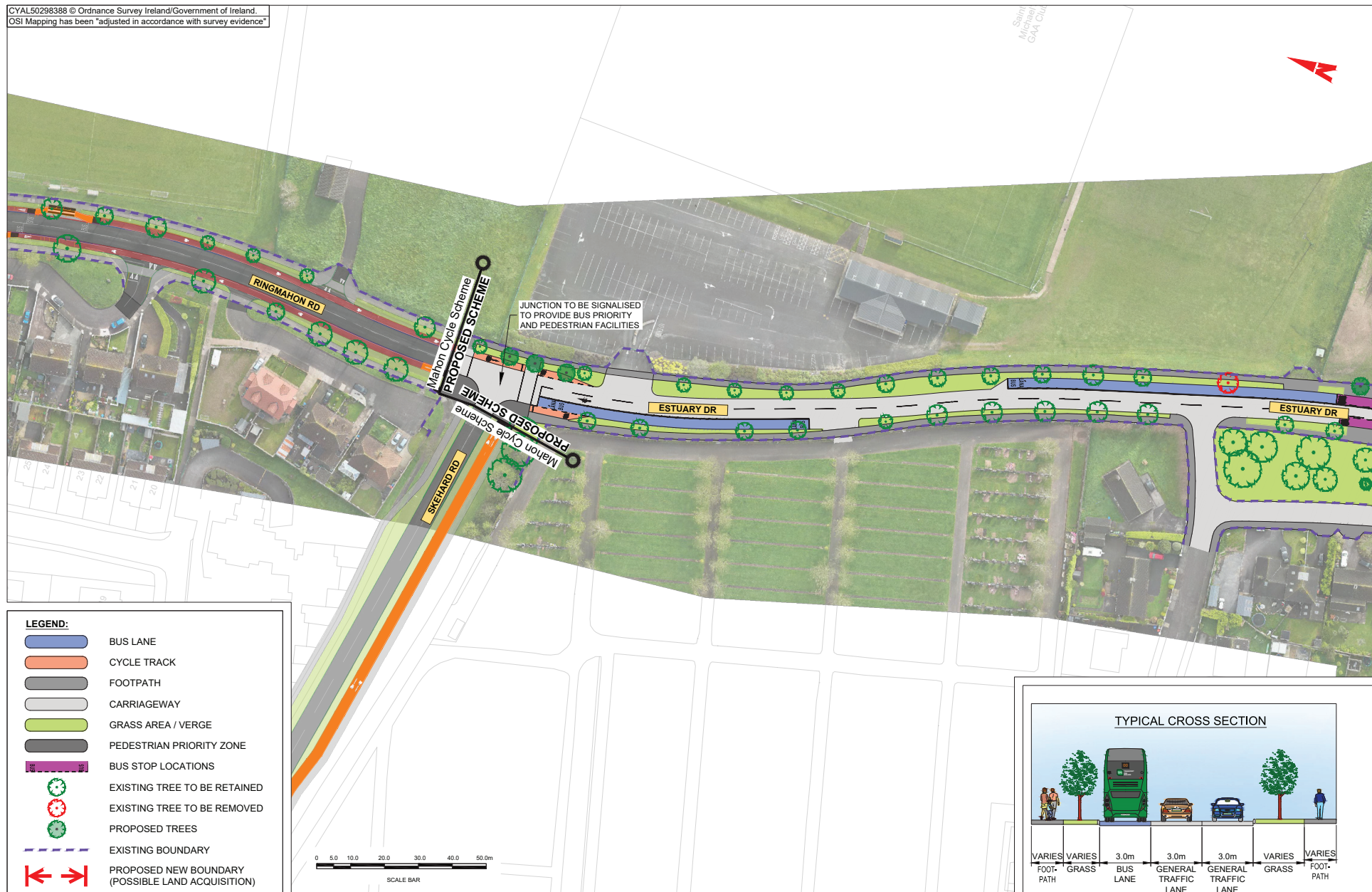

CYAL50298388 © Ordnance Survey Ireland/Government of Ireland.
OSI Mapping has been "adjusted in accordance with survey evidence"





Údarás Náisiúnta Iompair
National Transport Authority

National Transport Authority
Harcourt Lane,
Dun Sceine,
Dublin 2,
D02 WT20.

NTA - Cork Office
Suite 427
1 Horgan's Quay, Waterfront Square,
Cork
T23 PPT8



Rialtas
na hÉireann
Government
of Ireland

Tionscadal Éireat
Project Ireland
2040